

KEY NOTES

- 101 NEW 2440MM TIMBER STUD PARTITIONS FINISHED IN PAINTED PLASTERBOARD.
- 102 NEW WALL MOUNTED MIRROR.
- 103 NEW FULL HEIGHT METAL DISPLAY FIXTURES SECURED TO WALL COMPLETE WITH WHITE OAK SHROUDS.
- 104 NEW FREESTANDING METAL STOCKROOM RACKING.
- 105 NEW MOVEABLE METAL STOCKROOM RACKING ON FLOOR MOUNTED GUIDES.
- 106 NEW ENGINEERED WHITE OAK TIMBER FLOORING.
- 107 NEW FLOOR MOUNTED TIMBER CASH DESK AND BACK WRAP.
- 108 NEW FIRE RATED TIMBER DOOR WITH PAINTED BEADBOARD CLADDING TO SALES AREA SIDE.
- 109 ALL WALLS TO BE DECORATED FARROW & BALL 'PINK GROUND' No.202. ALL CEILINGS TO BE DECORATED RAL 9016 WHITE.
- 110 NEW STEEL HANDROD FIXTURES SECURED TO WALL.
- 111 NEW POWER OUTLET ELECTRICAL CABLE TO BE CHASED INTO WALL AND MADE GOOD.
- 112 NEW PLASTERBOARD BOXING TO SHOP FRONT IN LINE WITH ADJACENT COLUMN.
- 113 NEW CEILING MOUNTED HANGBAR.

Figured dimensions shall be taken in preference to scaled dimensions and any discrepancies or errors are to be referred to the Designer. Contractors, sub-contractors and suppliers must verify all dimensions on site before commencing work or making any fabrication drawings. © Copyright Reserved



For Office Use: A_12494

free people

27 HAMPSTEAD HIGH STREET
 LONDON
 NW3 1QA

CONSULTANT :
free people

DRAWN BY:
 LN

ISSUE / DATE:
 PLANNING 21.10.2021

REVISION :
 A: PLANS AMENDED 24.11.2021

SHEET TITLE :
**PROPOSED BASEMENT
 AND GROUND FLOOR
 PLAN**

SHEET NO. :

PL001

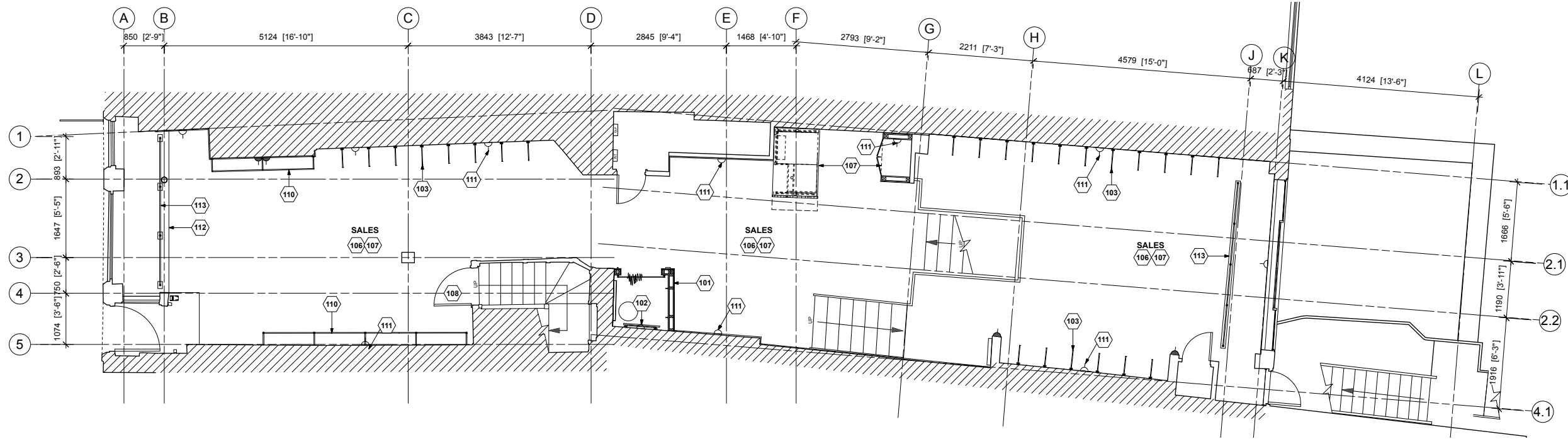

2 GROUND FLOOR PLAN

PL001 SCALE: @A1 1:50

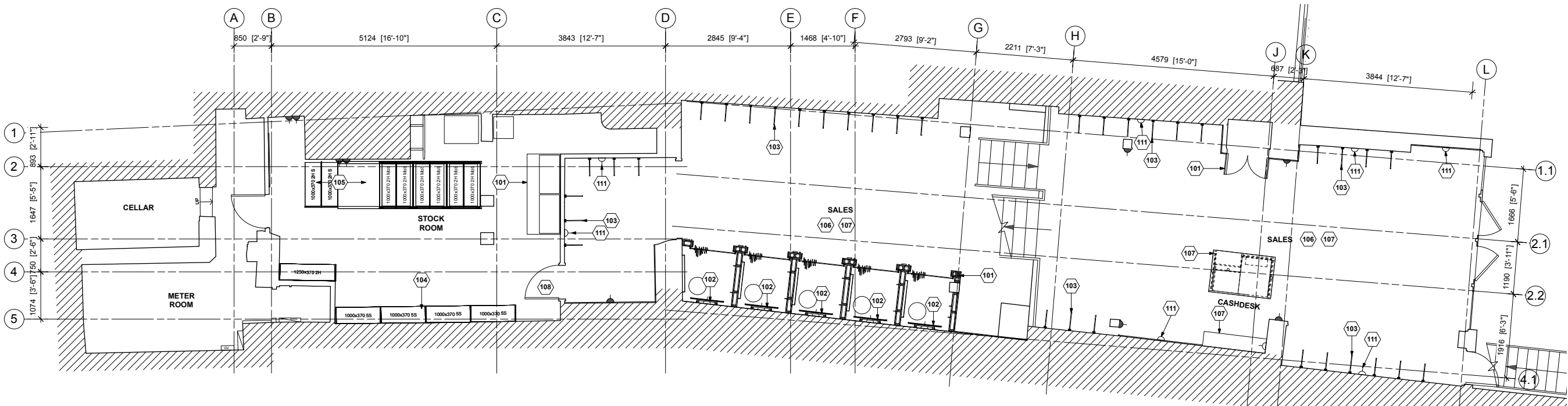

1 BASEMENT FLOOR PLAN

PL001 SCALE: @A1 1:50