

0123456metres

scales 1:50 @ A1
1:100 @ A3

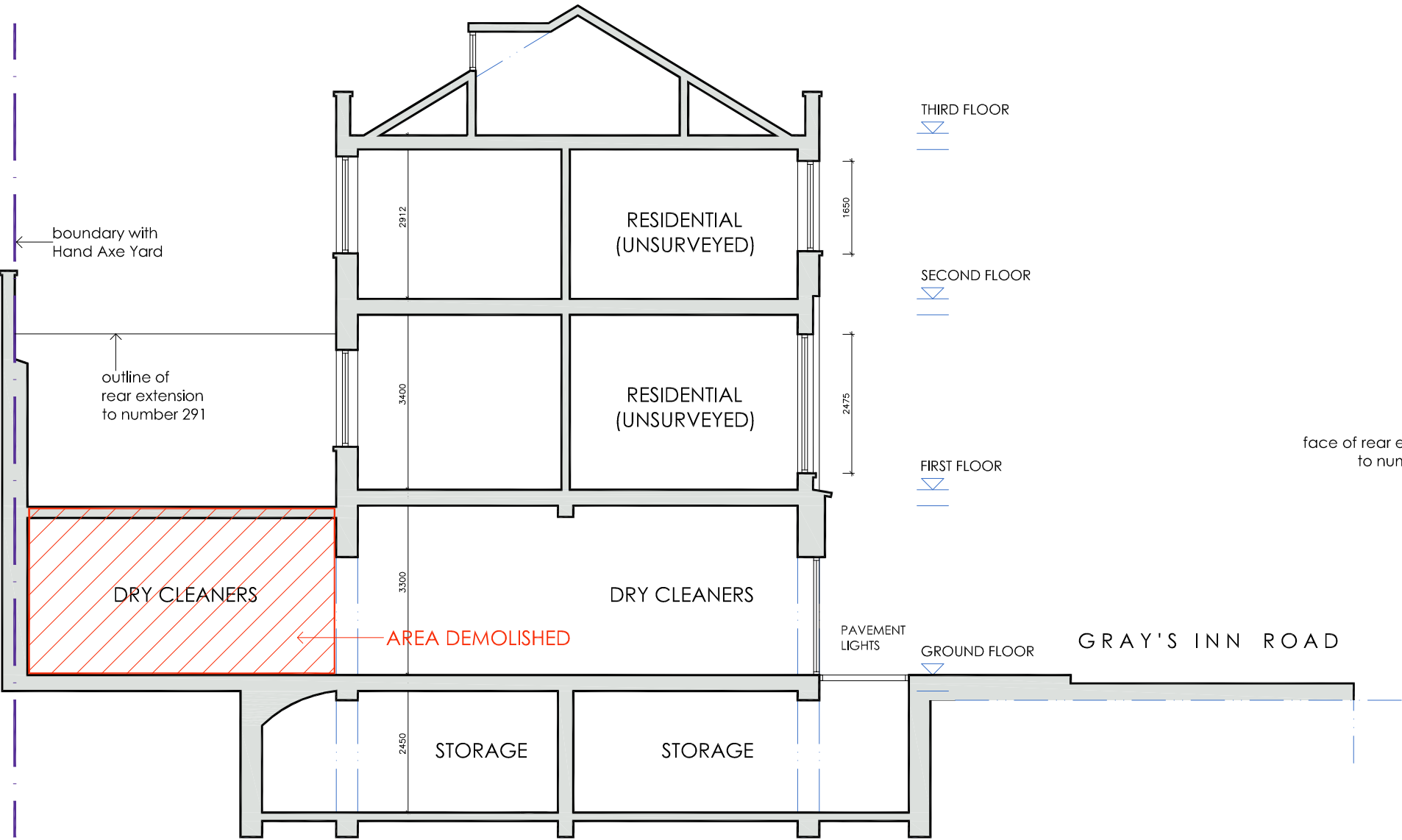

Section BB

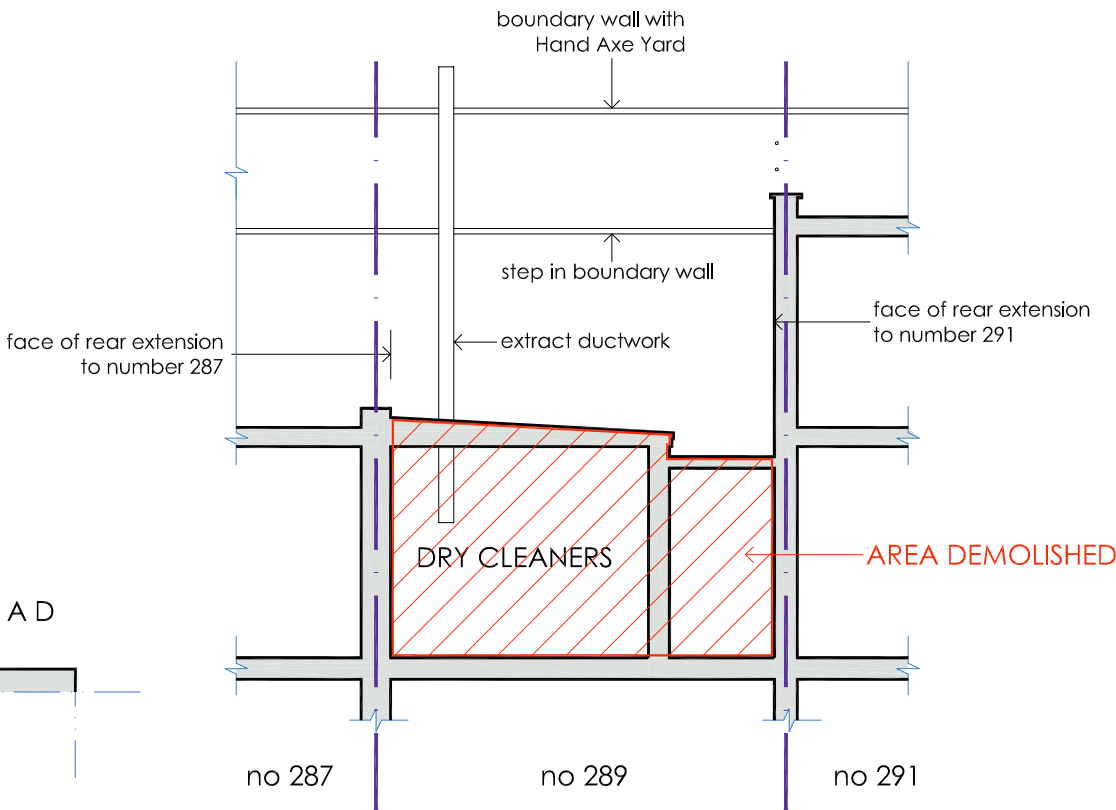

Section CC

sections BB and CC as existing

DVM

ARCHITECTS

4a Murray Street . London . NW1 9RE
Telephone 0207 485 2121 . Facsimile 0207 267 2527
e-mail: studio@dvmarch.com

Client

NFKA Enterprise Ltd

Project

289 Gray's Inn Road
London WC1X 8QH

Title

Sections BB + CC
as EXISTING

Scale	Date	Job No.
1:50	29.11.21	1165
Drawing No.	Rev.	
1165-05		

All dimensions are to be checked on site.
© This drawing is copyright and remains the property of David & Victoria Mercer
at all times and may not be reproduced in part or whole without written consent.