

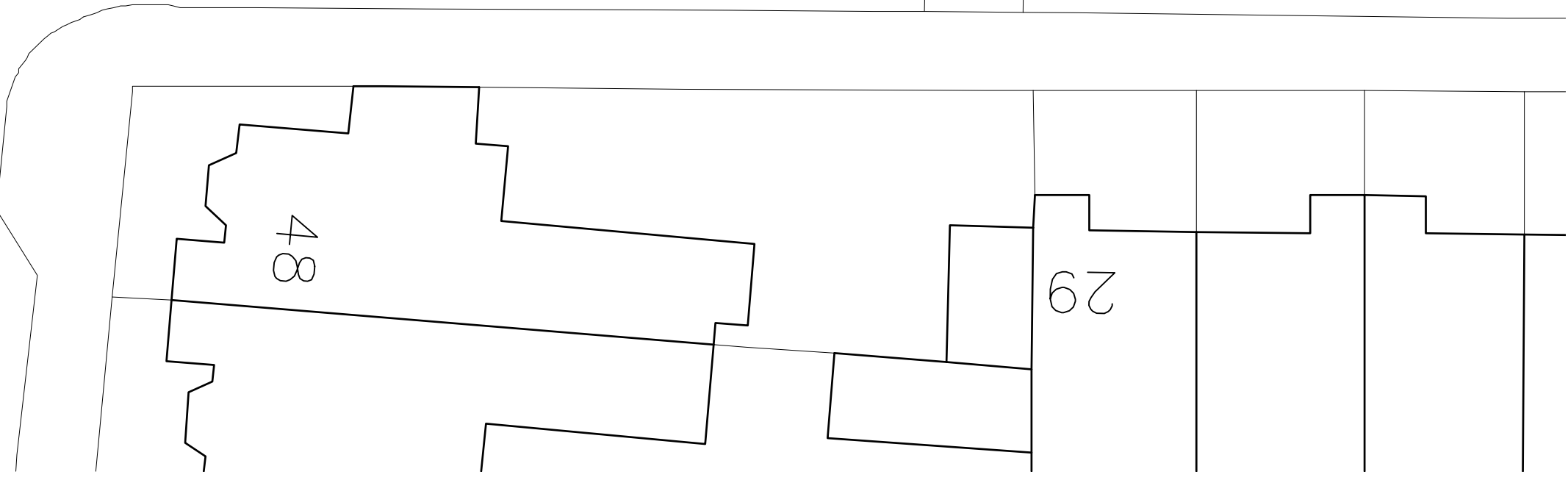

OSPRINGE ROAD



 Hatch indicates new additions
 Site Boundary

A 21.11.24 Permitted Development Application
 -- 21.11.11 first issue

TKB MR
 TKB MR
 drawn by . checked by .



scale bar - do not scale from this drawing - scale bar is included as a requirement of statutory approvals only
 note to contractor_use only figured dimensions for construction

<p>1.1250_A3</p> 	<p>District.</p> <p>Studio 4 . Blackwater Court . 17-19 Blackwater Street . London . SE22 8SD 020 7871 3101 studio@districtarchitects.co.uk www.districtarchitects.co.uk this drawing is copyright .</p>	<p>Planning</p> <p>project 50 Lady Margaret Road Kentish Town . London . NW5 2NP</p> <p>client Mr. and Mrs. Haugen</p>	<p>job no. 033. (3) stage .0 type / place .005 series / number _A revision</p>
---	---	---	--