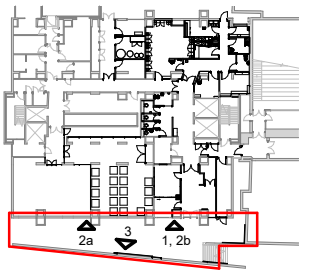

**Key Plan****1 Entrance Elevation - Existing\_**  
1 : 20

0m 1m 2m 3m 4m 5m

Existing Curtain walling  
to be removed

bike hoops relocated (as  
proposal elevation below)

Plinth and sill to be removed

existing bike hoops relocated

Existing Curtain  
Walling retained

Existing Canopy retained

full height manifestation to  
glazing to provide data  
security and privacy to back  
of reception desk

New Curtain walling, framing be  
anodised aluminium (silver)  
to match existing

Existing Entrance  
door retained

New Escape Door, framing be  
anodised aluminium (silver)  
to match existing

concrete ramp to provide level  
escape

**2a Entrance Elevation - Proposed (part 1)**  
1 : 20**2b Entrance Elevation - Proposed (part 2)**  
1 : 20

0m 1m 2m 3m 4m 5m

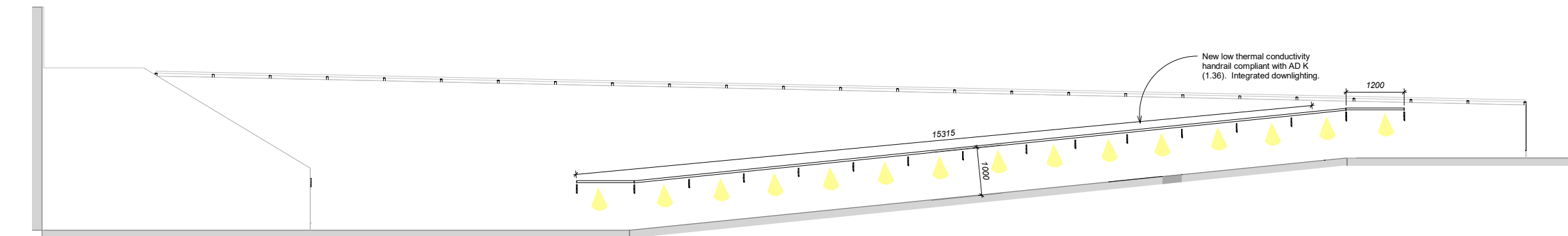
**3 Front entrance - New Handrail Location**  
1 : 50

0m 1m 2m 3m 4m 5m

**WILSON MASON**

Wilson Mason LLP - Chartered Architects  
8, New Concordia Wharf, Mill Street, London SE1 2BB  
T 020 7637 1501 - www.wilsonmason.co.uk

|                    |                                   |
|--------------------|-----------------------------------|
| client             | project                           |
| UCL                | Ground Floor Refurbishments       |
| drawing            | Entrance Modifications - Planning |
| As indicated at a1 |                                   |
| Tender Issue       | 6773- A(2)-J22 P01                |