

Figured dimensions only are to be used.
All dimensions to be checked on site.
Differences between drawings and between
drawings and specification to be reported to
FORM Design Group Ltd.
© the copyright of the drawing and designs
contained therein remains vested in
FORM Design Group Ltd..
Hersham Place Technology Park,
Walton on Thames, Surrey. KT12 4RZ

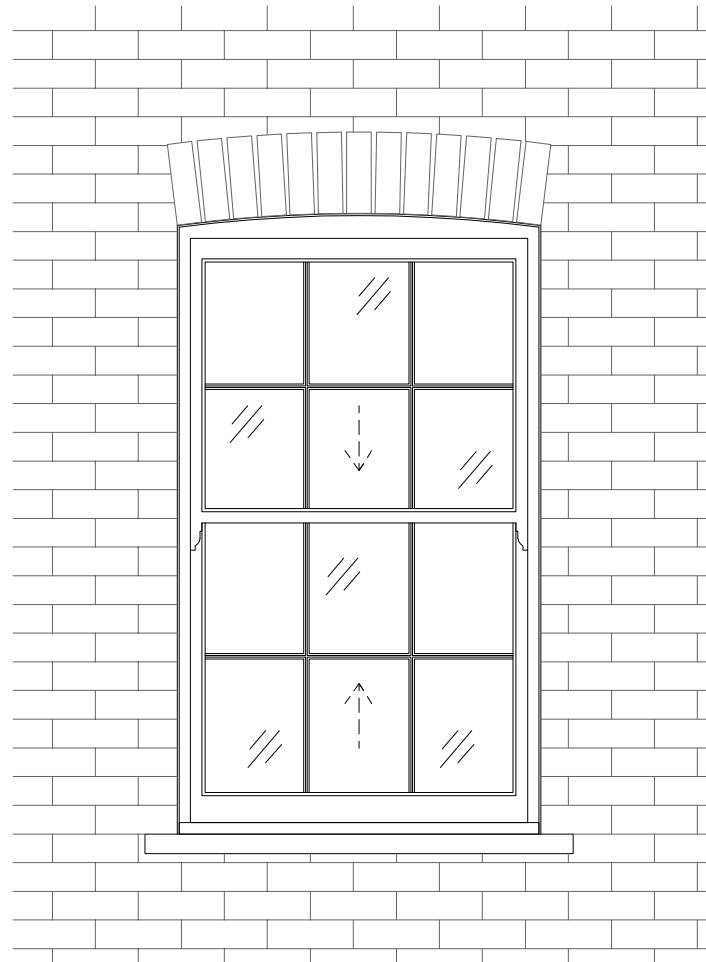

OUTSIDE VIEW

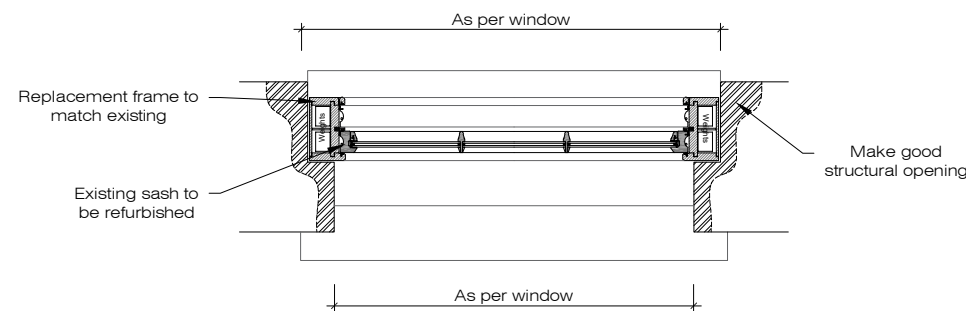
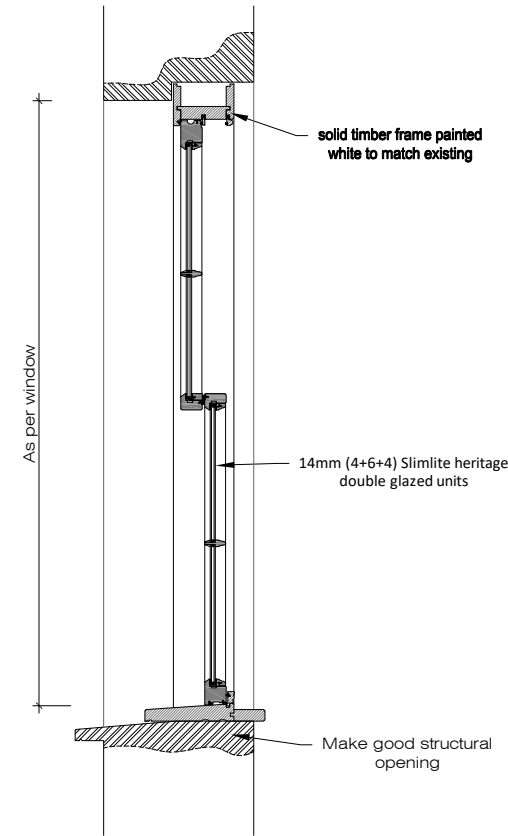

CONSERVATION BOX SASH WINDOW
FLUSH REVEAL WITHIN STRUCTURE

- W1-01 W2-01 Opening Approximately 950 x 1635mm
W1-02 Opening Approximately 1090 x 1910mm

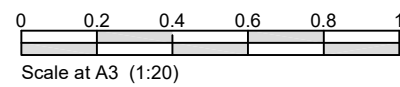

TYPICAL REPLACEMENT WINDOW



Hersham Place Technology Park,
Walton on Thames, Surrey. KT12 4RZ
T: 01932 798132
E: info@formdesigngroup.co.uk

Architecture
Planning
Structures
Landscape
Interiors

CLIENT

Leigh Street Management Ltd

12 Leigh Street, London, WC1H 9EW

SCALE (@ A3)

1 : 20

PROJECT NUMBER

1911

DRAWING NUMBER

PL-24-001

REVISION