

revision / date / amendments
- / - / - / -

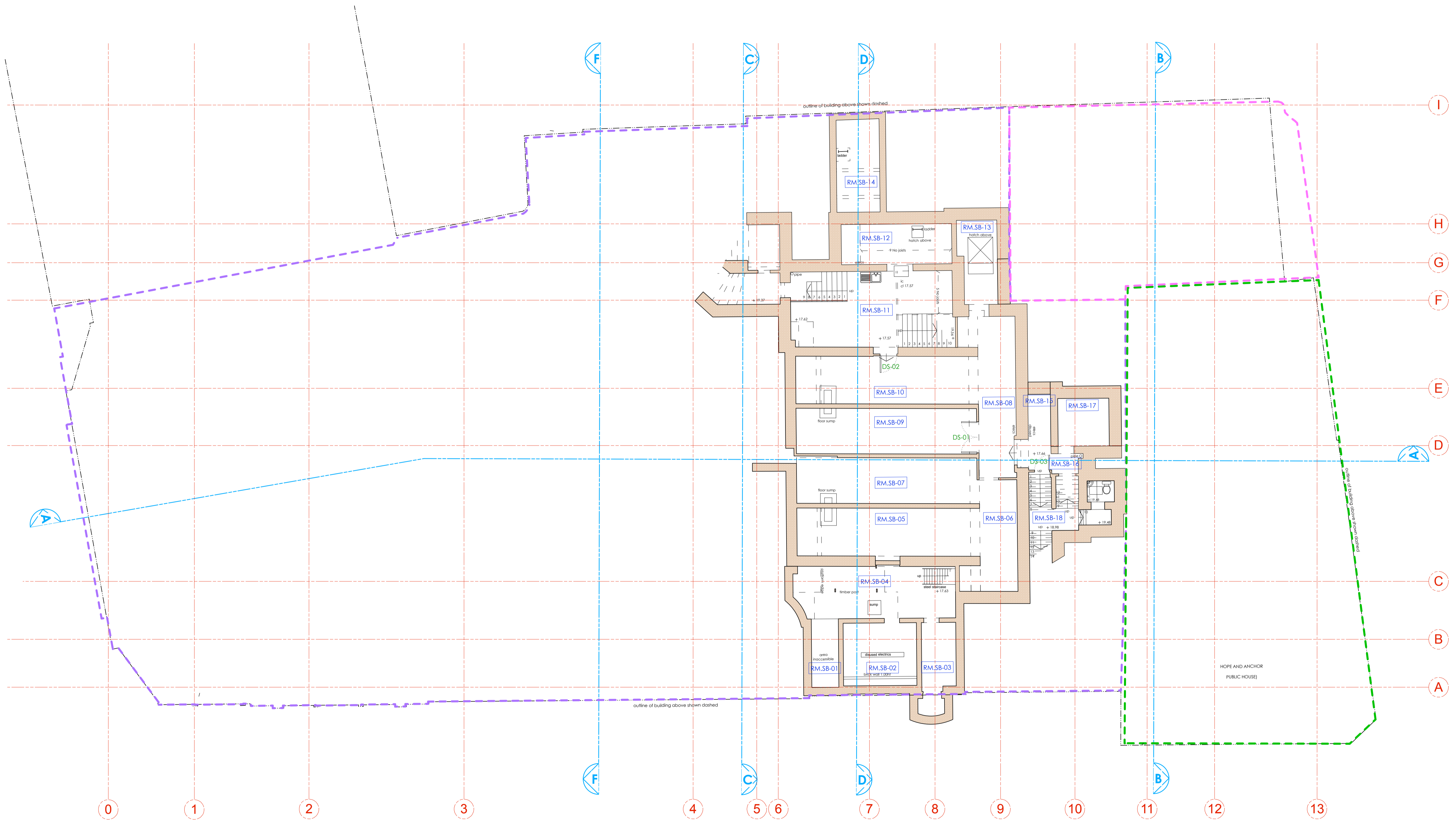

**LEGEND**

- Existing Building Fabric KOKO née Camden Palace Theatre (1900)
- Existing Building Fabric Hope & Anchor (approx. 1850)
- Existing Building Fabric Bayham Place (from 1875)
- Existing Modern Building Fabric Bayham Place (from 2006)

RM.4-06 Room Number

D4-02 Door Number

W4-05 Window Number

--- Hope & Anchor Demise

--- Koko Demise

--- 1 Bayham Street & 65 Bayham Place Demise

05.12.17

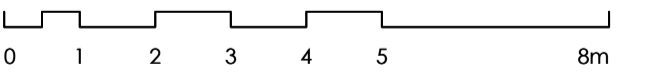

**STAGE 4**

Archer Humphryes Architects

Basement  
Central House  
142 Central Street  
London, United Kingdom  
EC1V 8AR  
T: +44 (0) 20 7251 8555

project title	
KOKO + Hope & Anchor + Bayham Place Camden, London	
drawing title	scale date
Existing Lower Basement Floor Plan	1:100 BA1 28.11.17
drawing number	drawn checked
AHA/KKC/GA/098	FR/PC DA
revision	revision
-	-