



# Regent's Place Phase 2

## Public Realm

NMA Report

August

2021



---

# Contents

**01**            Summary of Non-Material Amendments

**02**            Consented Planning Drawings & Proposed

# 01 Summary of Non - Material Amendments

	Name	Description of NMA
01	Architectural coordination with proposed timber pavilion structures	Planter layouts have been amended to accommodate the proposed pavilions. Tiered bleacher seating has been relocated from the corner of 350 Euston Road to within the largest proposed pavilion. Timber benches have been adapted to align with the new planter layouts and proposed pavilions.
02	Lighting coordination with proposed timber pavilion structures	High level lighting has changed from a catenary system suspended from 6m timber columns to 4m powder-coated galvanized columns with multi-head spotlights, to maintain clear views through the space towards the proposed pavilions. Additional low level uplighters have been specified to the proposed timber pavilions.
03	Architectural coordination with consented temporary 2 storey container market (2020/3192/P)	The two southern-most planter/seating structures to the plaza have been omitted to maintain clear pedestrian movement routes around the consented temporary container market. The forms of the six remaining planters have been softened to create curved edges to the planters, in keeping with the organic forms elsewhere in the design.



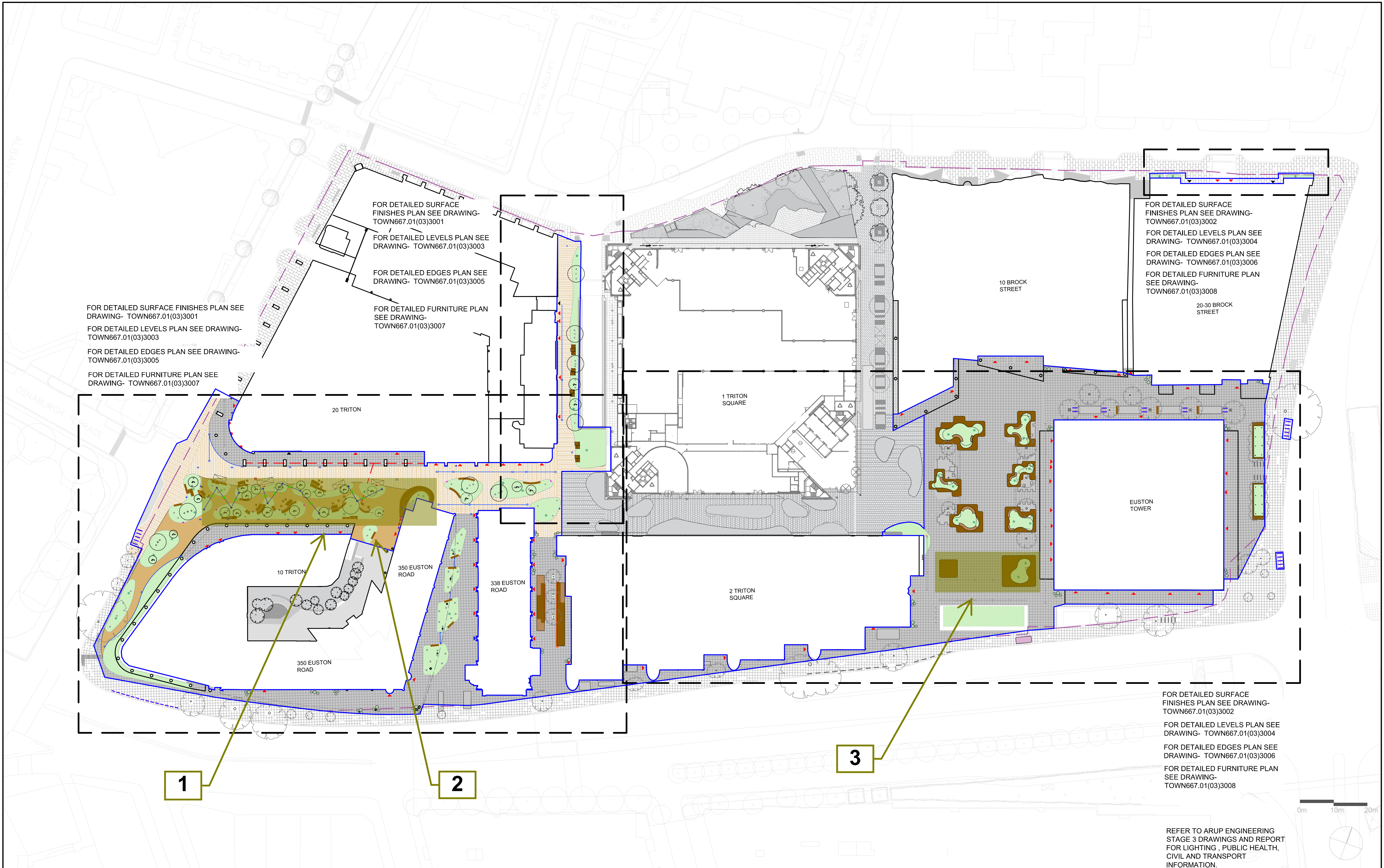

<b>GENERAL NOTES</b> 1. DO NOT SCALE DRAWING. 2. ALL SETTING OUT, LEVELS AND DIMENSIONS TO BE AGREED ON SITE. 3. THE DIMENSIONS OF ALL MATERIALS MUST BE CHECKED ON SITE BEFORE BEING LAID OUT. 4. THIS DRAWING MUST BE READ WITH THE RELEVANT SPECIFICATION CLAUSES AND DETAIL DRAWINGS. 5. ORDER OF CONSTRUCTION AND SETTING OUT TO BE AGREED ON SITE.			<b>CLIENT</b> <b>British Land</b> 45 Seymour Street, London W1H 7LX Telephone: 020 7486 4466 Fax: 020 7935 5552 E-Mail info@britishland.com			<b>CONSULTANT</b> <b>TOWNSHEND</b> LANDSCAPE ARCHITECTS Northumberland House 303-306 High Holborn   London WC1V 7JZ E-mail: tia@townshendia.com Telephone: 020 7729 9333			<b>PROJECT</b> <b>REGENTS PLACE - PHASE 2</b>			<b>PROJECT NUMBER</b> 667.01			<b>DATE</b> JULY 2019		
<b>HEALTH AND SAFETY INFORMATION</b> REFER TO HEALTH AND SAFETY FILE.									<b>TITLE</b> Landscape Key Plan			<b>SCALE (@ A1)</b> 1:10			<b>DRAWN BY</b> FL <b>CHECKED BY</b> SP		
															<b>DRAWING NUMBER</b> TOWN667.01(03)3000		
															<b>REV</b> 06		