

02 Consented Planning Drawings & Proposed Drawings

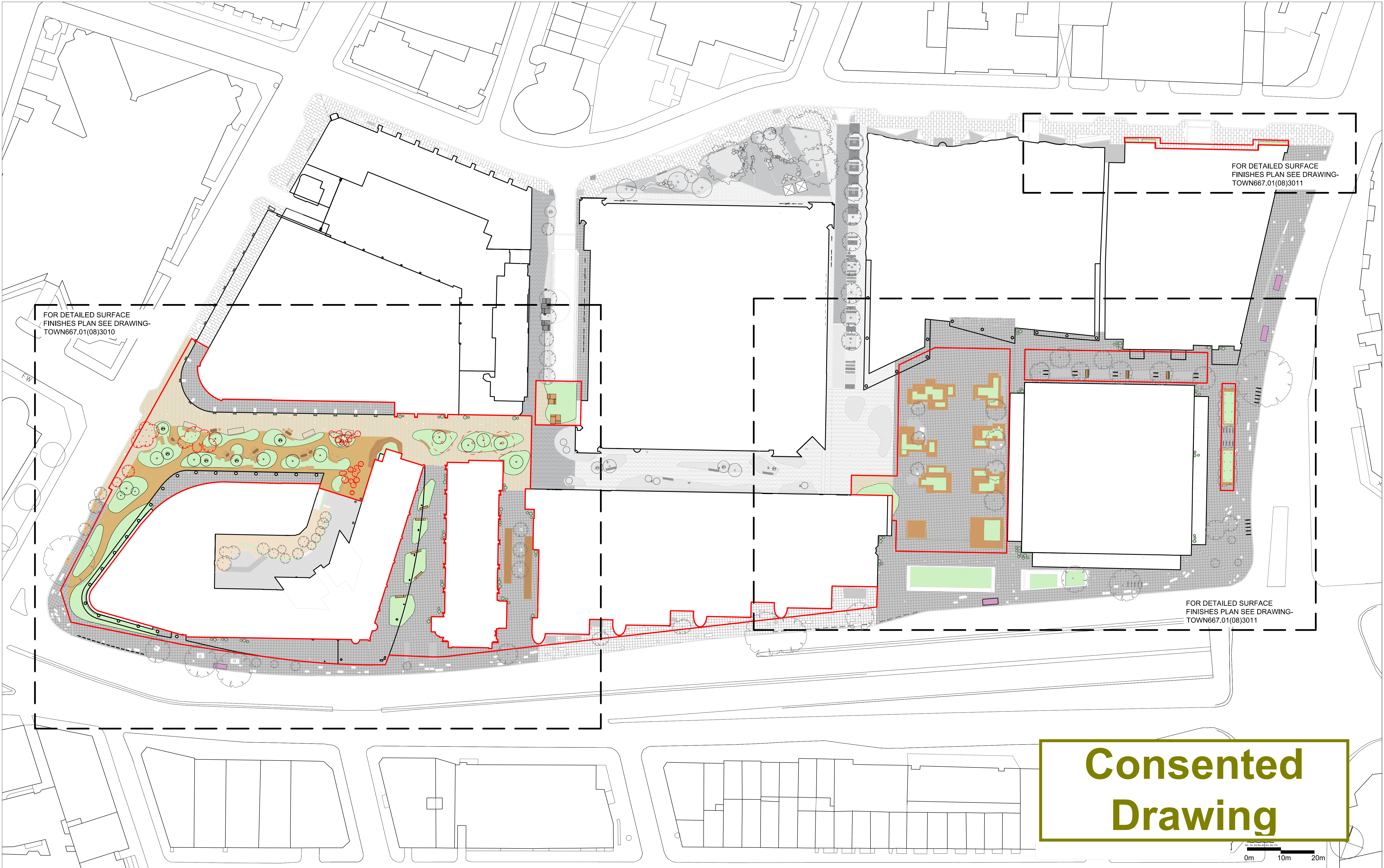
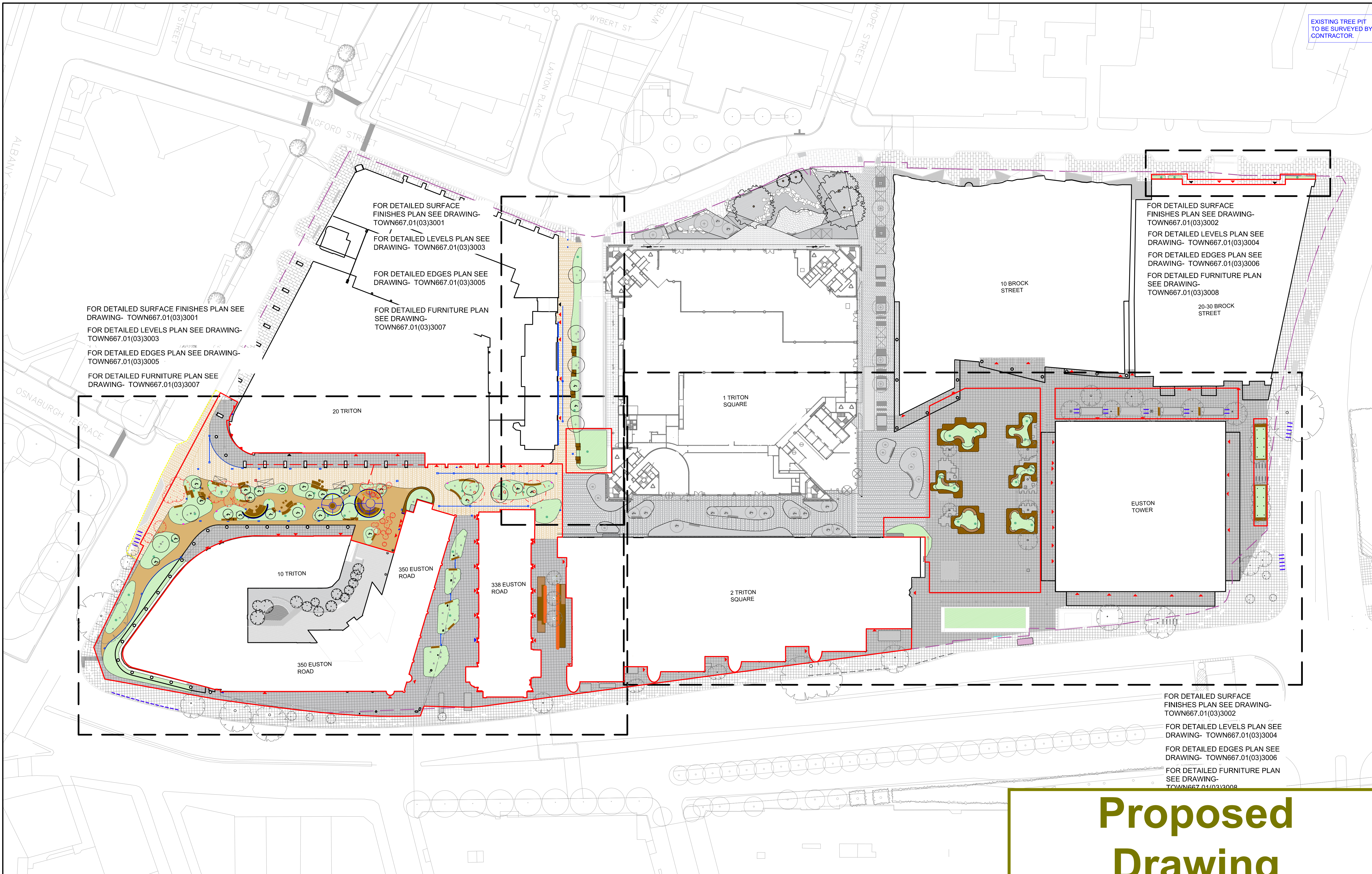

**Consented
Drawing**

Project Regent's Place Phase 2	Drawing Title Key Plan	Revision	Date					Client	Consultant	Project No.	Scale	Approved By	Drawing No.	Revision
		R00 - Planning Issue	12.07.19					British Land 45 Seymour Street, London W1H 7LX Telephone: 020 7486 4466 Fax: 020 7935 5552 E-Mail info@britishland.com	TOWNSHEND Landscape Architects Northumberland House, 303-306 High Holborn London WC1V 7JZ Telephone: 020 7729 9333 Fax: 020 7729 3300 E-Mail tla@townshenda.com	667.01	1:500	OB		R04
		R01 - Planning Issue	12.09.19							Date	Drawing Size	Drawn By	TOWN667.01(08)3000	
		R02 - Planning Issue	30.03.20							SEPT 19	A1	FL		
		R03- Planter amended	09.06.20											
		R04 - Cycle stand removed	08.07.20											

EXISTING TREE PIT
TO BE SURVEYED BY
CONTRACTOR.



Proposed Drawing

GENERAL NOTES

1. DO NOT SCALE DRAWING.
2. ALL SETTING OUT, LEVELS AND DIMENSIONS TO BE AGREED ON SITE.
3. THE DIMENSIONS OF ALL MATERIALS MUST BE CHECKED ON SITE BEFORE BEING LAID OUT.
4. THIS DRAWING MUST BE READ WITH THE RELEVANT SPECIFICATION CLAUSES AND DETAIL DRAWINGS.
5. ORDER OF CONSTRUCTION AND SETTING OUT TO BE AGREED ON SITE.

HEALTH AND SAFETY INFORMATION

REFER TO HEALTH AND SAFETY FILE

Rev	Description	Date
02	MINOR LAYOUT UPDATE	09.08.19
03	STAGE 3 ISSUE	23.08.19
04	Stage 3 Work in progress	09.09.19
05	Stage 3 Issue for Tender	18.09.19
06	Stage 3	08.11.19
07	REVISED STAGE 3	27.05.21
08	LINKED FILES RELOCATED AND S278 UPDATES	14.07.21
09	BOUNDARY LINE AND TREES REMOVAL UPDATED	18.02.21

CLIENT

British Land
45 Seymour Street, London W1H 7LX
Telephone: 020 7486 4466 Fax: 020 7935 5552
E-Mail info@britishland.com

CONSULTANT

TOWNSHEND
LANDSCAPE ARCHITECTS

Northumberland House 303-306 High Holborn | London WC1V 7JZ
E-mail: tia@townshendla.com
Telephone: 020 7729 9333

PROJECT

REGENTS PLACE - PHASE 2

TITLE

Landscape Key Plan

SCALE (@ A1)

1:500

DRAWN BY FL

CHECKED BY SP

DRAWING NUMBER

TOWN667.01(03)3000

REV

09



PLAN ON DRUMMOND STREET
SCALE 1:250

KEY

PHASE 2 PLANNING APPLICATION BOUNDARY

PAVING

PAVING TYPE 1B
200 mm WIDTH x 400 mm LENGTH x 75mm DEPTH, 350 mm WIDTH x 600mm LENGTH x 75mm DEPTH, FINE PICKED GRANITE STONE WITH SAWN EDGES.
COLOUR MIX - TBC
SOURCE - EUROPE

3mm-6mm AGGREGATE 15mm THICK BRITTANY BRONZE RESIN BONDED GRAVEL BY ADDAGRIP OR EQUAL

GRANITE FOOTPATHS FINISHES INCLUDING UTILITY COVERS TO REMAIN IN SITU (AZUL ESPANA - 745mm WIDTH x 745mm LENGTH x DEPTH VARIES)

RECLAIMED GRANITE FLAGS (AZUL ESPANA - 745mm WIDTH x 745mm LENGTH x DEPTH TBC)

EXISTING GRATING FOR VENTILATION - LEAVE IN SITU

BUILDING OUTLINE

STREET FURNITURE

EXISTING BUS STOP

PROPOSED TIMBER BENCHES

PROPOSED TIMBER TERRACED SEATING

PROPOSED TIMBER BLEACHER SEATS

PROPOSED SCULPTURAL SEATING PLATFORMS

PROPOSED TIMBER DECKING PLATFORMS

PROPOSED LOCATION FOR FOOD TRUCKS (3720mm LENGTH x 1500mm WIDTH x 2000mm HEIGHT) (4800mm LENGTH x 1660mm WIDTH x 1850mm HEIGHT)

EXISTING CYCLE RACKS

PROPOSED CYCLE RACKS

INDICATIVE LOCATION OF FREE STANDING PLANT POTS

PLANTING

PROPOSED TREE

PROPOSED MULTI STEM TREE

EXISTING TREE TO BE REMOVED

EXISTING TREE TO BE RETAINED

PLANTER WITH SHRUBS AND HERBACEOUS PLANTS

EXISTING PLANTERS TO BE RETAINED

DRAINAGE

EXISTING SLOT DRAIN

Consented
Drawing

Project	Drawing Title	Revision	Date					Client	Consultant	Project No.	Scale	Approved By	Drawing No.	Revision
Regent's Place Phase 2	Surface Finishes Plan 2 Phase 2 - Interim Works	R00 - Planning Issue	12.07.19					British Land	TOWNSHEND Landscape Architects	667.01	1:250	MA		R01
		R01 - Planning Issue	12.09.19					45 Seymour Street, London W1H 7LX Telephone: 020 7486 4466 Fax: 020 7935 5552 E-Mail info@britishland.com	Northumberland House, 303-306 High Holborn London WC1V 7JZ Telephone: 020 7729 9333 Fax: 020 7729 3300 E-Mail ta@townshenda.com	Date	Drawing Size	Drawn By	TOWN667.01(08)3011	
										SEPT' 19	A1	FL		



KEY

PHASE 2 PROJECT BOUNDARY

S278 BOUNDARY

INDICATIVE MOVEMENT JOINT LOCATION

FIRE ACCESS

INDICATIVE LOCATION DRY RISER LOCATION

BUILDING OUTLINE

EXISTING BUS STOP

PAVING

PAVING TYPE 1B
200 mm WIDTH x 398 mm LENGTH x 50mm DEPTH,
350 mm WIDTH x 600mm LENGTH x 50mm DEPTH,
GRANITE PAVING BY MARSHALLS OR EQUAL
AND APPROVED

3mm - 6mm AGGREGATE 18mm THICK
BRITTANY BRONZE RESIN BONDED GRAVEL BY
ADDAGRIP OR EQUAL AND APPROVED

EXISTING GRANITE PAVING INCLUDING UTILITY
COVERS TO REMAIN IN SITU (AZUL ESPANA -
745mm WIDTH x 745mm LENGTH x DEPTH
VARIES)

STREET FURNITURE

PROPOSED TIMBER BENCHES

PROPOSED TIMBER LOUNGER

PROPOSED TIMBER BLEACHER

PROPOSED SCULPTURAL
SEATING PLATFORMS

PROPOSED CORTEN GRILLE
AREA

PROPOSED TIMBER DECKING
PLATFORMS

EXISTING GRANITE PAVING INCLUDING
UTILITY COVERS OUTSIDE OUTSIDE STAGE
3 BOUNDARY (AZUL ESPANA - 745mm WIDTH
x 745mm LENGTH x DEPTH VARIES)

EXISTING GRATING FOR VENTILATION
- LEAVE IN SITU

GRANITE SETTS IN LAYBY TO LOCAL
AUTHORITY DETAIL AND
SPECIFICATION

PROPOSED GRILLE OVER EXISTING
GRILLE TO MAINTAIN THE FREE AREA
REQUIREMENTS

EXISTING CYCLE RACKS

PROPOSED CYCLE RACKS

INDICATIVE LOCATION NON
POTABLE WATER POINT

INDICATIVE LOCATION OF
DRINKING FOUNTAIN AND
POTABLE WATER POINT

INDICATIVE LOCATION OF
PROPOSED POWER POINT TYPE A
TO ARUP SPECIFICATION

INDICATIVE LOCATION OF PROPOSED
POWER POINT TYPE B TO ARUP
SPECIFICATION

INDICATIVE LOCATION OF PROPOSED
POWER POINT TYPE C TO ARUP
SPECIFICATION

PROPOSED LOCATION FOR FOOD
TRUCKS

DRAINAGE

EXISTING SLOT DRAIN - TO BE
RETAINED

10mm SLOT GALVANISED STEEL
FACADE SLOT BY KENT
STAINLESS OR EQUAL AND
APPROVED

EXISTING GULLIES

PROPOSED GULLIES

PROPOSED GULLIES IN

PROPOSED MANHOLE
WATER ACCESS

PLANTING

PROPOSED TREE

PROPOSED MULTI
STEM TREE

EXISTING TREE TO
BE RETAINED

PROPOSED SHRUB PLANTING

EXISTING PLANTERS AT
PLAZA TO BE RETAINED

EXISTING PLANTERS AT

GENERAL NOTES

1. DO NOT SCALE DRAWING.
2. ALL SETTING OUT, LEVELS AND DIMENSIONS TO BE AGREED
ON SITE.
3. THE DIMENSIONS OF ALL MATERIALS MUST BE CHECKED ON
SITE BEFORE BEING LAID OUT.
4. THIS DRAWING MUST BE READ WITH THE RELEVANT
SPECIFICATION CLAUSES AND DETAIL DRAWINGS.
5. ORDER OF CONSTRUCTION AND SETTING OUT TO BE
AGREED ON SITE.

HEALTH AND SAFETY INFORMATION

REFER TO HEALTH AND SAFETY FILE.

Rev	Description	Date
00	First Issue	12.07.19
01	PLANTER EDGES REVISED	26.07.19
02	MINOR LAYOUT UPDATE	09.08.19
03	STAGE 3 ISSUE	23.08.19
04	Stage 3 Issue for Tender	20.09.19
05	Stage 3	08.11.19
06	LINKED FILES RELOCATED	14.07.21
07	BOUNDARY LINE AND TREES REMOVAL UPDATED	18.08.21

CLIENT

British Land

45 Seymour Street, London W1H 7LX
E-mail: info@britishland.com
Telephone: 020 7486 4466 Fax: 020 7935 5552

CONSULTANT

TOWNSHEND LANDSCAPE ARCHITECTS

Northumberland House 303-306 High Holborn | London WC1V 7JZ
E-mail: tla@townshendia.com
Telephone: 020 7729 9333

PROJECT

REGENTS PLACE - PHASE 2

TITLE

Surface Finishes Plan Sheet 2

PROJECT NUMBER

667.01

SCALE (@ A1)

1:250

DRAWN BY

FL

CHECKED BY

SP

DRAWING NUMBER

TOWN667.01(03)3002

REV

07

REFER TO ARUP ENGINEERING
STAGE 3 DRAWINGS AND REPORT
FOR LIGHTING , PUBLIC HEALTH,
CIVIL AND TRANSPORT
INFORMATION.

CHANNEL LIGHTING TO LIGHTING
ENGINEERS SPECIFICATION

LIGHTING COLUMNS TO LIGHTING
ENGINEERS SPECIFICATION

LINEAR LIGHTING TO LIGHTING
ENGINEERS SPECIFICATION

LIGHTING TO ENGINEERS DETAIL
SPECIFICATION

DRAINAGE CHANNEL TO THE GREEN
WALL BY LATERAL DESIGN STUDIOS
OR EQUAL AND APPROVED

Proposed
Drawing



- KEY**
- PHASE 2 PLANNING APPLICATION BOUNDARY
- PAVING**
- PAVING TYPE 1B
200 mm WIDTH x 400 mm LENGTH x 75mm DEPTH, 350 mm WIDTH x 600mm LENGTH x 75mm DEPTH, FINE PICKED GRANITE STONE WITH SAWN EDGES.
COLOUR MIX - TBC
SOURCE - EUROPE
 - 3mm-6mm AGGREGATE 15mm THICK BRITTANY BRONZE RESIN BONDED GRAVEL BY ADDAGRIP OR EQUAL
 - GRANITE FOOTPATHS FINISHES INCLUDING UTILITY COVERS TO REMAIN IN SITU (AZUL ESPANA - 745mm WIDTH x 745mm LENGTH x DEPTH VARIES)
 - RECLAIMED GRANITE FLAGS (AZUL ESPANA - 745mm WIDTH x 745mm LENGTH x DEPTH TBC)
 - EXISTING GRATING FOR VENTILATION - LEAVE IN SITU
 - BUILDING OUTLINE
- STREET FURNITURE**
- EXISTING BUS STOP
 - PROPOSED TIMBER BENCHES
 - PROPOSED TIMBER TERRACED SEATING
 - PROPOSED TIMBER BLEACHER SEATS
 - PROPOSED SCULPTURAL SEATING PLATFORMS
 - PROPOSED TIMBER DECKING PLATFORMS
 - PROPOSED LOCATION FOR FOOD TRUCKS (3720mm LENGTH x 1500mm WIDTH x 2000mm HEIGHT) (4800mm LENGTH x 1660mm WIDTH x 1850mm HEIGHT)
 - EXISTING CYCLE RACKS
 - PROPOSED CYCLE RACKS
 - INDICATIVE LOCATION OF FREE STANDING PLANT POTS
- PLANTING**
- PROPOSED TREE
 - PROPOSED MULTI STEM TREE
 - EXISTING TREE TO BE REMOVED
 - EXISTING TREE TO BE RETAINED
 - PLANTER WITH SHRUBS AND HERBACEOUS PLANTS
 - EXISTING TREE PITS
 - EXISTING PLANTERS TO BE RETAINED
- DRAINAGE**
- EXISTING SLOT DRAIN

**Consented
Drawing**



Project Regent's Place Phase 2	Drawing Title Surface Finishes Plan 1 Phase 2 - Permanent Works	Revision	Date	R05 - Cycle stand removed	08.07.20		Client British Land 45 Seymour Street, London W1H 7LX Telephone: 020 7486 4466 Fax: 020 7935 5552 E-Mail info@britishland.com	Consultant TOWNSHEND Landscape Architects Northumberland House, 303-306 High Holborn London WC1V 7JZ Telephone: 020 7729 9333 Fax: 020 7729 3300 E-Mail tla@townshenda.com	Project No. 667.01	Scale 1:250	Approved By MA	Drawing No. TOWN667.01(08)3010	Revision R05
		R00 - Planning Issue	12.07.19						Date SEPT '19	Drawing Size A1	Drawn By FL		
		R01 - Planning Issue	12.09.19										
		R02 - Planning Issue	30.04.20										
		R03 - Scale bar updated	20.05.20										
		R04 - Planter amended	20.06.09										