

5 New cast iron waste pipes.

Proposed film to window

Proposed condenser unit to level 09 terrace

Level 9

Level 8

3 New waste pipes cross over existing cabin roof

Existing cabins

Key

Revision Schedule

P1	Draft issue for planning	03/09/21
P2	Proposed drainage updates	08/09/21
P3	Issued for Planning	27/09/21

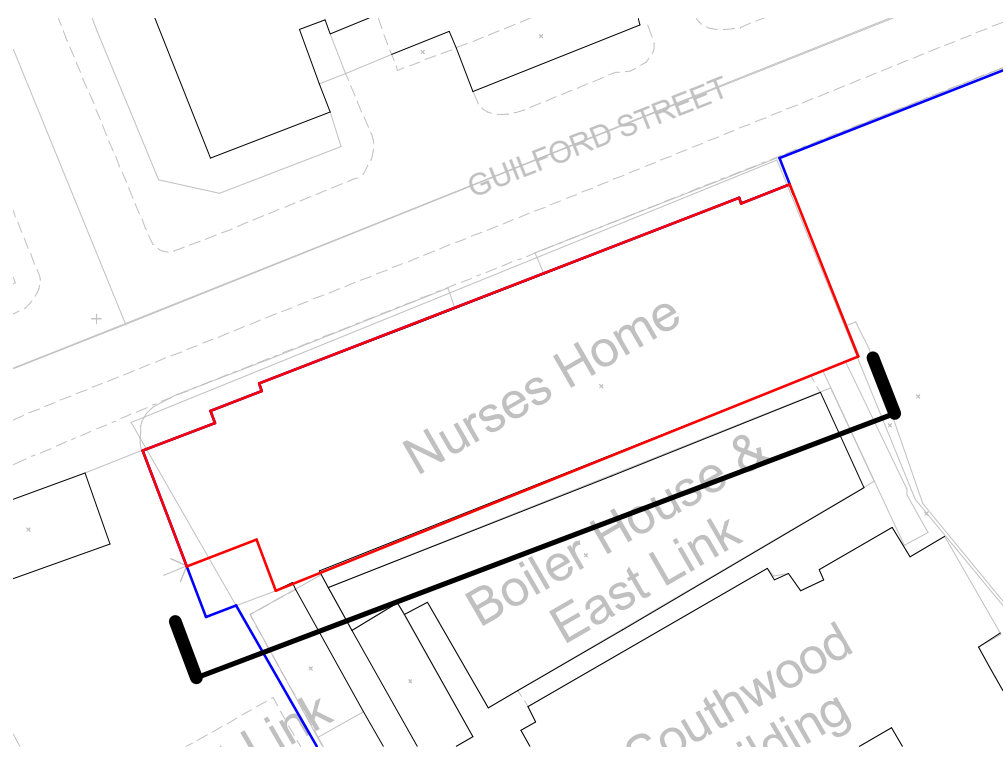

DO NOT SCALE OFF DRAWINGS  
REPORT ALL DISCREPANCIES  
CHECK ALL DIMENSIONS ON SITE

0 5 10 m

© Copyright Murphy Philipps 2021  
Prepared using Revit 2018

1:100 (@ A1)

Planning

Proposed South Elevation  
at  
Main Nurses Home  
for  
GOSH NHS Foundation Trust

MURPHYPHILIPPS

3274 - MPA - ZZ - ZZ - DR - A - 01053  
REV:P3 -27/09/21  
Scale: As indicated @ A1

MPA project number.: 3244

16 Wenlock Road London, N1 7TA Tel: 020 7490 8008 Fax: 020 7490 8778