

Demolition Key

Alterations to existing timber galleries and all openings made within masonry walls to be confirmed by Structural Engineer.
Alterations/removal of services (Mechanical & Electrical) to be in accordance with Green Building Design Consultants design and detail.

ASBESTOS NOTES-
INDICATIVE NOTES ARE ADDED TO THE DRAWING FOR INFORMATION ONLY. THE ASBESTOS SURVEY SHOULD BE READ IN CONJUNCTION WITH THIS DRAWING- H5968 - Dr Williams Library - Management Survey

- Wall Demolished- Full Height
Ceiling, floor and adjoining walls to be made good. All doors within walls highlighted in red to be removed. All historic six panel doors to be retained and used elsewhere / stored.
- Wall Demolished- Opening
Wall section removed as indicated, floor and adjoining walls to be made good.
- Door Opening Increased
Existing door removed, opening height to suit existing door height, architrave altered. All historic six panel doors to be retained and used elsewhere / stored.
- New Door Opening
Wall section removed as indicated, floor and skirting to be made good.
- Floor Altered
Floor removed/altered, refer to notes. Asterisk (*) highlights proposed riser locations. Works to avoid joists being cut where possible, service distribution to suit.
- Damaged Wall- Retained
Walls requiring structural repair due to overloading. Works required- removal of the existing lath and plaster, damaged timber frame to be repaired, Limelite Renovating plaster to be put back on savolit boards where required.

- Asbestos Note
Asbestos removal sought unless noted on the drawing. Refer to the Heritage Impact Assessment (8555-CPM- ZZ-ZZ-RP-A-10001) and Asbestos survey (H5968 - Dr Williams Library - Management Survey) for further information on proposed works.
- Permission Not Being Sought
Works already approved 09.11.20- Application ref: 2020/2721/L
- Door Removal
Door to be removed, all historic six panel doors to be retained and used elsewhere / stored.
- Door Removal- Opening
Door to be removed architrave and frame to be made good. All historic six panel doors to be retained and used elsewhere / stored
- Door Closed Off
Door to be retained to one side, plaster finish as indicated on proposed GA plans..
- Door Re-Hung
Door to be carefully re-hung as indicated on the proposed plans, works to be carried out by suitable craftsman.
- Door Altered
Historic door falls on fire line, remedial works required to existing door.
- Refer to drawing for object specific notes.
- Trees / Shrubs
To be removed, including roots and surfaces made good.

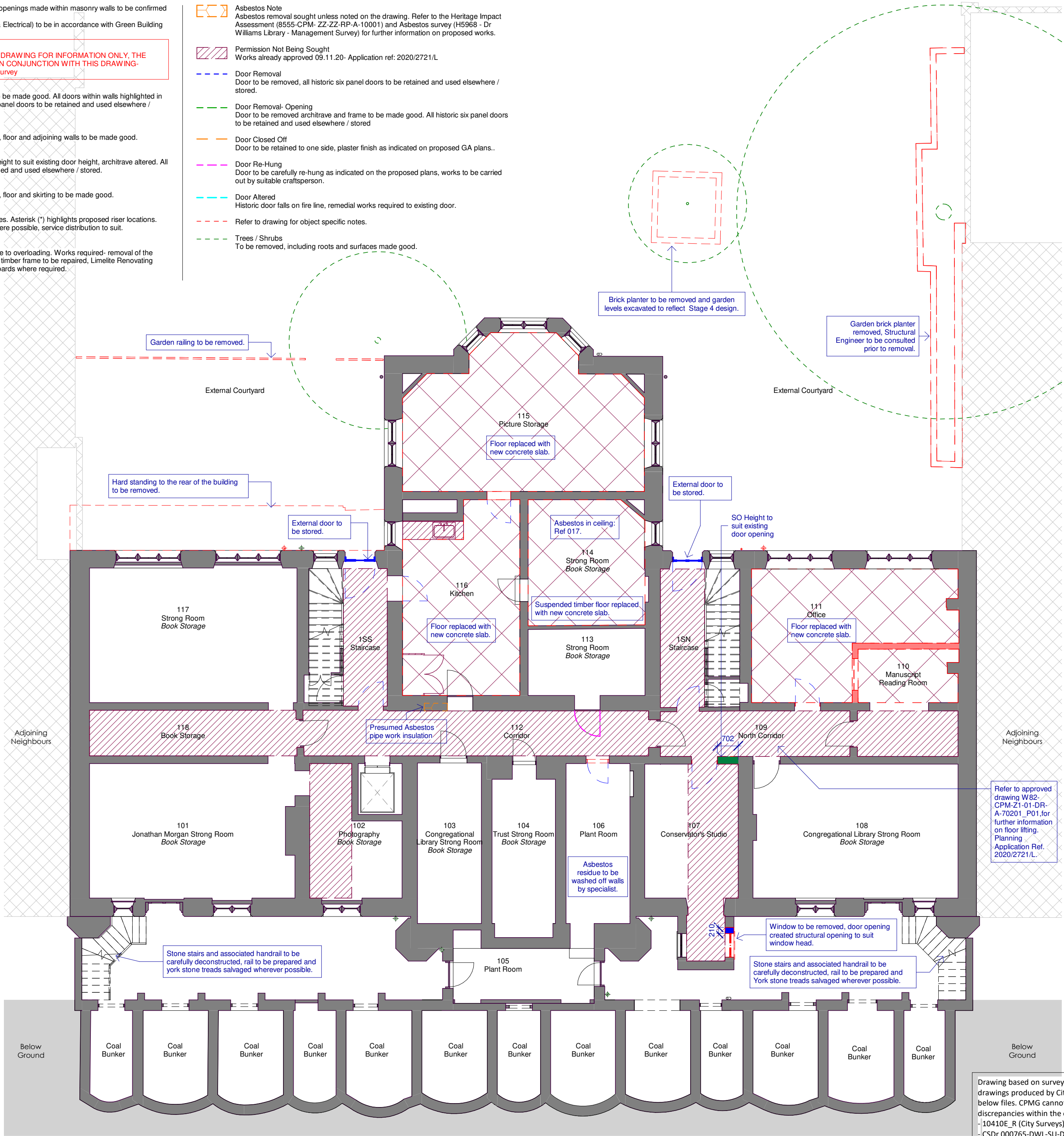

P06	2021-11-02	Door to room 111 altered to show structural opening unchanged.
P05	2021-11-02	Drawing updated following conversations with Conservation Officer.
P04	2021-08-27	Drawing issued for Planning
P03	2020-02-13	Plans updated following design workshop.
P02	2019-11-13	Room numbers updated.
P01	2019-11-08	Planning Issue

REV	DATE	DESCRIPTION
-----	------	-------------

ORIGINATOR REF: 8555



CPMG Architects Ltd

Nottingham 13 St. Peters Gate, Nottingham, NG1 2JF tel: 0115 958 9500
London 31/35 Kirby Street, London, EC1N 8TE tel: 0207 492 1805
Birmingham The Lewis Building 35 Bull Street Birmingham B4 6EQ tel: 0121 481 2092

enquiries@cpmg-architects.com www.cpmg-architects.com

PROJECT

Dr Williams's Library
Library Building

DRAWING TITLE

DEMOLITION PLANS

Demolition Plan - Level 01

DRAWING PURPOSE

PLANNING

DRAWN BY	DATE	CHK'D BY	SCALE	MEDIA
HW	2019-07-15	AP	1 : 100	A2
PROJECT - ORIGINATOR - ZONE - LEVEL - TYPE - ROLE - NUMBER				REVISION

W82-CPM-Z1-01-DR-A-11001 **P06**

Drawing based on survey information, Revit model and CAD drawings produced by City Survey's and Survey Hub, refer to below files. CPMG cannot be held responsible for any discrepancies within the original Revit survey or CAD drawings.
- 10410E_R (City Surveys)
- CSDr 000765-DWL-SU-DRG-0001-A01.rvt (City Surveys)
- 3916_Dr Williams Library_3D Model (Survey Hub)

Copyright of CPMG Architects Limited 2019. All rights reserved. No part of this publication may be reproduced, stored in any retrieval system or transmitted in any form or by any means without prior permission of CPMG Architects Limited. Do not scale from drawing for Construction or Setting-out purposes, use figured dimensions only. All dimensions to be checked on site.

ISO 9001: 2015 Quality Management
ISO 14001: 2015 Environmental Management
PAS 1192-2: 2013 Building Information Modelling