

revision / date / amendments
- / 01/03/21 / FIRST ISSUE - STAGE 4
A / 10/03/21 / Updated wall on gents toilet 1-13 and new lightwell toilets, legend, general notes & NBS spec.
B / 16/04/21 / Updated legend & toilet walls at new lightwell toilet [DT 07, DT13, DT14 & DT16]

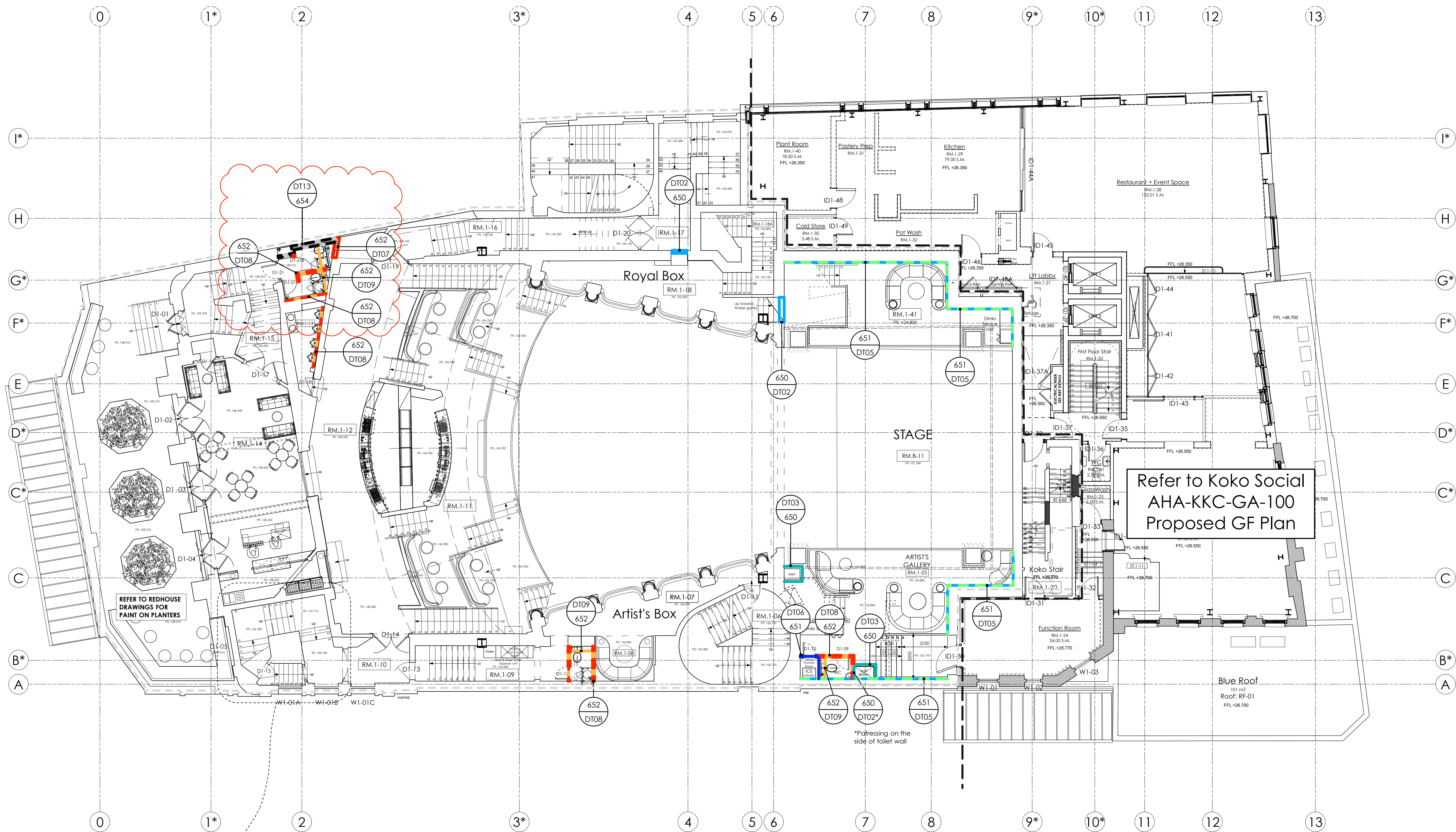

- NOTE:**
- REFER TO TYPICAL NEW WALL DETAILS:  
AHA-KKR-DET-650 - 654
  - REFER TO WALL FINISHES GA'S:  
AHA-KKR-GA-599 - 604
  - REFER TO TOILET DETAILS:  
AHA-KKR-DET-350 - 391
  - REFER TO TYPICAL FLOOR TYPE DETAILS:  
AHA-KKR-DET-419 - 423
  - REFER TO GENERIC CEILING DETAILS:  
AHA-KKR-DET-720 - 721

1 New Wall Types  
 First Floor Plan  
 Scale: 1:100

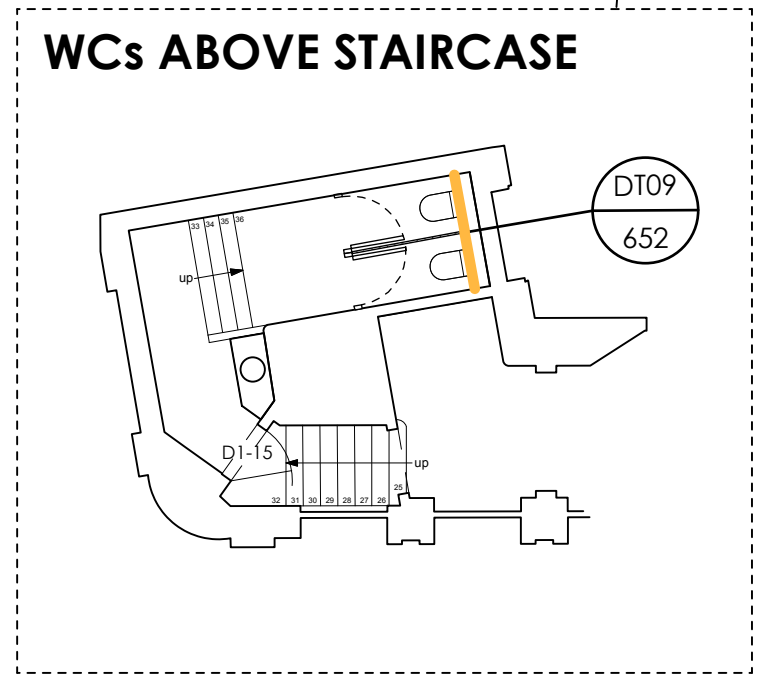

**NEW WALL TYPES**

**COMMON TO ALL FLOORS**

\*Please refer to New Wall Details - DT01 - DT16:

DT01 Internal wall build-up containing beer pylon pipes NBS Spec: K10/115 AHA/KKR/DET/650/New Wall Types/DETAIL DT01	DT09 Walls of all toilet cisterns NBS Spec: K10/155 AHA/KKR/DET/652/New Wall Types/DETAIL DT09
DT02 Internal wall build-up between various locations as listed above NBS Spec: K10/115 AHA/KKR/DET/650/New Wall Types/DETAIL DT02	DT10 Third Floor Air-tight double glazed panel NBS Spec: L40 AHA/KKR/DET/653/New Wall Types/DETAIL DT10
DT03 Internal wall build-up riser partition NBS Spec: K10/115 AHA/KKR/DET/650/New Wall Types/DETAIL DT03	DT11 Basement Level Altro White-tack NBS Spec: M50/110 AHA/KKR/DET/653/New Wall Types/DETAIL DT11
DT04 Internal wall build-up partition between NBS Spec: K10/115 AHA/KKR/DET/650/New Wall Types/DETAIL DT04	DT12 Acoustic Containment up to the Mezzanine Area NBS Spec: K10/205/Type B AHA/KKR/DET/653/New Wall Types/DETAIL DT12
DT05 Stage Wings and Galleries Acoustic Wall NBS Spec: K10/205/Type A AHA/KKR/DET/651/New Wall Types/DETAIL DT05	DT13 Shaft Wall to New Lightwell Toilets NBS Spec: K10/115/Type D AHA/KKR/DET/654/New Wall Types/DETAIL DT13
DT06 Acoustic wall build-up partition NBS Spec: K10/125 AHA/KKR/DET/651/New Wall Types/DETAIL DT06	DT15 Acoustic screen enclosure Performance of wall to be as Scotch Partners advice. The screen will need to be impermeable, exceed the top of the units by at least 200mm which would make the wall appear 2000mm in height with a surface mass of at least 10kg per m <sup>2</sup> . NBS Spec: Q40/170 AHA/KKR/DET/654/New Wall Types/DETAIL DT15
DT07 First Floor New Lightwell Toilet Brick Infill to Match Existing NBS Spec: K10/145 AHA/KKR/DET/652/New Wall Types/DETAIL DT07	
DT08 IF Toilets, IF Artist Gallery & Artist Box toilets, New Lightwell Toilets & 3F Toilet - New Wall Partitions NBS Spec: K10/155 AHA/KKR/DET/652/New Wall Types/DETAIL DT08	

16.04.21

1:100

**STAGE 4**

Archer Humphries Architects

Basement  
 Central House  
 142 Central Street  
 London, United Kingdom  
 EC1V 8AR  
 T: +44 (0) 20 7251 8555

project title	scale	date
KOKO + Hope & Anchor + Bayham Place, Camden, London	1:100 (A1)	18.02.21
drawing title	drawn	checked
New Wall Types	CLVR	DA
drawing number	revision	
AHA / KKR / GA/611	B	

Note:  
 1. Drawing to be read in conjunction with other consultant details and AHA/KK/DET/650-653 drawings