

Copyright: All rights reserved. This drawing must not be reproduced without permission.

Only the original drawing should be relied upon. Contractors, subcontractors and suppliers must verify all dimensions on site before commencing any work or making any shop drawings.

All shop drawings to be submitted to the architect for comment prior to fabrication.

This drawing is to be read in conjunction with the Architect's specification, bills of quantities / schedules, structural, mechanical & electrical drawings and all discrepancies are to be reported to the architect.

Do not scale from this drawing. Dimensions are in millimetres unless otherwise stated.

revision / date / amendments

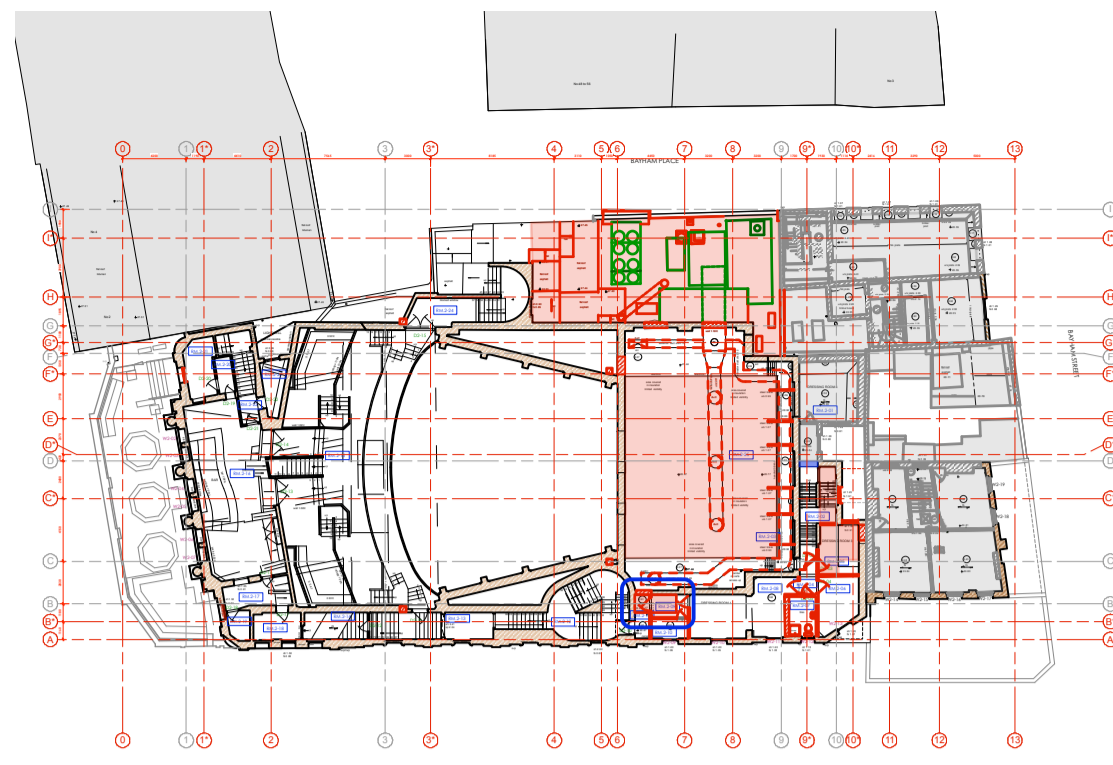

1 Proposed 2F Demolition Plan
Scale: 1:500

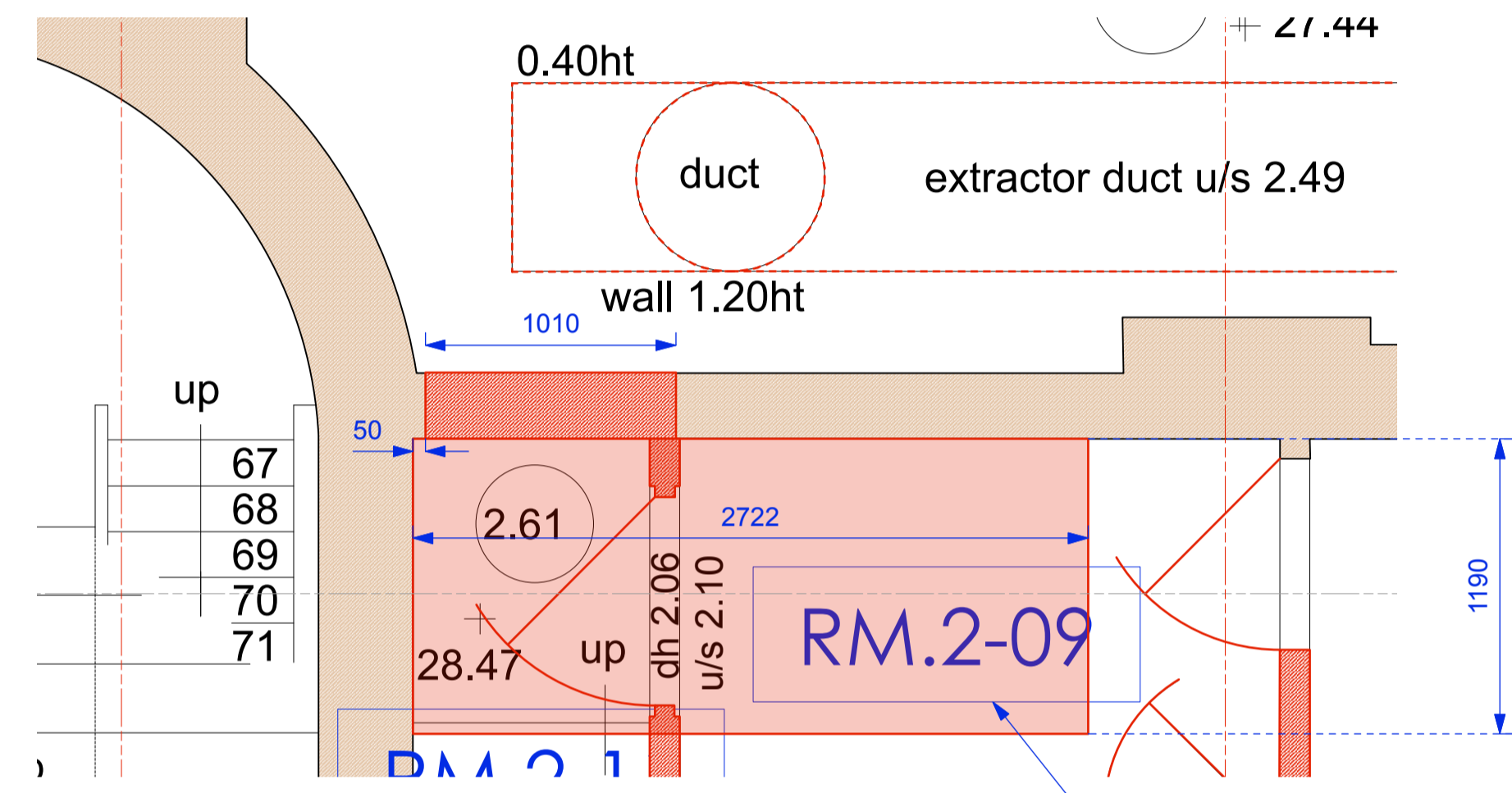

2 Proposed Demolition between Gallery Booths + Flytower Plan
Scale: 1:25

Floor area at Gallery booth level to be demolished to create level threshold and new floor area for new staircase ST.2-04 between Flytower and Gallery booths.

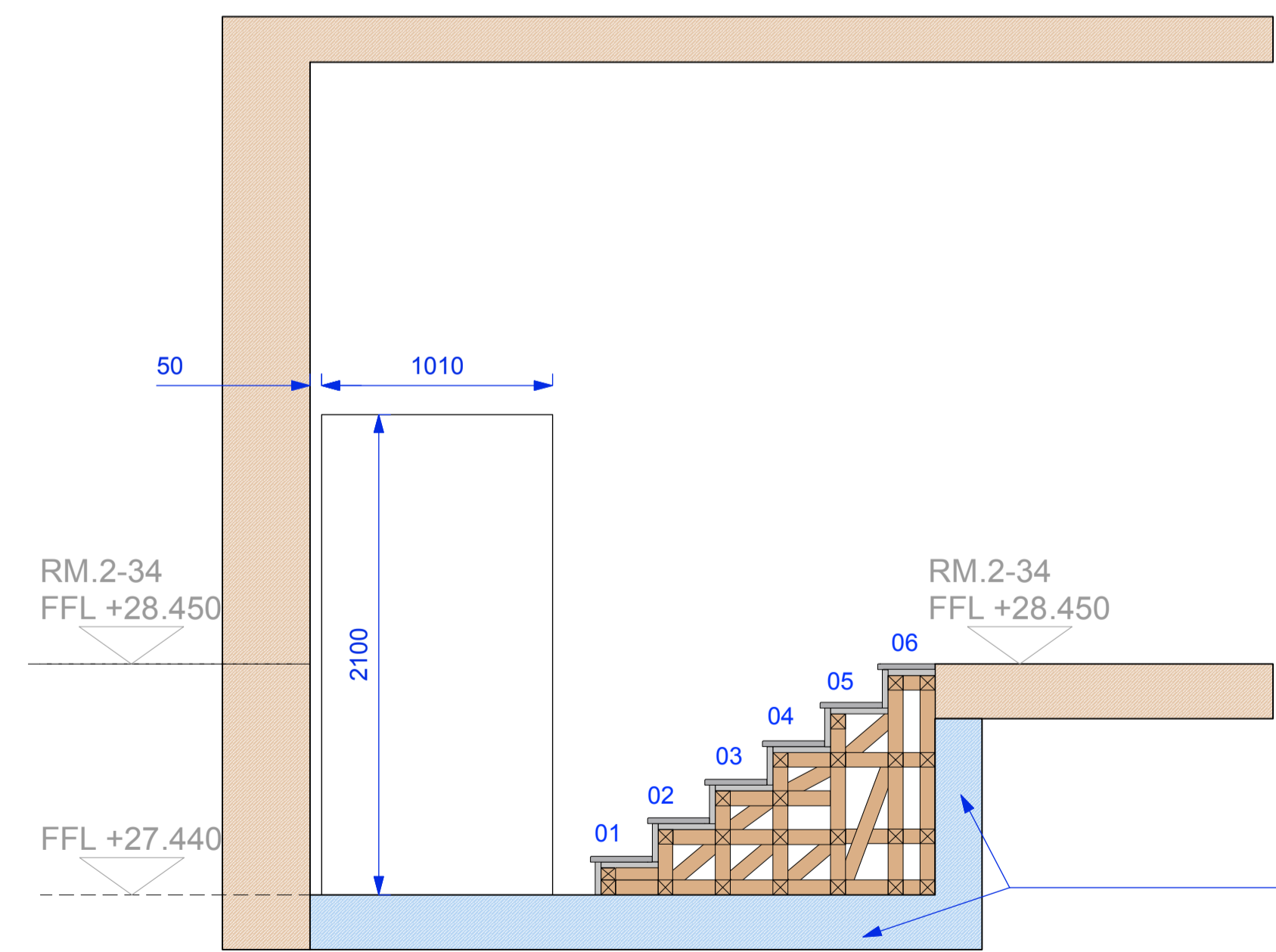

3 Proposed Flytower Entrance
Scale: 1:25

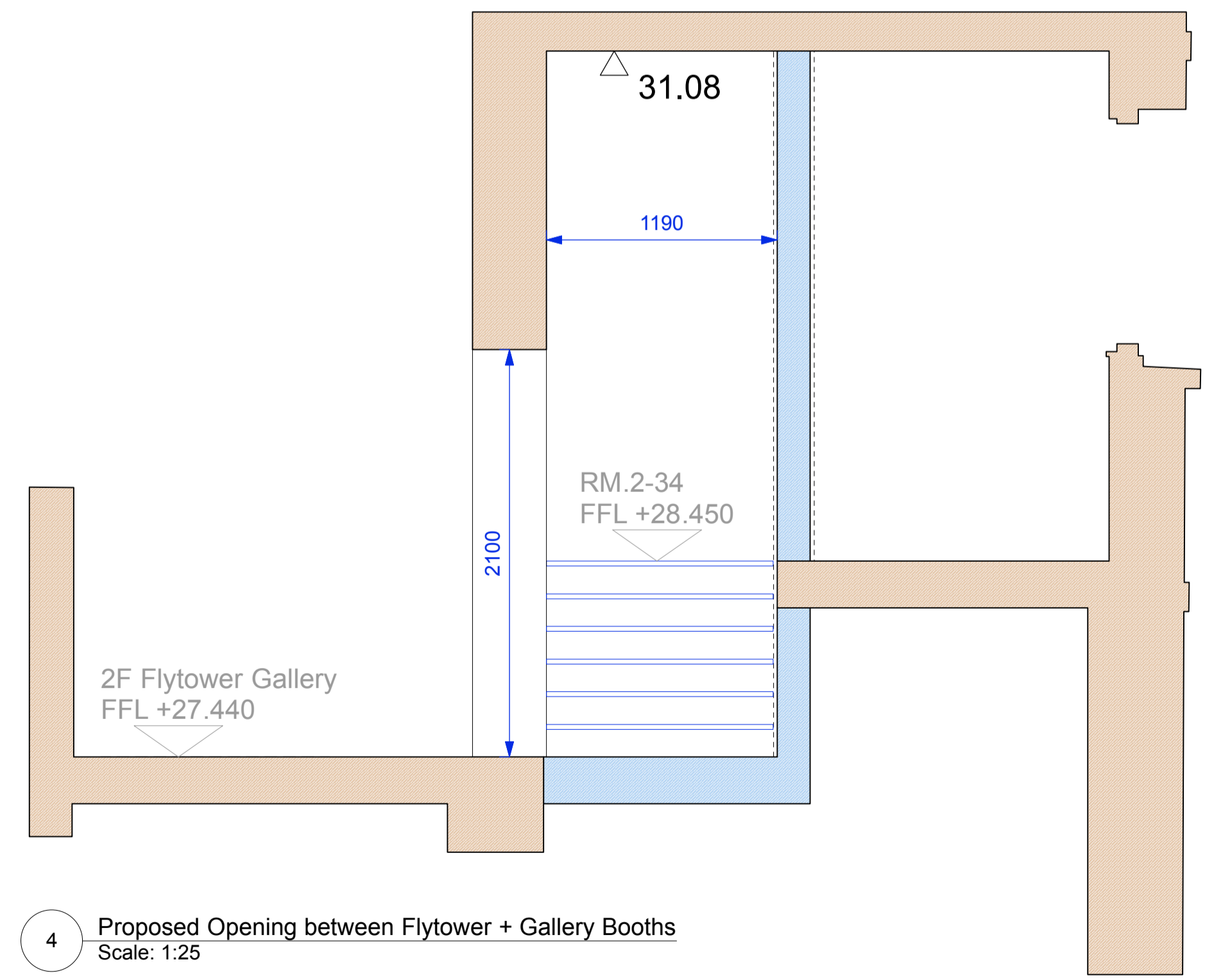

4 Proposed Opening between Flytower + Gallery Booths
Scale: 1:25

- LEGEND**
- Existing Building Fabric KOKO née Camden Palace Theatre (1900)
 - Existing Building Fabric Hope & Anchor (approx. 1850)
 - Existing Building Fabric Bayham Place (from 1875)
 - Existing Modern Building Fabric Bayham Place (from 2006)
 - PHASE 1 Building Fabric to be demolished
 - PHASE 1 Demolition of Flooring / Elevation / Wall
 - PHASE 1 Proposed Excavation
 - Area to be blocked up and made weather tight temporarily whilst KOKO is operational
 - PHASE 2 Proposed Demolition
 - PHASE 2 Demolition of Flooring / Elevation / Wall
 - PHASE 2 Proposed Excavation
 - PHASE 2 Retain + Relocate
 - Retain, protect + make good existing (ease + adjust)
 - Hope & Anchor Demise
 - Koko Demise
 - 1 Bayham Street & 65 Bayham Place Demise

19.12.19

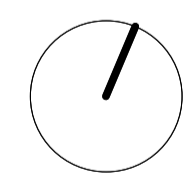

FOR INFORMATION

Archer Humphries Architects

Basement
Central House
142 Central Street
London, United Kingdom
EC1V 8AR
T: +44 (0) 20 7251 8555

project title		KOKO + Hope & Anchor + Bayham Place Camden, London	
drawing title	scale	date	18.10.19
2F Flytower + Gallery Booth Demolition Detail 05.14	Version A1	drawn	FR
drawing number	revision	checked	DA
AHA/KKC/DM/05.14	-	revision	-

NOTE:
1. DRAWING TO BE READ INCONJUNCTION WITH MEP AND STRUCTURAL ENGINEER'S DETAILS.
2. LISTED BUILDING FABRIC TO BE PHOTOGRAPHED PRIOR TO DEMOLITION UNDER LISTED BUILDING CONSENT CONDITION NO.5.
3. REFER TO SCHEDULE OF WORKS AHA/KOKO/SOW/001, 002, 003 + 003A