

1 Proposed Demolition 1F Plan  
Scale: 1:500

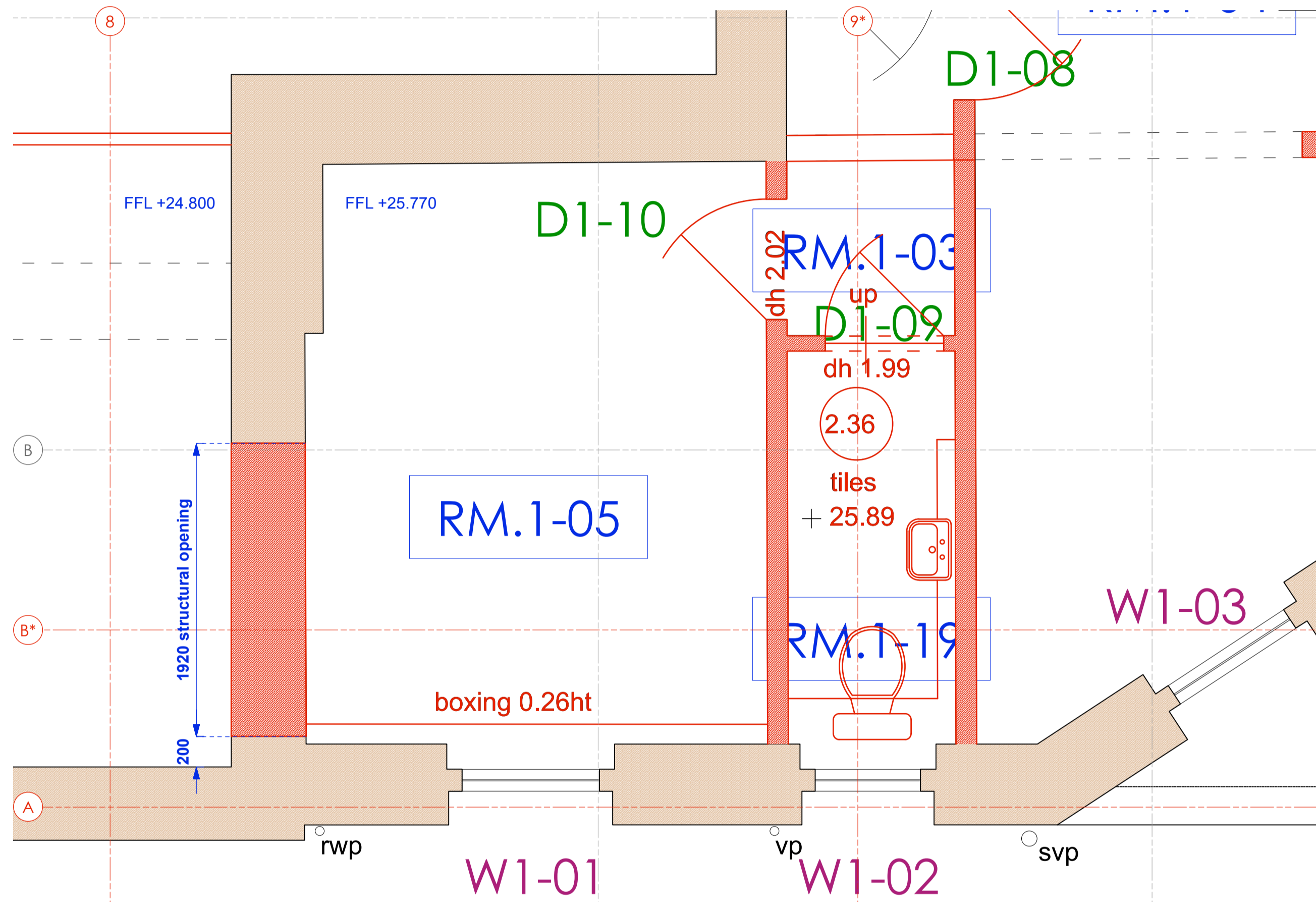

2 Demolition Detail 04.13 - Opening In Function Room Plan  
Scale: 1:25

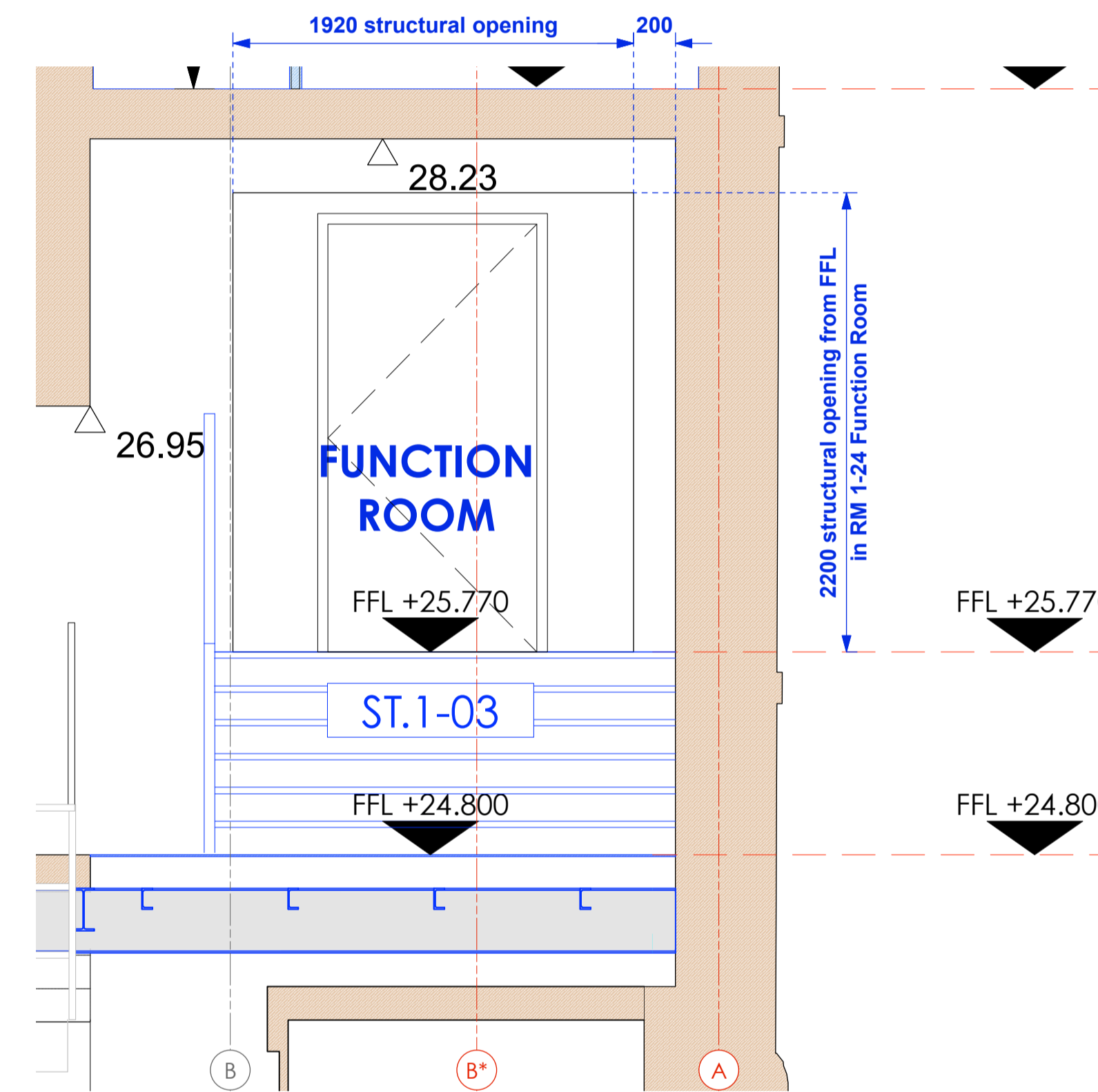

3 Demolition Detail 04.13 - Proposed Opening Elevation  
Scale: 1:25

Copyright: All rights reserved. This drawing must not be reproduced without permission.  
Only the original drawing should be relied upon. Contractors, subcontractors and suppliers must verify all dimensions on site before commencing any work or making any shop drawings.  
All shop drawings to be submitted to the architect for comment prior to fabrication.  
This drawing is to be read in conjunction with the Architect's specification, bills of quantities / schedules, structural, mechanical & electrical drawings and all discrepancies are to be reported to the architect.  
Do not scale from this drawing. Dimensions are in millimetres unless otherwise stated.

revision / date / amendments
CI / 18/12/19 / 1, First Issue

- LEGEND**
- Existing Building Fabric KOKO née Camden Palace Theatre (1900)
  - Existing Building Fabric Hope & Anchor (approx. 1850)
  - Existing Building Fabric Bayham Place (from 1875)
  - Existing Modern Building Fabric Bayham Place (from 2006)
  - PHASE 1 Building Fabric to be demolished
  - PHASE 1 Demolition of Flooring / Elevation / Wall
  - PHASE 1 Proposed Excavation
  - Area to be blocked up and made weather tight temporarily whilst KOKO is operational
  - PHASE 2 Proposed Demolition
  - PHASE 2 Demolition of Flooring / Elevation / Wall
  - PHASE 2 Proposed Excavation
  - PHASE 2 Retain + Relocate
  - Retain, protect + make good existing (ease + adjust)
  - Hope & Anchor Demise
  - Koko Demise
  - 1 Bayham Street & 65 Bayham Place Demise

18.12.19

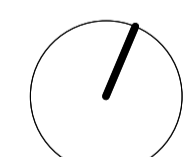

**CONSTRUCTION**

Archer Humphries Architects

Basement  
Central House  
142 Central Street  
London, United Kingdom  
EC1V 8AR  
T: +44 (0) 20 7251 8555

project title	
KOKO + Hope & Anchor + Bayham Place Camden, London	
drawing title	scale / date
1F Function Room Demolition Detail 04.13	1:100 (BA) / 18.12.19
drawing number	drawn / checked
AHA / KKC / DM / 04.13	FR / DA
revision	revision
	CI

**NOTE:**  
1. DRAWING TO BE READ INCONJUNCTION WITH MEP AND STRUCTURAL ENGINEER'S DETAILS.  
2. LISTED BUILDING FABRIC TO BE PHOTOGRAPHED PRIOR TO DEMOLITION UNDER LISTED BUILDING CONSENT CONDITION NO.5.  
3. REFER TO SCHEDULE OF WORKS AHA/KOKO/SOW/001, 002, 003 + 003A