

Copyright: All rights reserved. This drawing must not be reproduced without permission.

Only the original drawing should be relied upon. Contractors, subcontractors and suppliers must verify all dimensions on site before commencing any work or making any shop drawings.

All shop drawings to be submitted to the architect for comment prior to fabrication.

This drawing is to be read in conjunction with the Architect's specification, bills of quantities / schedules, structural, mechanical & electrical drawings and all discrepancies are to be reported to the architect.

revision / date / amendments

- / 26/01/18 / - First Issue
- A / 02/02/18 / - Indicative glazing bars and lites shown on Sky lobby roof.
- B / 01/03/18 / - Roof window numbers updated
- C / 01/08/18 / 4.8. Wall extended to rear of WC's by 1.5 bricks
4.9. Wall depth increased to include void for services
5.3. Existing chimney to rise above parapet
5.4. Chimney added from Pavillion
- D / 15/08/18 / Colour coding added to revised drawing RevC
- E / 03/08/19 / Proposed Dome LBC Application for
1. Permanent Dome Truss.
2. Dome Front Pier PFCs.
3. Replacement of Dome Copper Roof
- F / 11/02/2020 / Retrospective planning application for:
1. Removal and reinstatement at high level H/L
2. Removal and reinstatement at low level L/L
3. Removal and reinstatement of walls
4. Removal of walls.
5. Change to consented proposal.
Refer to colour coded legend and annotations 1-5.
- G / 22/06/2020 / Flue height lowered due to change to gas fireplace.
- H / 23/09/2021 / Condition 24 - Hard & Soft Landscaping denoted.
- I / 01/10/2021 / Condition 24 - Hard & Soft Landscaping denoted - Green Roof Details

LEGEND

- Proposed Works
- Existing Building Fabric KOKO née Camden Palace Theatre (1900)
- Existing Building Fabric Hope & Anchor (approx. 1850)
- Existing Building Fabric Bayham Place (from 1875)
- Existing Modern Building Fabric Bayham Place (from 2006)

■ RM.4-06 Room Number

■ D4-02 Door Number

■ W4-05 Window Number

01.10.2021

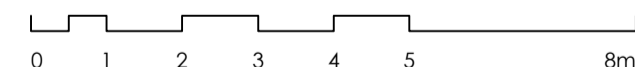
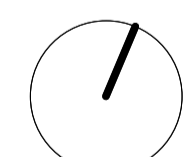

PLANNING

Archer Humphryes Architects

Basement
Central House
142 Central Street
London, United Kingdom
EC1V 8AR
T: +44 (0) 20 7251 8555

project title		
KOKO + Hope & Anchor + Bayham Place Camden, London		
drawing title	scale	date
Proposed Roof Plan	1:100 @ A1	26.05.17
drawing number	drawn	checked
AHA/KCC/GA/105	FR/PCI	DA
	revision	
	1	

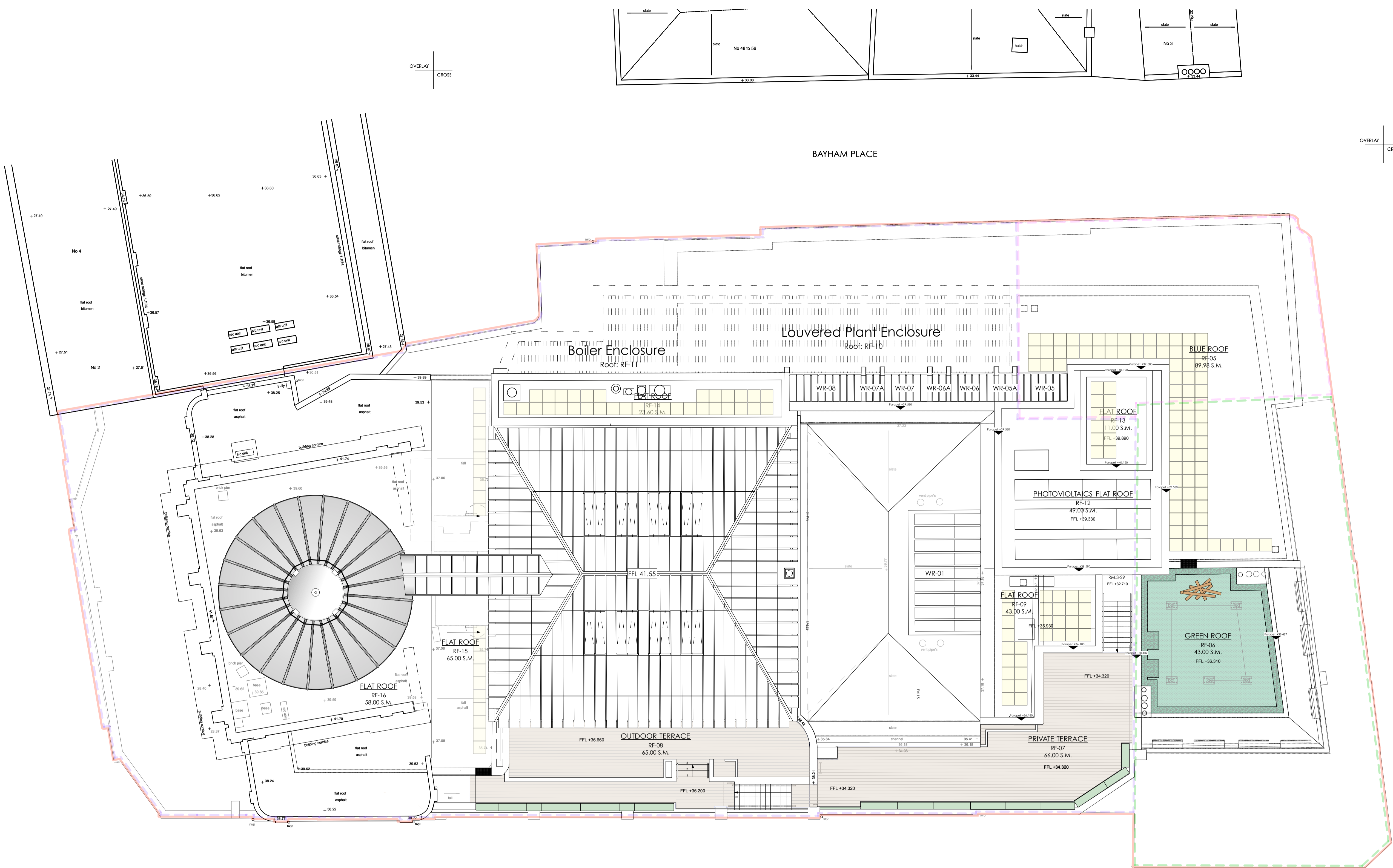

- Soft Landscaping - Green Roof - Bauder XF118 UK Native Species Wild Flower Blanket with grouped dead wood loggery (6 log)
- Soft Landscaping - Terrace Planter Screening - Ligustrum Vulgare 5L x 80-100cm high
- Hard Landscaping - 600 x 600mm Concrete Pavers on Pedestals
- Hard Landscaping - Timber Decking Planks

Condition 24 - Hard & Soft Landscaping - Roof Plan