

DISCLAIMER:
 DO NOT SCALE FROM THESE DRAWINGS. FOR ACCURACY ALL DIMENSIONS AND SPECIFICATIONS MUST BE CONFIRMED AT THE SITE AND WITH RELEVANT TECHNICAL DRAWINGS.
 TO BE READ IN CONJUNCTION WITH STRUCTURAL ENGINEER'S DRAWINGS AND SPECIFICATIONS.
 TO BE READ IN CONJUNCTION WITH SERVICE ENGINEER'S DRAWINGS AND SPECIFICATIONS.
 ANY DISCREPANCY BETWEEN DRAWINGS AND DIMENSION ON SITE ARE TO BE BROUGHT TO THE ATTENTION OF THE ARCHITECT PRIOR TO CONSTRUCTION.

2020 © CHARLES TASHIMA ARCHITECTURE. ALL RIGHTS RESERVED.
 NO INFORMATION OR DESIGN CONTAINED WITHIN THIS DOCUMENT SHOULD BE COPIED OR REPRODUCED WITHOUT THE CONSENT OF CHARLES TASHIMA ARCHITECTURE.

KEY
 — SITE BOUNDARY

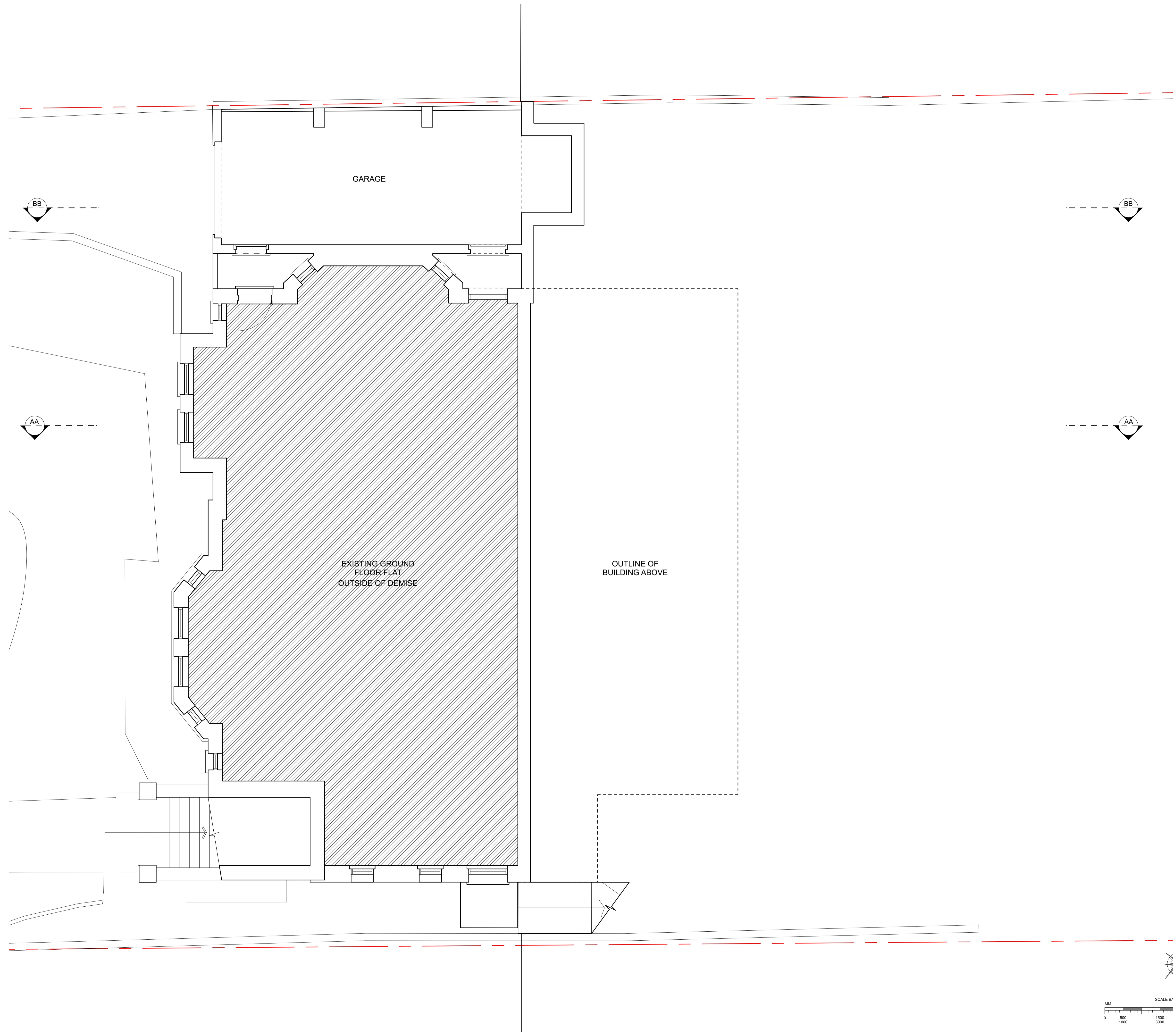

NOT FOR CONSTRUCTION

PLANNING

| | |
|--|-------------------------|
| PROJECT: 8 LINDFIELD GARDENS, LONDON, NW3 6PU | |
| PROJECT NUMBER: | 1115 |
| PROJECT STAGE: | PLANNING |
| ISSUE DATE: | 28. SEPTEMBER 2021 |
| SCALE: | 1:50 @ A1 1:100 @ A3 |
| DOCUMENT NUMBER: | 100 |
| REVISION: | 0 |

| | |
|---|--------------------------------|
| SUBJECT: EXISTING LOWER GROUND FLOOR PLAN | |
| CLIENT: | MARC LIXENBERG & SARAH HOWE |
| CHARLES TASHIMA ARCHITECTURE 12A Blackstock Mews London N4 2BT | |
| Landline: +44(0)20 7251 2351 Email: info@ct-arch.co.uk Website: www.ct-arch.co.uk | |

