

Proposed Basement Floor Plan

1:100

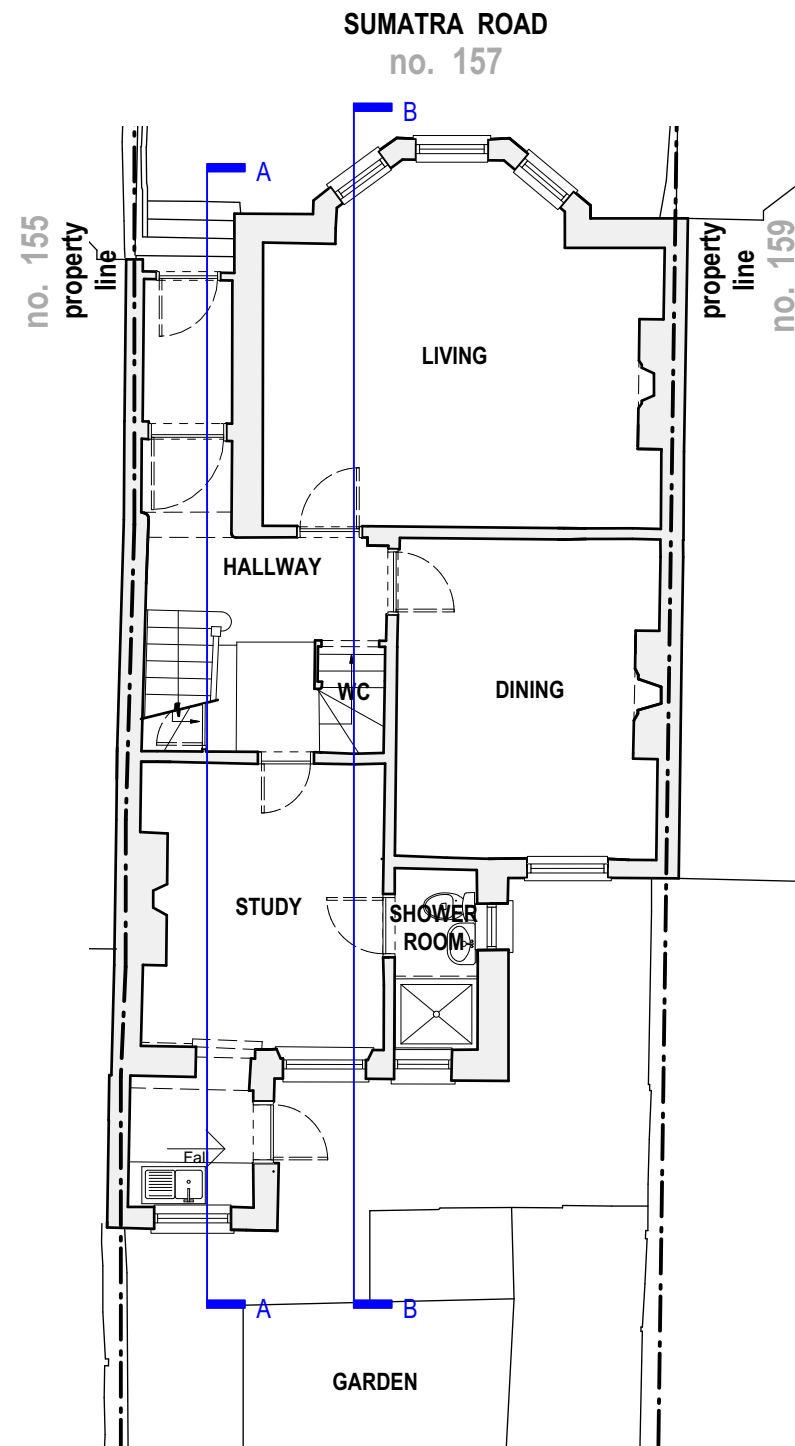

Proposed Ground Floor Plan

1:100

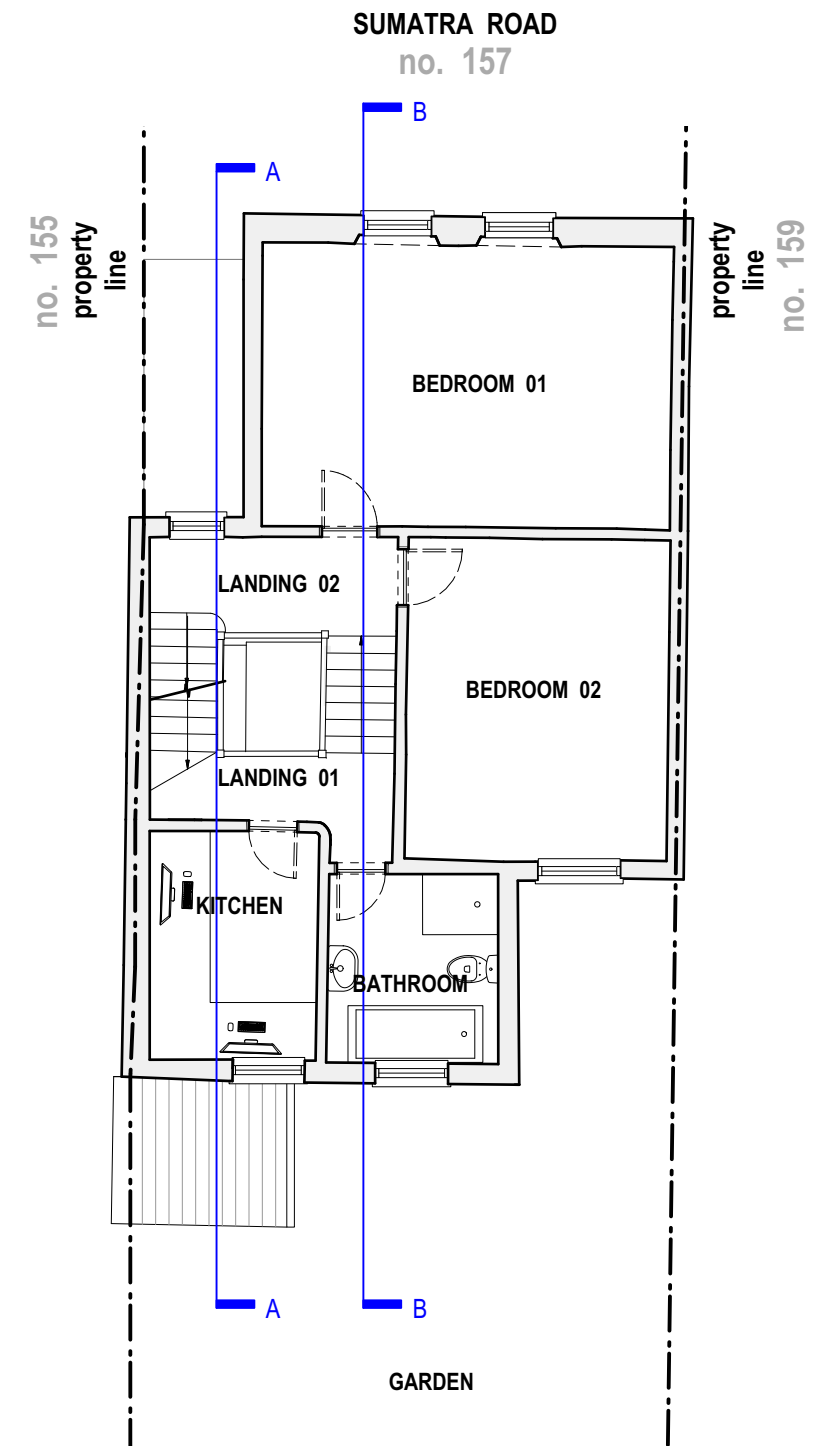

Proposed First Floor Plan

1:100

Key

- ① New L-shape dormer extension.

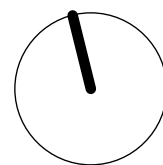

Rev:	Date:	Description:
00	07.05.2021	Issue for comment
01	15.05.2021	Issue for planning
02	26.10.2021	Rev Issue for planning to include scale bar and setback 200 mm from eaves

NOTES: Do not scale from this drawing. All dimensions in millimeters. All dimensions to be checked on site. All omissions and discrepancies to be reported to the architect immediately. This drawing is © betterPAD.

Project:	157 Sumatra Road NW6 1PN			
Dwg no:	2110 / PL.05			
Drawing:	Proposed Floor Plans B1, 00 & 01			
Date:	October 2021	C	D	Rev:
Scale:	1:100 @ A3	bP	bP	02

Planning

better PAD

love your home

W www.betterpad.co.uk
E hello@betterpad.co.uk