

**KEY NOTES**

- 101 NEW 2440MM TIMBER STUD PARTITIONS FINISHED IN PAINTED PLASTERBOARD.
- 102 NEW WALL MOUNTED MIRROR.
- 103 NEW FULL HEIGHT METAL DISPLAY FIXTURES SECURED TO WALL COMPLETE WITH WHITE OAK SHROUDS.
- 104 NEW FREESTANDING METAL STOCKROOM RACKING.
- 105 NEW MOVEABLE METAL STOCKROOM RACKING ON FLOOR MOUNTED GUIDES.
- 106 NEW ENGINEERED WHITE OAK TIMBER FLOORING.
- 107 NEW FLOOR MOUNTED TIMBER CASH DESK AND BACK WRAP.
- 108 NEW FIRE RATED TIMBER DOOR WITH PAINTED BEADBOARD CLADDING TO SALES AREA SIDE.
- 109 ALL WALLS TO BE DECORATED FARROW & BALL 'PINK GROUND' No.202. ALL CEILINGS TO BE DECORATED RAL 9016 WHITE.
- 110 NEW STEEL HANDROD FIXTURES SECURED TO WALL
- 111 NEW POWER OUTLET ELECTRICAL CABLE TO BE CHASED INTO WALL AND MADE GOOD.

Figured dimensions shall be taken in preference to scaled dimensions and any discrepancies or errors are to be referred to the Designer. Contractors, sub-contractors and suppliers must verify all dimensions on site before commencing work or making any fabrication drawings. © Copyright Reserved



For Office Use: A\_12494

*free people*

27 HAMPSTEAD HIGH STREET  
LONDON  
NW3 1QA

CONSULTANT :  
*free people*

DRAWN BY:  
LN

ISSUE / DATE:  
PLANNING 21.10.2021

REVISION :

SHEET TITLE :  
**PROPOSED BASEMENT  
AND GROUND FLOOR  
PLAN**  
SHEET NO. :

**PL001**

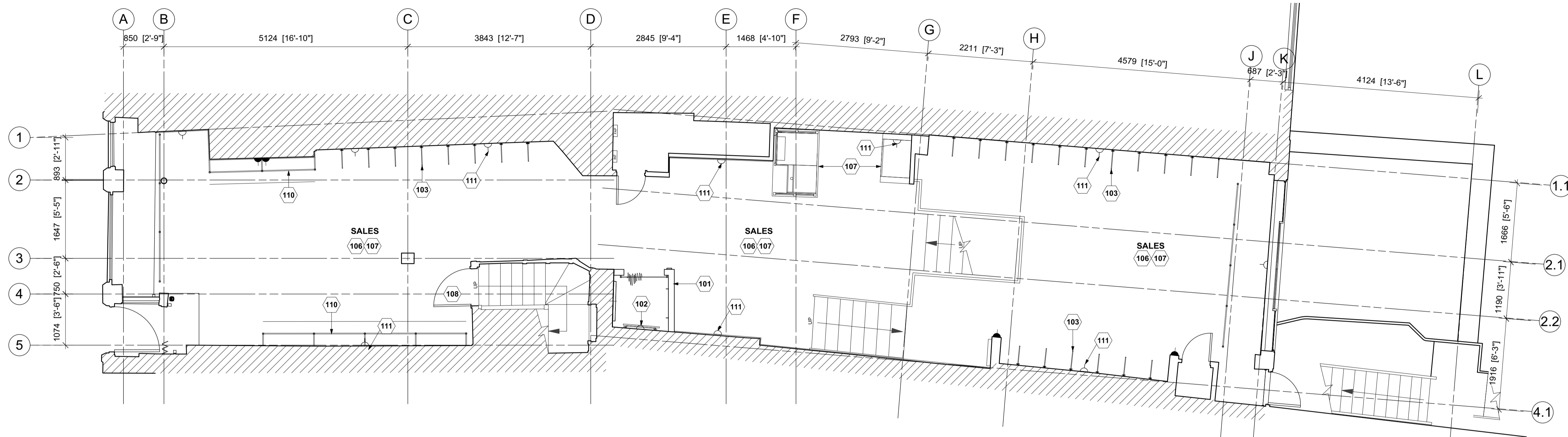

**2 GROUND FLOOR PLAN**

PL001 SCALE: @A1 1:50

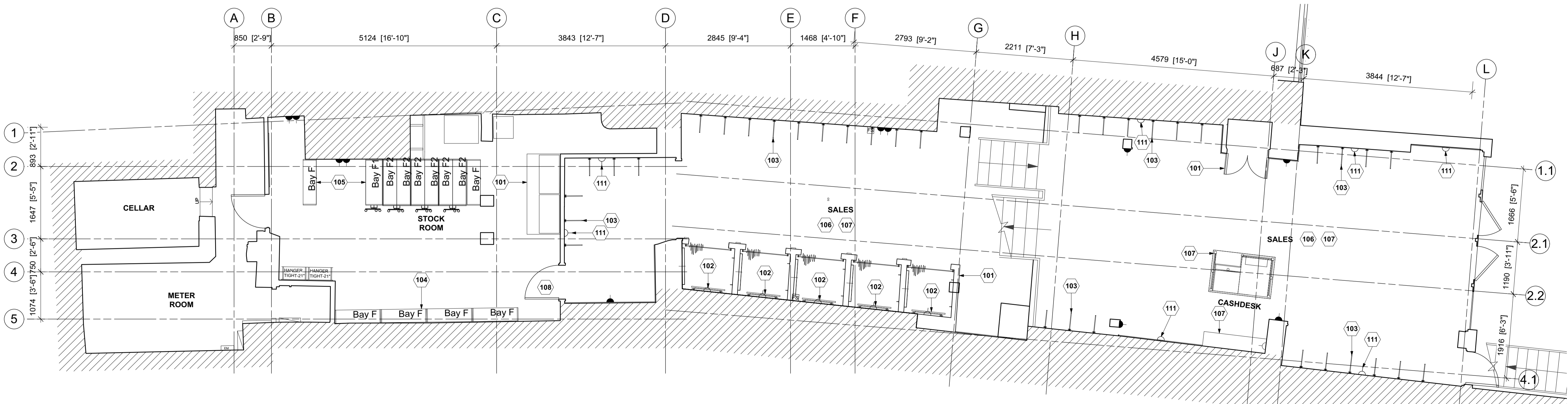

**1 BASEMENT FLOOR PLAN**

PL001 SCALE: @A1 1:50