

KEY NOTES

- 101 EXISTING PARTITION WALLS TO BE CAREFULLY REMOVED INCLUDING ASSOCIATED DOORSETS AND ADJACENT SURFACES MADE GOOD.
- 102 WALL MOUNTED DISPLAY FIXTURES TO BE CAREFULLY REMOVED AND ALL FIXINGS HOLES MADE GOOD.
- 103 WALL MOUNTED MIRRORS TO BE CAREFULLY REMOVED AND ALL FIXINGS HOLES MADE GOOD.
- 104 ALL STOCKROOM WALL MOUNTED SHELVING AND HANGARS TO BE CAREFULLY REMOVED AND ALL FIXINGS HOLES MADE GOOD.
- 105 FLOOR MOUNTED DISPLAY UNIT TO BE REMOVED.
- 106 ISOLATE, CUT BACK AND TERMINATE ASSOCIATED POWER/DATA PROVISION.
- 107 ALL EXISTING TIMBER FLOORING AND ASSOCIATED UNDERLAYS TO BE REMOVED.
- 108 EXISTING PARTITION WALLS TO BE CAREFULLY REMOVED AND ADJACENT SURFACES MADE GOOD.
- 109 EXISTING CASHDESK UNIT TO BE REMOVED . ISOLATE, CUT BACK AND TERMINATE ASSOCIATED POWER/DATA PROVISION.
- 110 STOREFRONT PLATFORM TO BE REMOVED AND ADJACENT SURFACES MADE GOOD.

Figured dimensions shall be taken in preference to scaled dimensions and any discrepancies or errors are to be referred to the Designer. Contractors, sub-contractors and suppliers must verify all dimensions on site before commencing work or making any fabrication drawings. © Copyright Reserved



For Office Use: A_12494

free people

27 HAMPSTEAD HIGH STREET
LONDON
NW3 1QA

CONSULTANT :
free people

DRAWN BY:
LN

ISSUE / DATE:
PLANNING 21.10.21

REVISION :

SHEET TITLE :
**DEMO BASEMENT
AND GROUND FLOOR
PLAN**
SHEET NO. :

D100

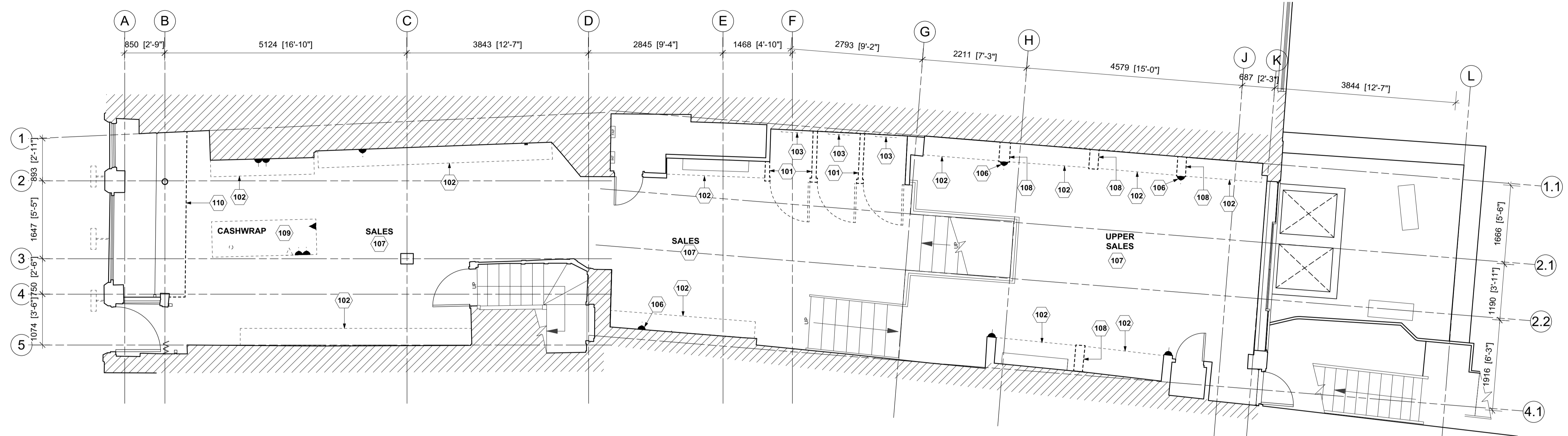

2 DEMO GROUND FLOOR PLAN
D100 SCALE: @A1 1:50

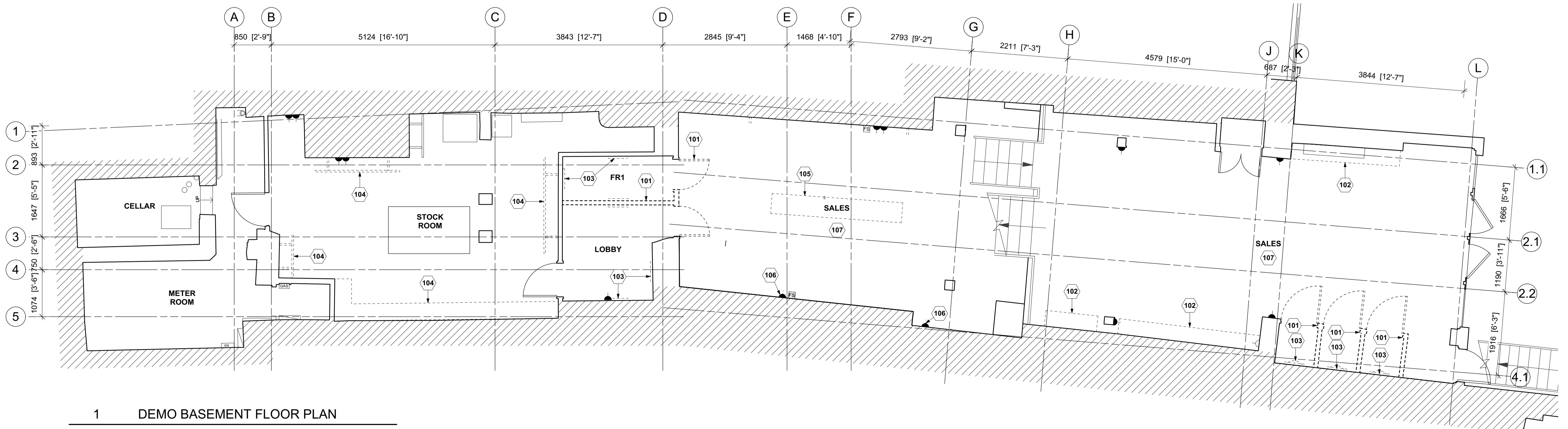

1 DEMO BASEMENT FLOOR PLAN
D100 SCALE: @A1 1:50