

Proposed Basement Floor Plan

1:100

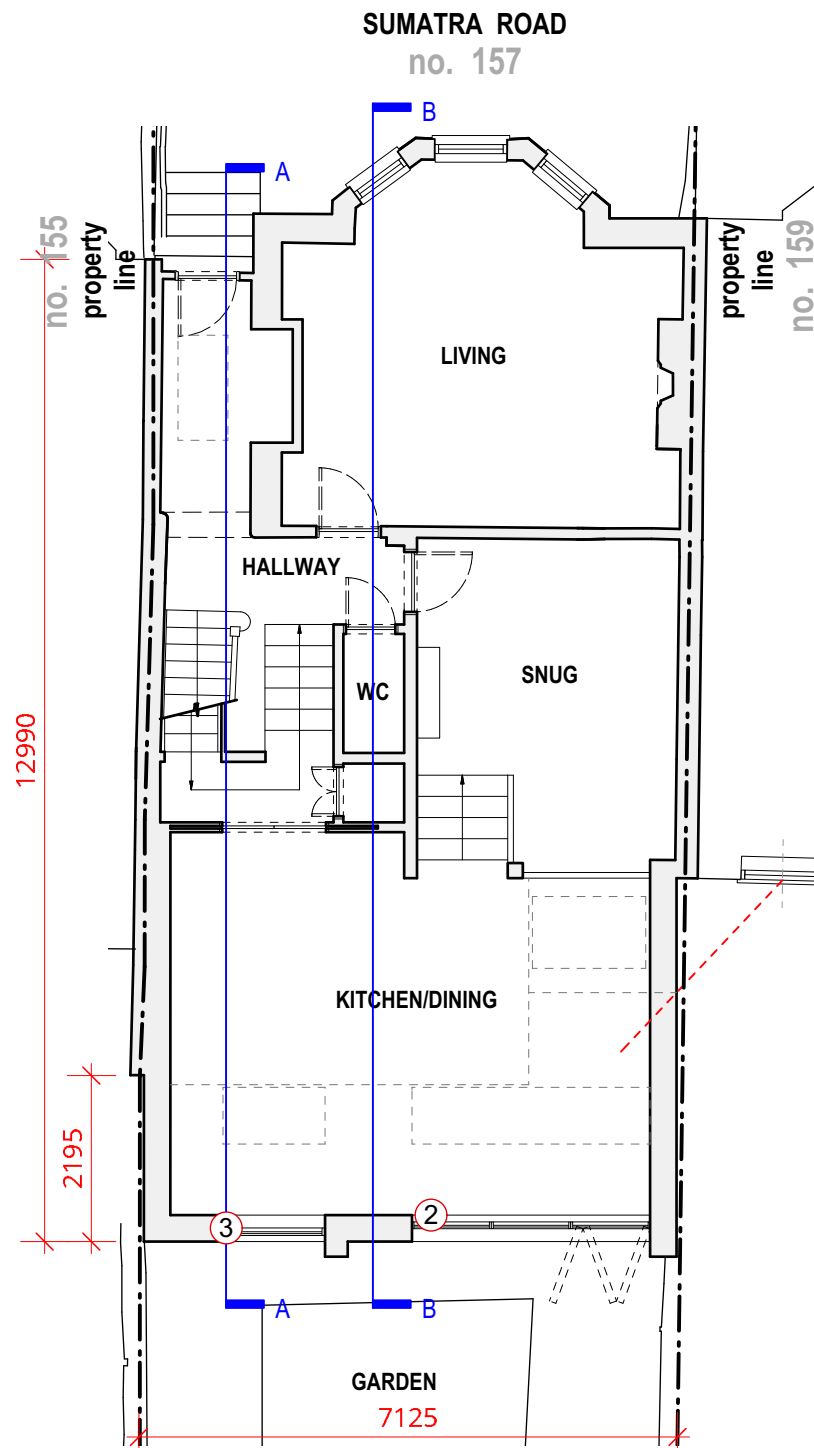

Proposed Ground Floor Plan

1:100

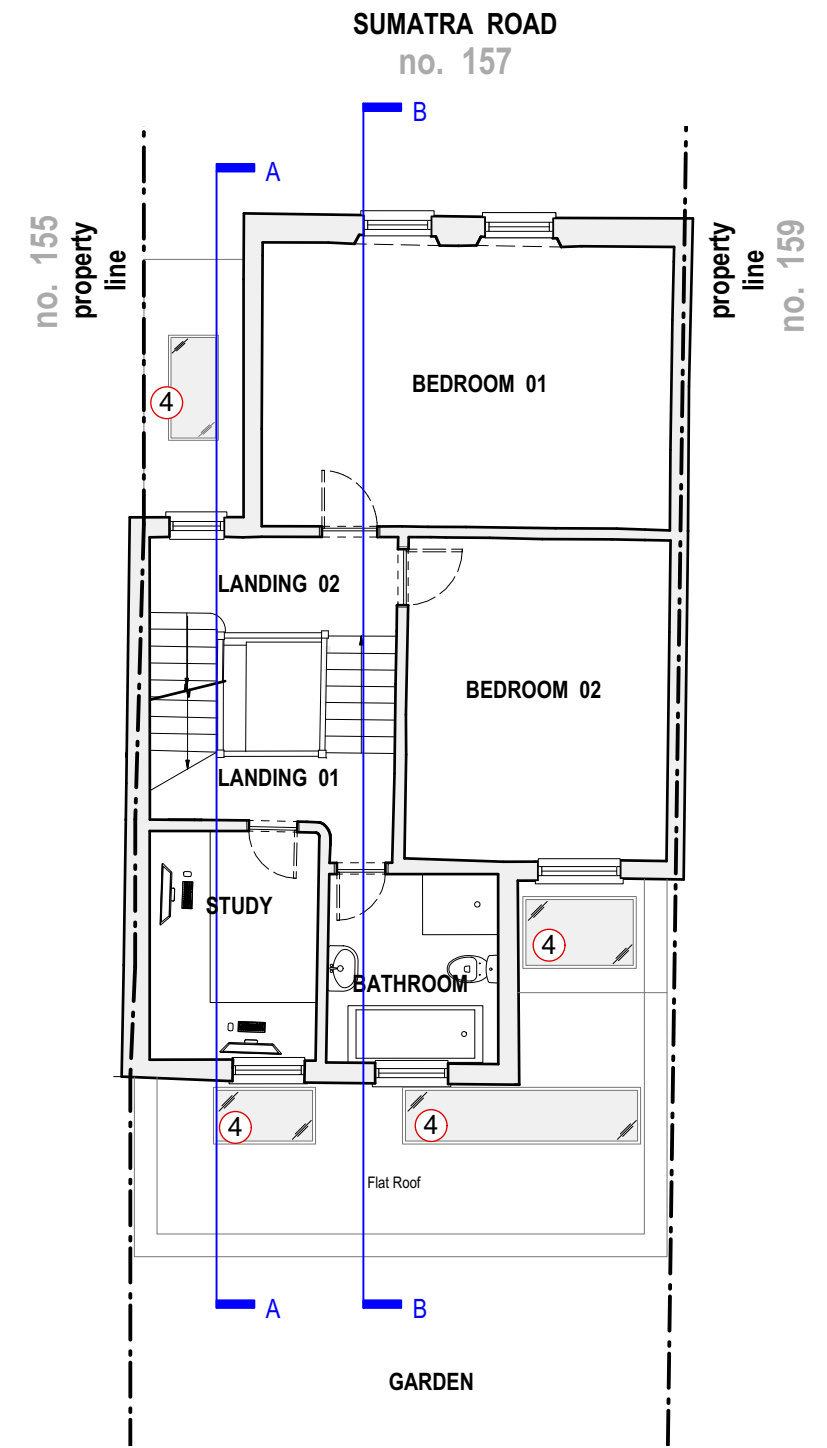

Proposed First Floor Plan

1:100

Key

- ① Dashed red line of 45 degrees, from midpoint of No. 159 ground floor window, in accordance of BRE daylight guidance.
- ② Dark metal framed bi-folding door.
- ③ Dark metal framed window.
- ④ Dark metal framed fixed rooflight / skylight.
- ⑤ Combination of dark and light brick.
- ⑥ New dormer window. with dark metal framed window

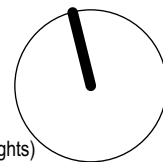

Rev:	Date:	Description:
00	07.05.2021	Issue for comment
01	12.05.2021	Issue for comment
02	15.05.2021	Issue for planning
03	13.10.2021	revised for planning (with dimensions)
04	14.10.2021	revised for planning (reduce front skylights)

NOTES: Do not scale from this drawing. All dimensions in millimeters. All dimensions to be checked on site. All omissions and discrepancies to be reported to the architect immediately. This drawing is © betterPAD.

Project:	157 Sumatra Road NW6 1PN			
Dwg no:	2110 / PL.05_Rev04			
Drawing:	Proposed Floor Plans B1, 00 & 01			
Date:	October 2021	C	D	Rev: 04
Scale:	1:100 @ A3	bP	bP	

Planning

better PAD
love your home

W www.betterpad.co.uk
E hello@betterpad.co.uk