

All penetrations in Illbruck membrane to be sealed in accordance with waterproofing specialist's details. Detail between window frame and membrane as per manufacturer's requirements

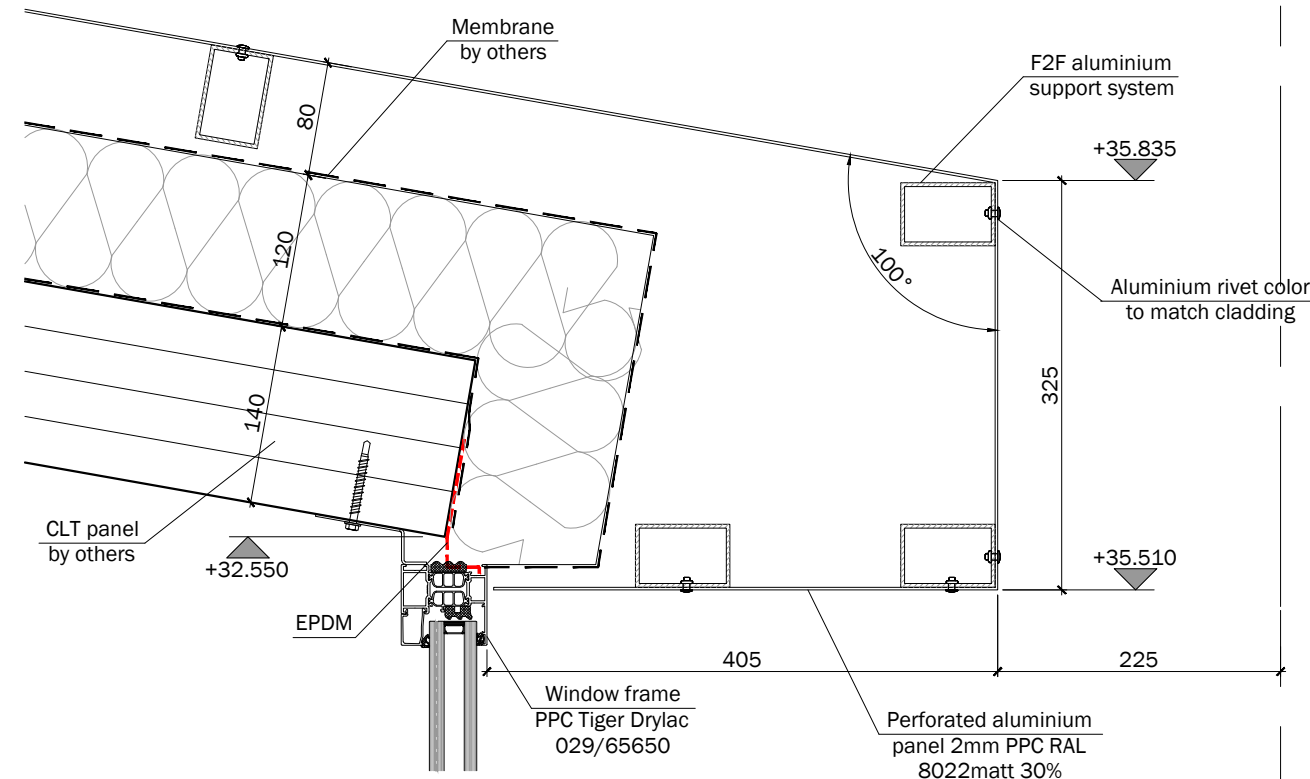

C02	General update	13.08.21	DB	JA	Project			
C01	Issued for construction	26.07.21	DB	JA	GREVILLE STREET			
P01	Issued for comments	24.05.21	DB	JA	Drawing			
Rev No	Revision note	Date	Drawn	Checked	Cladding detail 40			
Client					Drawn By		Status	
RED Construction Group Ltd					DB		For construction	
Drawn By					Scale		Date	
Dmitro Facades Unit 17, Dunstall Estate Leight Place, Welling Kent, DA16 3JH					1:5 A3		24.05.21	
					DWG No		POI	Rev
					GS-DFL-XX-00-DR-X-0040		A5	C02