

DETAIL 39

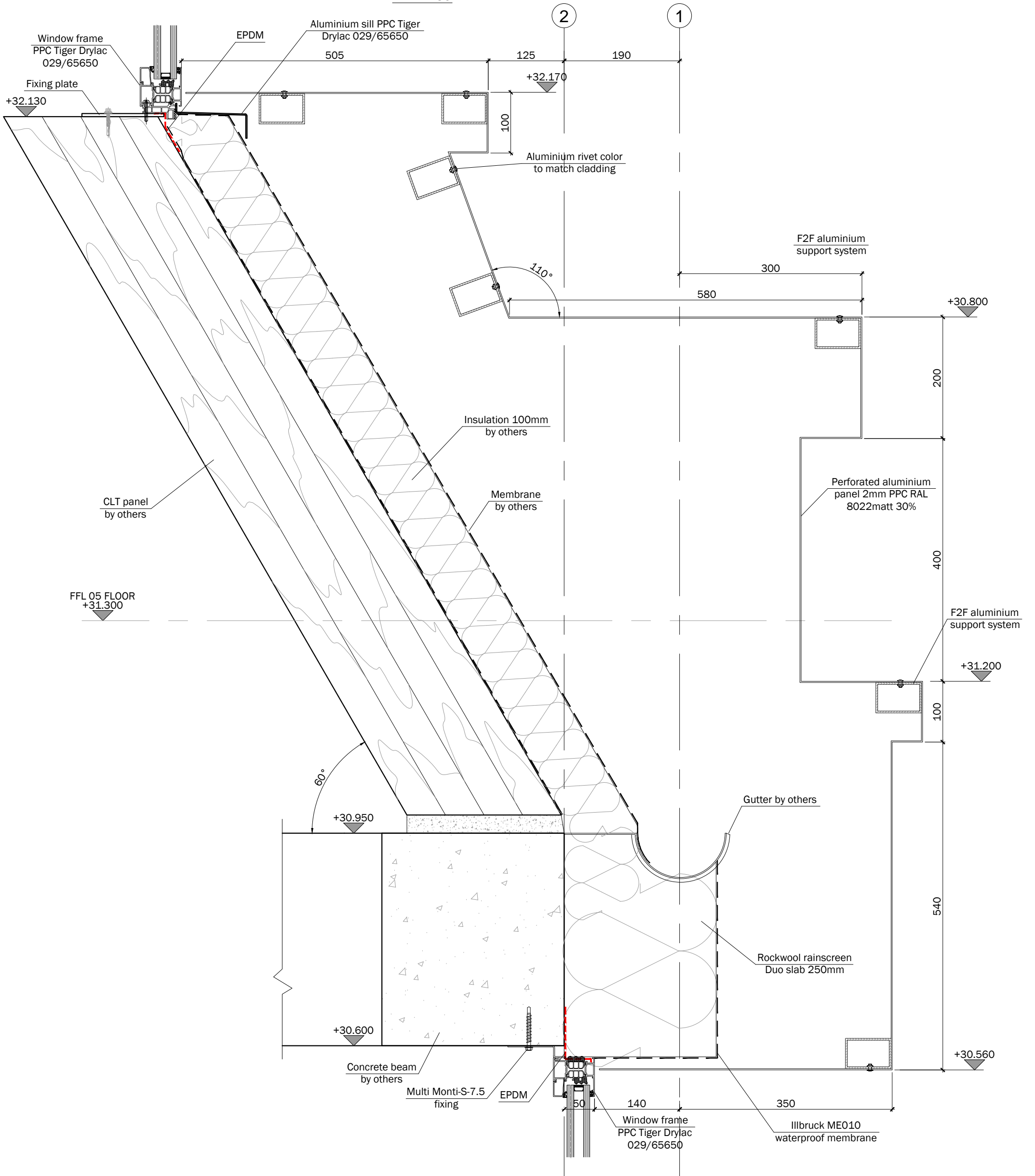

All penetrations in Illbruck membrane to be sealed in accordance with waterproofing specialist's details. Detail between window frame and membrane as per manufacturer's requirements

C02	General update	13.08.21	DB	JA	Project GREVILLE STREET	
C01	Issued for construction	26.07.21	DB	JA		
P01	Issued for comments	13.04.21	DB	JA		
Rev No	Revision note	Date	Drawn	Checked	Drawing Cladding detail 39	
Client	RED Construction Group Ltd				Drawn By DB	Status For construction
Drawn By	Dmitro Facades Unit 17, Dunstall Estate Leight Place, Welling Kent, DA16 3JH	Tel: 0207 254 4603 E-mail: office@dmitrofacades.co.uk		Scale 1:5 A3	Date 13.04.21	
DWG No	GS-DFL-XX-00-DR-X-0039	POI A5	Rev C02			