

- LEGEND
- EXISTING WALL
 - NEW 100mm STUD WALL
 - PORCELAIN FLOOR TILES WITH ELECTRIC UNDERFLOOR HEATING
 - CARPER FLOOR

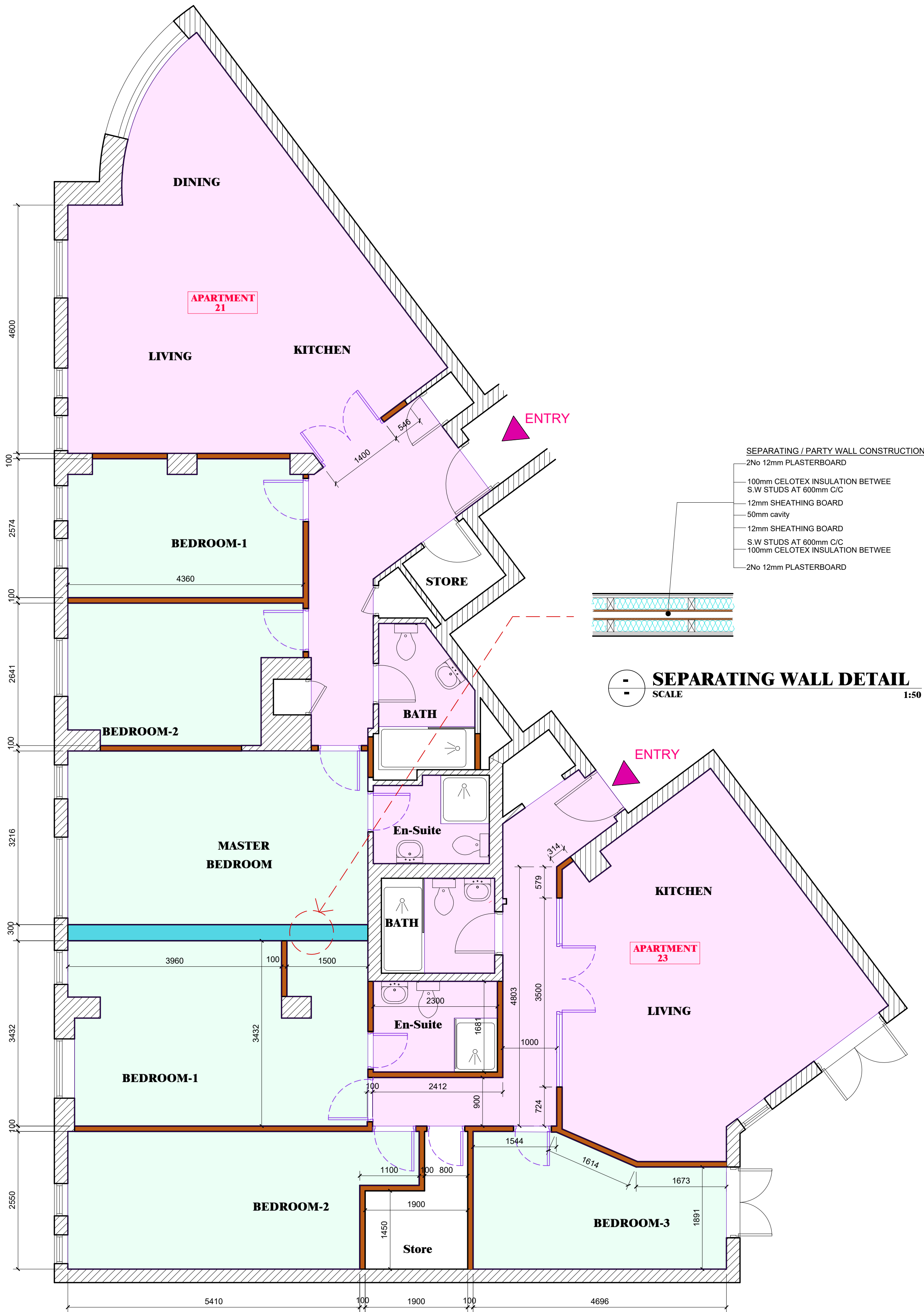

NOTES:

- ALL DIMENSIONS ARE IN MILLIMETERS AND ALL LEVELS IN METERS. DO NOT SCALE THE DRAWING.
- CONTRACTOR WILL BE ENTIRELY RESPONSIBLE FOR LAISON WITH APPROVED BUILDING CONTROL INSPECTOR
- LOCATION OF SERVICES SHOWN IN THIS DRAWING ARE INDICATIVE ONLY. CONTRACTOR IS TO SATISFY HIMSELF ABOUT THE ACCURACY AND SUFFICIENCY OF THIS INFORMATION. IDENTIFY LOCATION OF FOUL DRAINS, STORM DRAINS
- WIRING AND ALL OTHER ELECTRICAL WORKS TO BE CARRIED OUT BY FULLY QUALIFIED SPECIALIST TO EXPRESS APPROVAL OF THE ELECTRIC COMPANY AND IN ACCORDANCE WITH BUILDING REGULATIONS AND BYLAWS
- CONTRACTOR TO CHECK ALL DIMENSION ON SITE BEFORE PURCHASING THE MATERIALS
- KITCHEN TO BE VENTILATED BY EXTRACT FAN PROVIDING INTERMITTENT VENTILATION OF 60 L/S DISCHARGING TO EXTERNAL AIR INCORPORATED WITH COOKER HOOD AND 8000 SQ.MM BACKGROUND VENTILATION.
- EXTRACT FAN TO BE PROVIDED IN THE UTILITY PROVIDING INTERMITTENT VENTILATION OF 60 L/S DISCHARGING TO EXTERNAL AIR.
- ALL EN-SUITE TO BE MECHANICALLY VENTILATED WITH CEILING MOUNTED FAN PROVIDING INTERMITTENT VENTILATION OF 30/L/S DISCHARGING TO EXTERNAL AIR. DOORS TO EN-ENSUITE TO HAVE AN UNDER CUT OF 10mm.
- SMOKE DETECTORS TO BE INSTALLED IN ALL THE BEDROOMS AND CORRIDORS AND HEAT DETECTOR TO BE INSTALLED IN KITCHEN
- 2FT 6 INCHES WIDE DOORS AS STANDARD THROUGHOUT THE HOUSE FOR BEDROOMS AND BATHROOMS

NOTES:

All dimensions are to be checked and confirmed on site.

The contractor must check all dimensions on the drawing against those on the site before commencing any work. Mekkara Architectural Consultants will not be held liable for any discrepancies found on the drawing after the commencement of the work.



Client

Mr. Mike Pille & Priyanka Sharma

Job Title

**INTERNAL ALTERATIONS
FLAT No. 21 & 23
REGENT PLAZA APARTMENTS
LONDON, NW6 5HU**

Drawing Title

**WORKING DRAWING
PROPOSAL PLAN**

Scale

1:50 on A1

Date

AUG 2021

Drawn By

RMC

Job No	Drawing NO	Rev.
0721-81	131	-

© MEKKARA Architectural Consultants - THIS DRAWING AND DESIGN REMAINS THE COPYRIGHT AND INTELLECTUAL PROPERTY OF MEKKARA Architectural Consultants. SHALL NOT BE COPIED OR REPRODUCED IN ANY FORMAT WITHOUT APPROVAL.