



2 Proposed Vegetation

VEGETATION

The chosen mix is **Bauder Flora 5** a mix of species ideal for city environments. The plants chosen are able to absorb pollution and CO2 and give a suitable environment for insects and invertebrates. Details can be found in Green Roof - Annex 1.

British Native seed mixes

These mixes can be used as a mix on there own, or combined with Bauder British native plugs or other mixes to give a wider vegetation selection

Plug plants

The 'plugs' are varieties of sedums, grasses, herbs and perennials and are planted by hand to the required density.

Wildflower blanket

Vegetation blanket which contains a broad mix of British Wildflowers grown in substrate on a coir carrier.

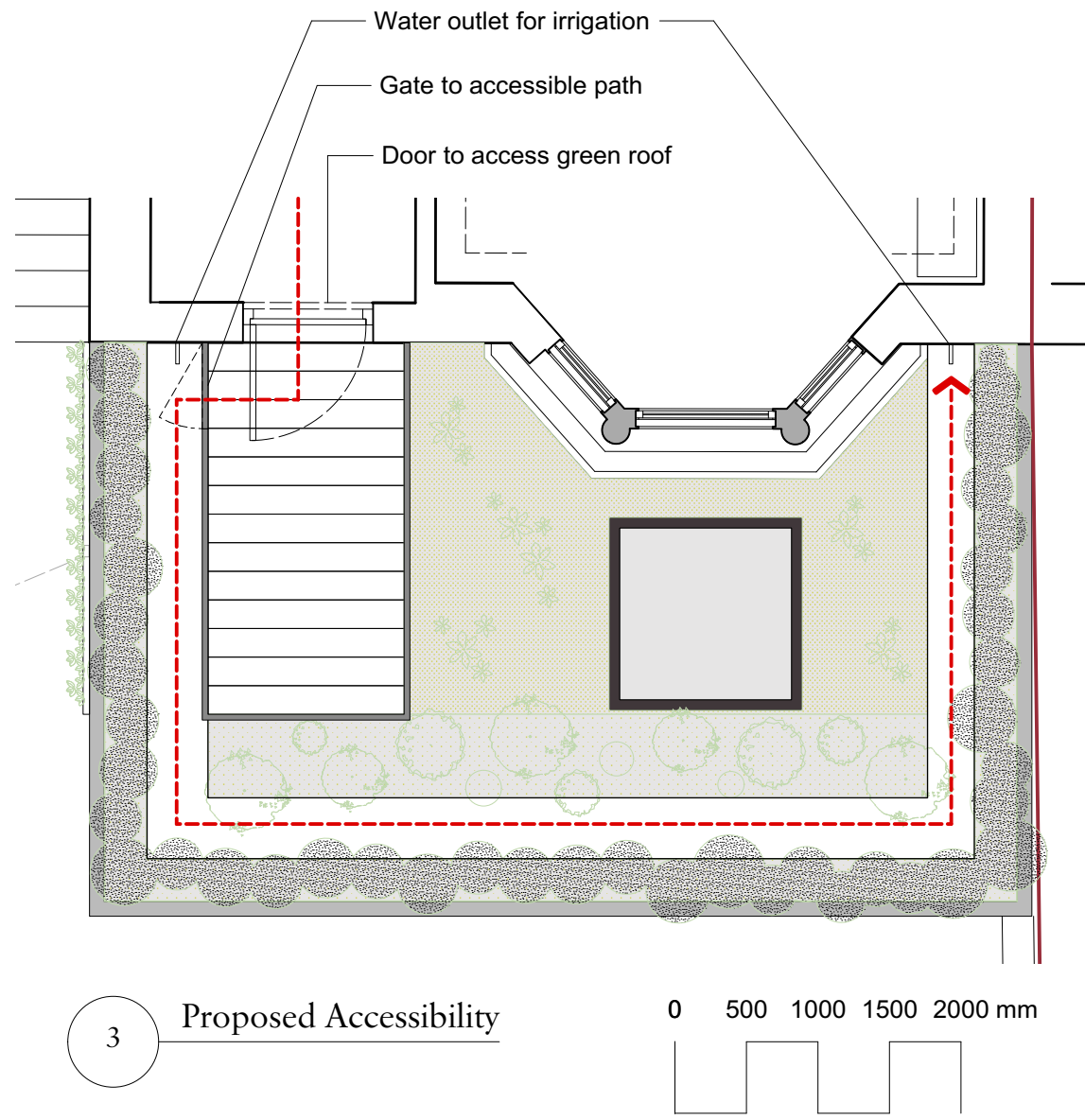

3 Proposed Accessibility

ACCESSIBILITY & MAINTENANCE

The Bauder biodiversity green roofs which are being installed to meet either BREEAM or Sustainable Homes codes will include a species mix selected to provide a balanced plant community on the roof and will require basic maintenance if this is to be sustained in the long term.

Maintenance is best carried out **annually**, during **springtime** and additionally in **late autumn** should the particular roof location be affected by local trees that produce surface leaf litter.

Some deposited leaf litter may be considered as contributory to the bio-diverse environment, which is acceptable so long as provision is made to ensure that this has no negative effect on other plants and the roof drainage performance.

Procedures details can be found in Green Roof - Annex 2.

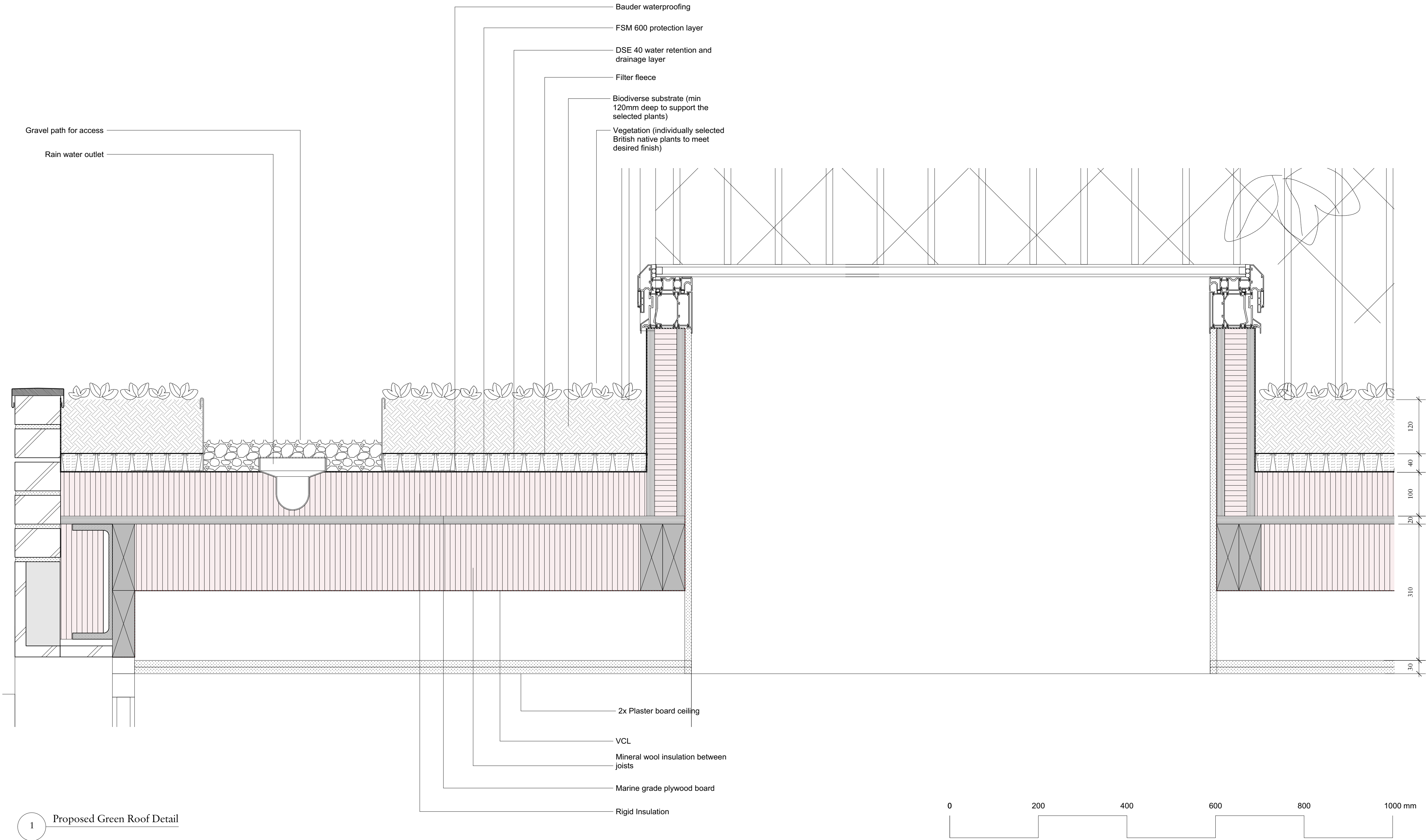

1 Proposed Green Roof Detail

Rev Date Details By

Charlton Brown
Architecture & Interiors

The Belvedere, 2 Back Lane, Hampstead, London, NW3 1HL
Telephone +44(0)20 7794 1234
Email office@charltonbrown.com
Website www.charltonbrown.com

Client

Project
106 South Hill Park

Drawing Title
Green Roof Details

Date 20.03.20 Drawn ML Checked CP

Scale
1:10@A3 / 1:5@A1

Issue Status
PLANNING

Project Number 1918 Drawing Number D-01-Green Roof Revision