

Copyright in the design and this drawing is the property of RESI.
 Reproduction in whole or in part is forbidden without written sanction of RESI.
 All dimensions to be cross-checked on site prior to completing a Planning, structural engineering, the party wall process and construction.
 Print to scale (as actual size)

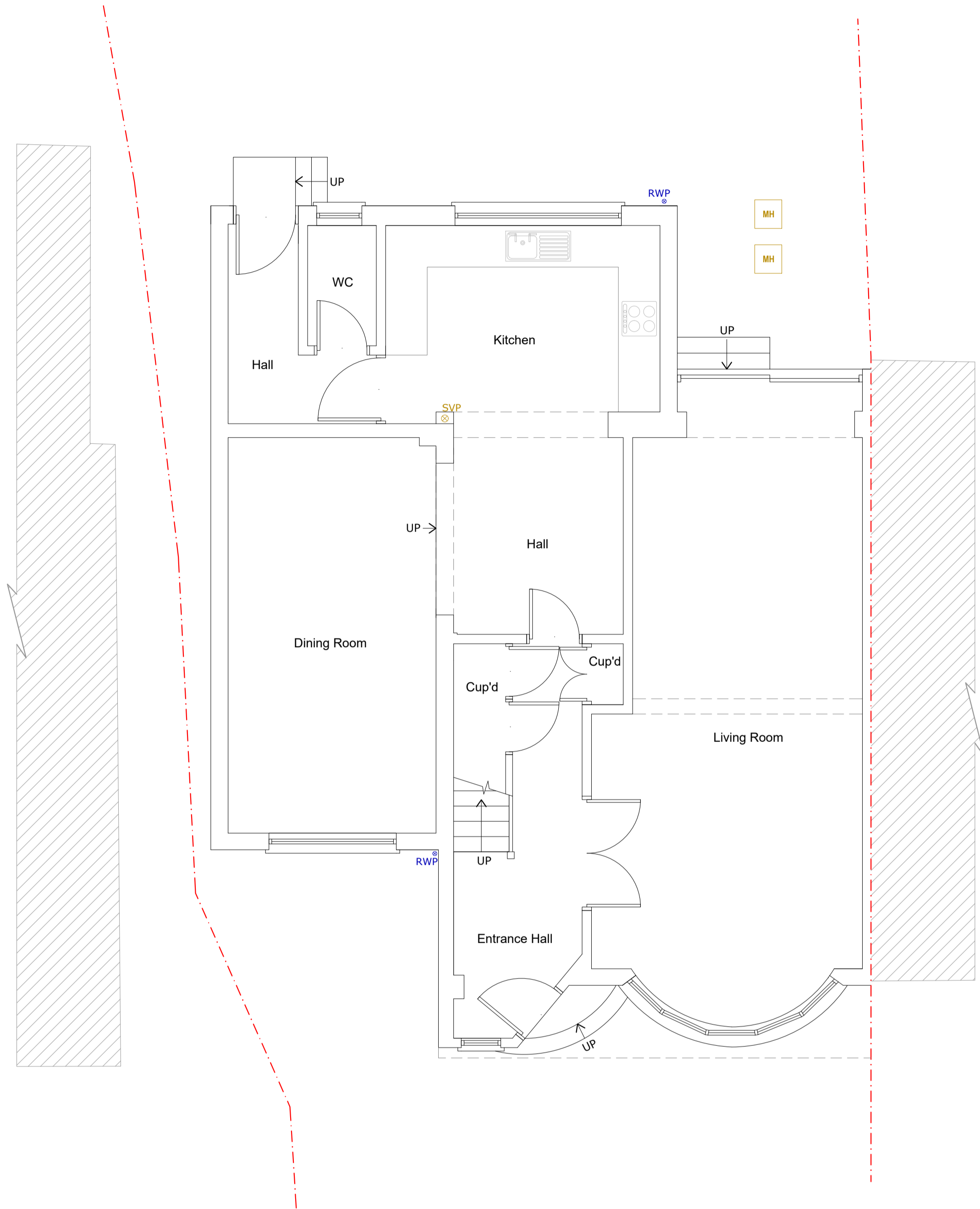



NOTES





Existing Ground Floor Plan

Existing ground floor area ca. 88.22 m²

DRAINAGE KEYS

	RWP	Rainwater downpipe
	SVP	Soil vent pipe
		Flow direction
		Sewer pipes

GENERAL KEYS

	Boundary line
	Existing walls

REV	DESCRIPTION	DRN	CHK
PP6	PLANNING DRAWINGS	OM 08.08.2021	FD 08.08.2021
BR3	BUILDING REGULATIONS	DK 22.09.2021	FD 22.09.2021



Job Title
 Internal alteration
 139 Broomfield Avenue,
 N13 4JR

Drawing Status
 Building Regulations

Client
 Jo Georgiou

Drawing Title
 Existing Ground Floor Plan

Scale 1/50 @ A2, 1/100 @ A4	Drawn DK
Date September 2021	Checked FD

Drawing No.
 21-1609 - 02