

Disclaimer and Notes
 Do not scale this drawing. All dimensions should be checked on site. Any discrepancy found between this drawing, site and any other document should be referred immediately to Fresson and Tee. All drawings should be read in conjunction with all other contract documents and specifications and all other consultants drawings.
 Copying or reproduction of this drawing without the written permission of Fresson and Tee is not permitted. Copyright is Reserved.
 The PDF hard copy accompanying the CAD data is legal transmission of information. The electronic copies are issued only for convenience of use and record of original file. No liability for the accuracy or for any consequence resulting from the use, additions or alteration of information is accepted by Fresson and Tee.
 Title plan at 1:1250 and North point is up

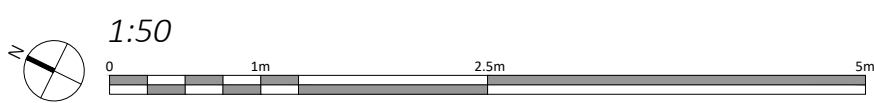
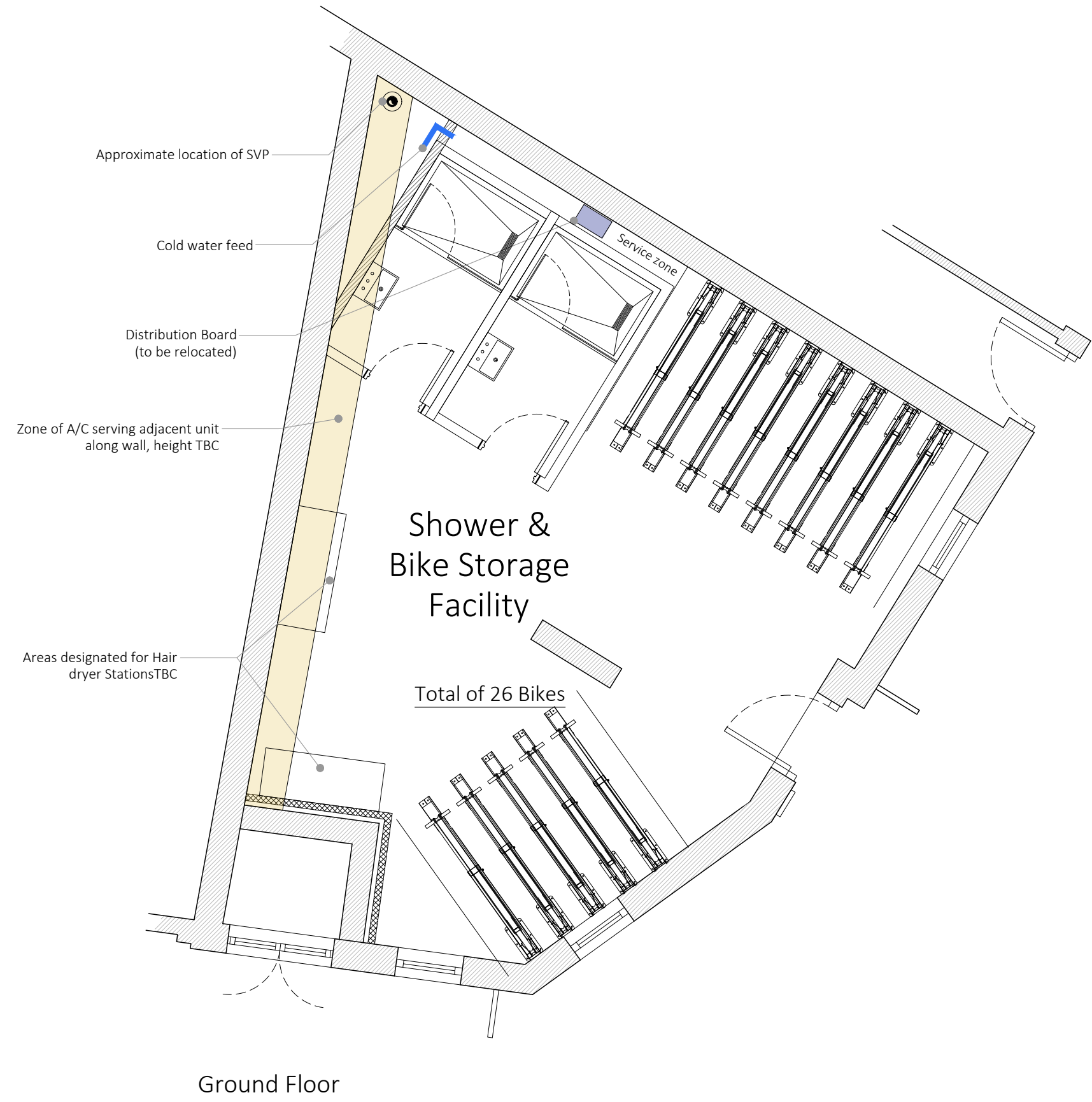

Rev Iss.	Description	Date
P1 XX	Initial Issue	27.07.2021

DRAWING TITLE
**Ground Floor Plan
 As Proposed Indicative Layout**

PROJECT NAME
 Cycle Storage Facility

ADDRESS
 1 Fielding Court
 London WC2

CLIENT
 Shaftesbury Covent Garden Ltd

DRAWN BY
 DMV

CHECKED BY
 NP

JOB NO.
 25042

Queen's House / 55-56 Lincoln's Inn Fields / LONDON WC2A 3JF
 020 7391 7200 | www.fandt.com

SCALE
 1:50@A3

DATE
 Jul 2021

DRAWING NO.
 A-200-P1

