

GROUND FLOOR PLAN 1:500 scale

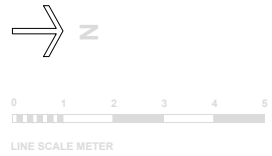

Key

- Fire Escape
- Bike Platform

notes

Works are subject to be Building Control approval

Works are subject to Local Authority planning approval.

All works to be in accordance with the structural and M&E design.

Fire alarm sounder extended to bike area.

Fire signage installed to comply.

New emergency lighting and circuit installed to comply.

New feature daylight lighting to underside of new platform.

Move AC pipes that infringe new route.

Move any services as required.

Stone cladding removed for fixing of platform to building structure as structural design - close up by boxing out with non combustible rock wall batt and metal cladding finishing panel.

Fire and weather stop all existing holes.

Earth all metal components as required.

All metal products to be non ferrous and suitable earthed in accordance with the M&E design.

New windows as required to be 30 minute fire rated

Bike racks fixed to wall 300mm minimum above new deck.

The contractor is responsible for the final design and installation.

Rev.	Date	Description
A	26/07/21	Addition of bike lockers & horizontal rack, reduction in vertical wall rack

Note:
These drawings should be approved by the Local Authority.
No dimensions are to be taken from these drawings, check all dimensions on site.
This drawing is subject to copyright and should not be reproduced without the permission of Axiom Solutions Ltd.

Property / Job
Audrey House, 16-20 Ely Place London, EC1N 6SN

Floor / Location
GROUND FLOOR
PLANNING

Drawing reference
EXISTING & PROPOSED

Scale: 1:150 @ A3 Date: 26/04/21

Axiom Solutions Limited
www.axiomsolutionsltd.com



Dwg No. AH127 / 002 EX PR Revision: A

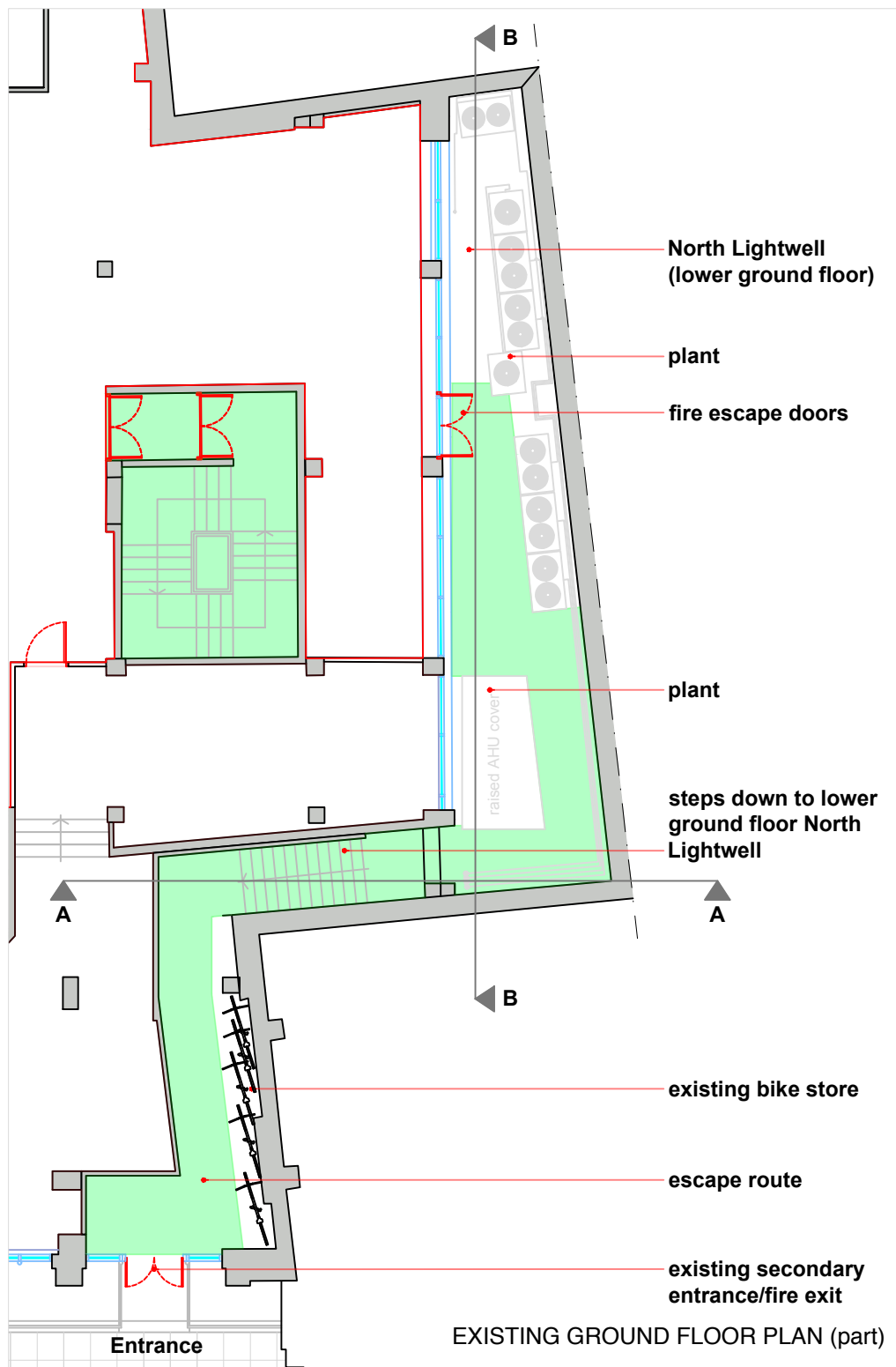

EXISTING GROUND FLOOR PLAN (part)



PROPOSED GROUND FLOOR PLAN (part)