

**Proposed Section CC**

1:100

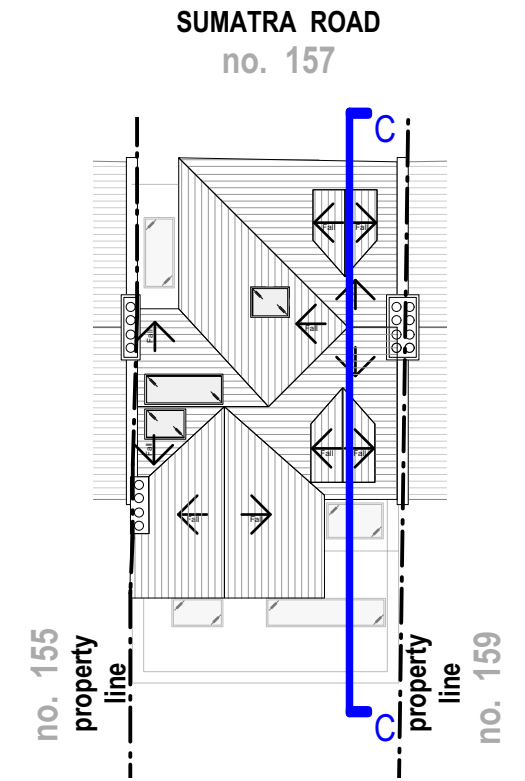

**Proposed Roof Plan**

1:200

**Key**

- ① Dashed red line of 45 degrees, from midpoint of No. 159 ground floor window, in accordance of BRE daylight guidance.
- ② Dark metal framed bi-folding door.
- ③ Dark metal framed window.
- ④ Dark metal framed fixed rooflight / skylight.
- ⑤ Combination of dark and light brick.
- ⑥ New dormer window. with dark metal framed window

Rev: 00 Date: 07.09.2021 Description: Issue for planning	Project: <b>157 Sumatra Road NW6 1PN</b> Dwg no: <b>2110 / PL.09</b> Drawing: <b>Proposed Section CC CC</b>	<h1 style="margin: 0;">Planning</h1> <h2 style="margin: 0;">better PAD</h2> <p style="margin: 0;">love your home</p>						
<b>NOTES:</b> Do not scale from this drawing. All dimensions in millimeters. All dimensions to be checked on site. All omissions and discrepancies to be reported to the architect immediately. This drawing is © betterPAD.	Date: September 2021 Scale: as shown @ A3	<table style="width: 100%; border-collapse: collapse;"> <tr> <td style="border: 1px solid black; text-align: center;">C</td> <td style="border: 1px solid black; text-align: center;">bP</td> <td style="border: 1px solid black; text-align: center;">D</td> <td style="border: 1px solid black; text-align: center;">bP</td> <td style="border: 1px solid black; text-align: center;">Rev:</td> <td style="border: 1px solid black; text-align: center;">00</td> </tr> </table>	C	bP	D	bP	Rev:	00
C	bP	D	bP	Rev:	00			
W www.betterpad.co.uk E hello@betterpad.co.uk								