

- Notes:
1. This is an A1 drawing, if reproduced in any other format the scale shown will be incorrect.
  2. Do not scale off this drawing.
  3. Any ambiguities, omissions and errors, or inconsistencies with other documents, on this drawing should be notified immediately to the architect before the commencement of works on site.
  4. All dimensions are in millimeters unless otherwise stated.
  5. All dimensions, unless otherwise stated, are to the face of unfinished masonry walls or to the face of stud partitions, excluding plasterboard.
  6. All dimensions are to be checked on site. any discrepancies are to be notified immediately to the architect before the commencement of works on site.
  7. All levels are in meters unless otherwise stated.
  8. This drawing is to be read in conjunction with all other relevant drawings and specifications for this project and apparent inconsistencies brought to the attention of the architect.
  9. It is the responsibility of specialist roofing/wall cladding/insulation manufacturer to ensure full compliance with their composite build up as specified by them, and that the integration of their product into the building design meets the required fire tests and complies with Building Regulations.

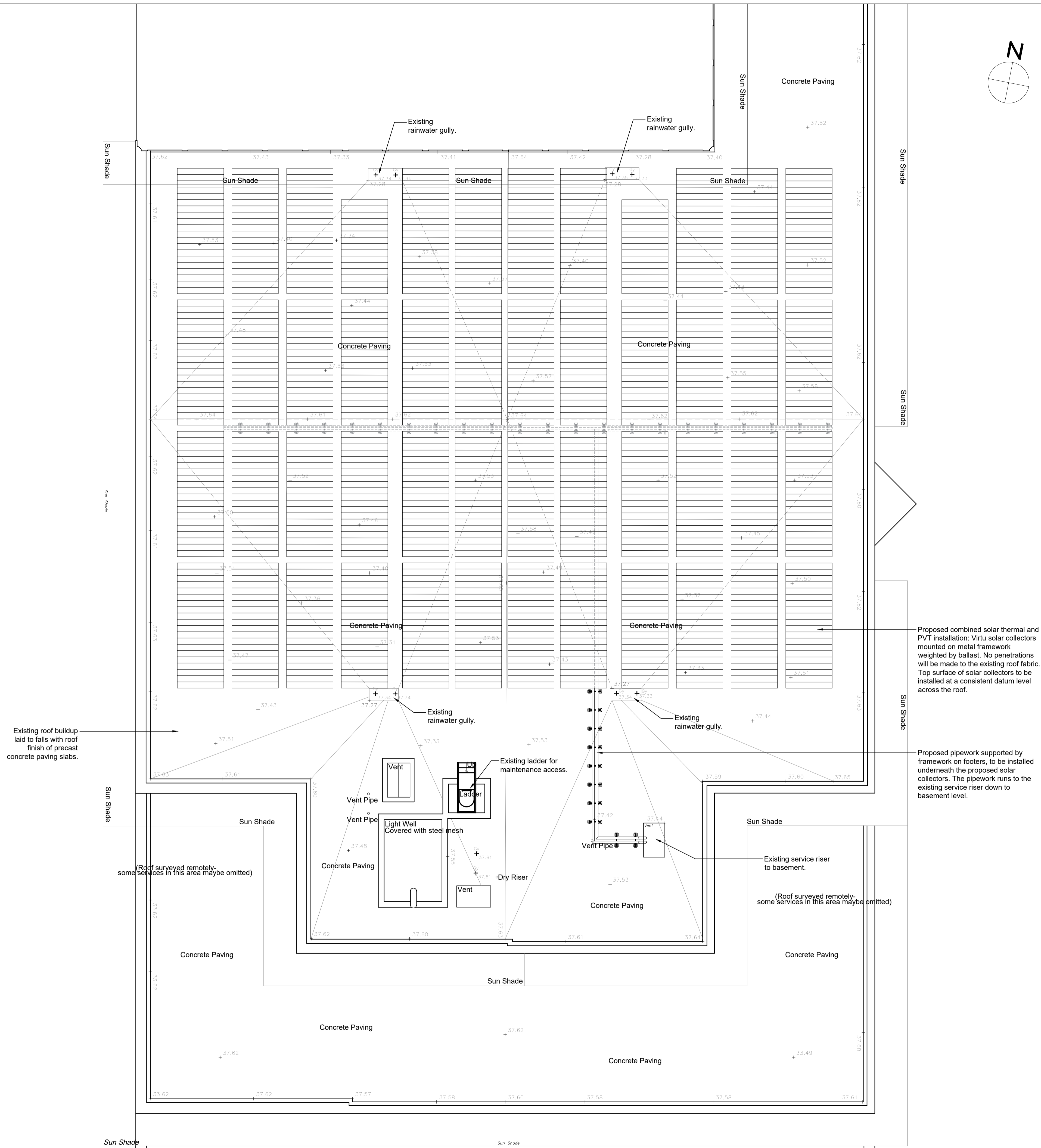

Proposed combined solar thermal and PVT installation: Virtu solar collectors mounted on metal framework weighted by ballast. No penetrations will be made to the existing roof fabric. Top surface of solar collectors to be installed at a consistent datum level across the roof.

Proposed pipework supported by framework on footers, to be installed underneath the proposed solar collectors. The pipework runs to the existing service riser down to basement level.

Existing roof buildup laid to falls with roof finish of precast concrete paving slabs.

(Roof surveyed remotely, some services in this area maybe omitted)

(Roof surveyed remotely, some services in this area maybe omitted)

Rev	Date	Description	By	Ck	Ap
P01	10.08.21	First issue.			AC CP CP

**cbp.**

T: 0115 948 1144  
 www.cbp-arch.co.uk  
 44 The Ropewalk, Nottingham, NG1 5DW

Project  
**The British Library  
 Combined Solar Thermal and PVT  
 Installation**

Drawing title  
**Proposed Level 4 Roof Plan**

Drawn by	Checked by	Approved by	Scale	Date	RIBA Stage
AC	CP	CP	1:100	10.08.21	3

Project Originator Volume Level Type Role Number Suitability Revision  
 21027 -CBP-XX - 04 -DR-A-3400-S1 -P01  
 Reproduced subject to copyright Original sheet size A1