

GREEN ROOF SPECIFICATION

Sedum blanket extensive green roof system, by Bauder or a similar supplier:

- Lightweight system
- A mix of hardy sedum with 10–15 species with a range of both sun loving and shade tolerant species so that the species suited to the environment will thrive. Sedum to include some species that flower in spring to support pollinators.
- Quick and easy install with instant greening
- Low maintenance system

TYPICAL DETAIL

(not to scale)

Sedum planting as per sedum supplier's recommendations, on:
 30–40mm sedum turf roll/blanket
 80mm growing medium;
 filter fleece;
 20mm sedum supply roof drain system;
 protection layer;
 single ply or GRP membrane roofing to supplier's details;
 18mm marine grade plywood

Proposed flat roof

MAINTENANCE

- Annually keeping edges tidy and gutters clear
- Annually patching to prevent excessive die back as required
- Annually weeding

ALL WORKS TO BE IN ACCORDANCE WITH
CURRENT BUILDING REGULATIONS AND TO BE
READ AND CONSTRUCTED IN CONJUNCTION
WITH A SCHEDULE OF WORKS DOCUMENT
AND STRUCTURAL ENGINEER'S INFORMATION

ALL DIMENSIONS, EXISTING LEVELS, DRAIN RUNS
AND SITE CONDITIONS TO BE VERIFIED ON SITE BY
CONTRACTOR PRIOR TO CONSTRUCTION, AND
ANY DISCREPANCIES MADE KNOWN

DRAWINGS ARE FOR PLANNING PURPOSES ONLY
AND ARE NOT ISSUED FOR CONSTRUCTION

Sedum planting as per sedum supplier's recommendations, on:
 30-40mm sedum turf roll/blanket
 80mm growing medium;
 filter fleece;
 20mm sedum supply roof drain system;
 protection layer;
 single ply or GFR membrane roofing to supplier's details;
 18mm marine grade plywood

Proposed flat roof

- Annually keeping edges tidy and gutters clear
- Annually patching to prevent excessive die back as required
- Annually weeding

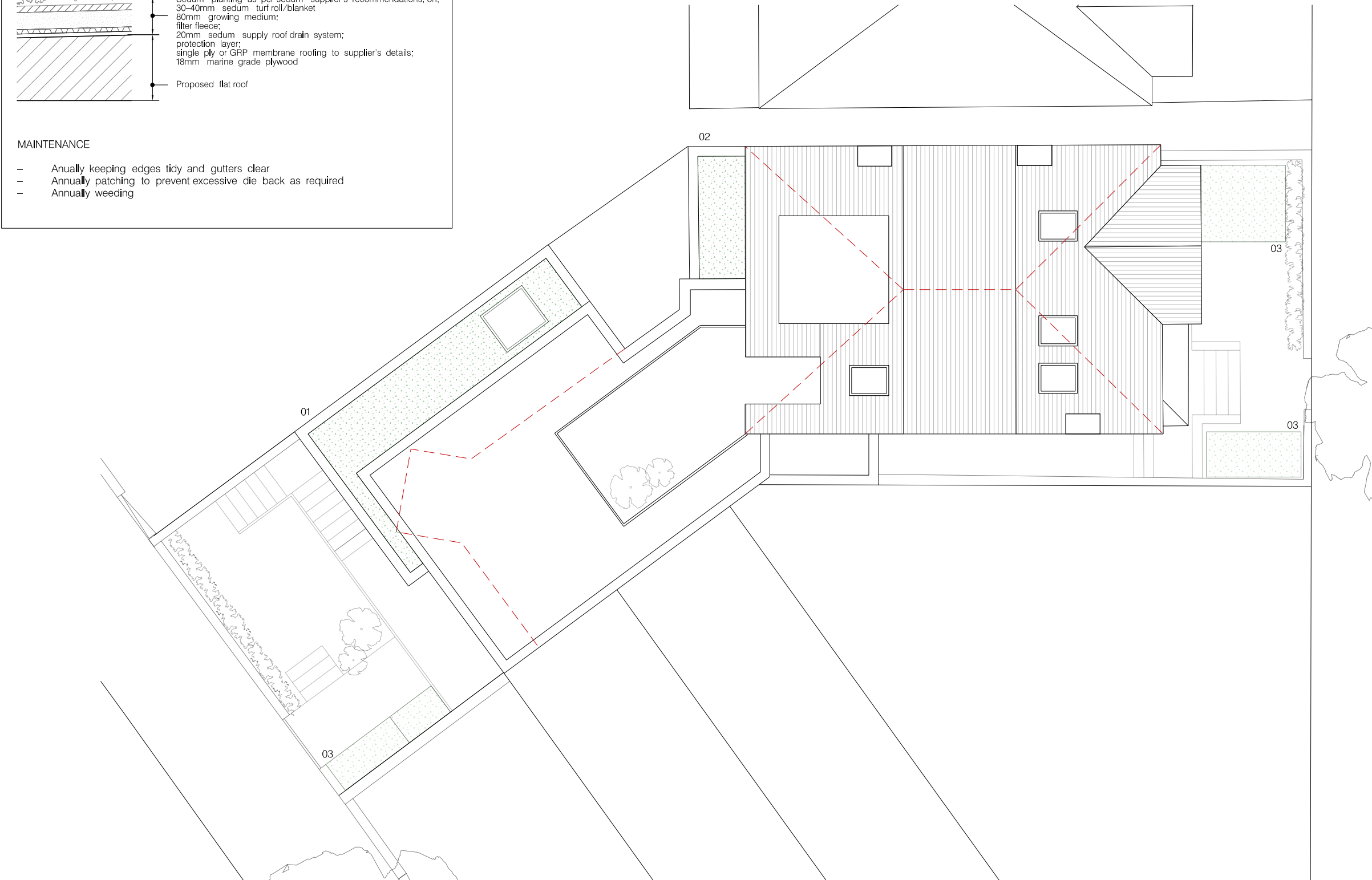

01	EXTENSIVE GREEN ROOF TO NEW FRONT AND SIDE GROUND FLOOR EXTENSION FACING WESTBERE ROAD AREA 9.3sqm
02	EXTENSIVE GREEN ROOF TO REAR EXTENSION AREA 3.1sqm
03	GREEN ROOF TO BIN & CYCLE STORES AREA 8.5sqm

— — LINE OF EXISTING

