

Adjoining properties, highlighted by cross hatch, are shown indicatively to provide context.

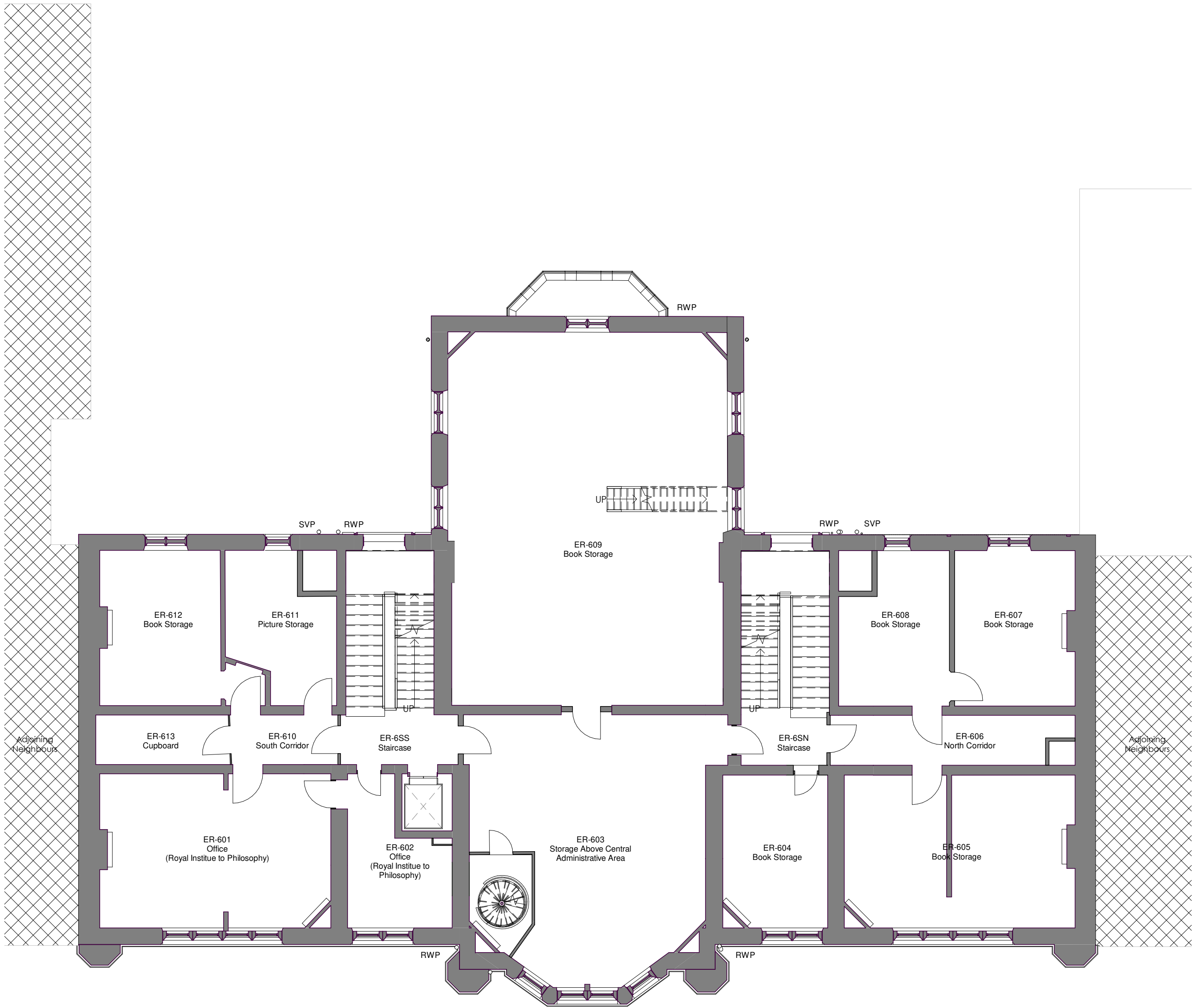

P05	2021-08-27	Drawing issued for Plannig
P04	2019-11-08	Planning Issue
P03	2019-10-28	Drawings issued for Planning
P02	2019-09-09	Room numbers updated to match condition survey report.
P01	2019-07-16	Drawing notes updated
REV	DATE	DESCRIPTION

ORIGINATOR REF: 8555



CPMG Architects Ltd

Nottingham 13 St. Peters Gate, Nottingham, NG1 2JF tel: 0115 958 9500
London 31/35 Kirby Street, London, EC1N 8TE tel: 0207 492 1805
Birmingham The Lewis Building 35 Bull Street Birmingham B4 6EQ tel: 0121 481 2092

enquiries@cpmg-architects.com www.cpmg-architects.com

PROJECT

Dr Williams's Library
Library Building

DRAWING TITLE

FLOOR PLANS
Existing GA Plan - Level 06

DRAWING PURPOSE

PLANNING SUBMISSION

DRAWN BY	DATE	CHK'D BY	SCALE	MEDIA
HW	2019-06-26	CW	1 : 100	A2

PROJECT - ORIGINATOR - ZONE - LEVEL - TYPE - ROLE - NUMBER REVISION

W82-CPM-Z1-06-DR-A-20006 **P05**

Drawing based on survey information, Revit model and CAD drawings produced by City Survey's and Survey Hub, refer to below files. CPMG cannot be held responsible for any discrepancies within the original Revit survey or CAD drawings.
- 10410E_R (City Surveys)
- CSDr 000765-DWL-SU-DRG-0001-A01.rvt (City Surveys)
- 3916_Dr Williams Library_3D Model (Survey Hub)

Copyright of CPMG Architects Limited 2019. All rights reserved. No part of this publication may be reproduced, stored in any retrieval system or transmitted in any form or by any means without prior permission of CPMG Architects Limited. Do not scale from drawing for Construction or Setting-out purposes, use figured dimensions only. All dimensions to be checked on site.

ISO 9001: 2015 Quality Management
ISO 14001: 2015 Environmental Management
PAS 1192-2: 2013 Building Information Modelling