

1 VSC for Ground Floor Window 'B'  
Not including courtyard balconies

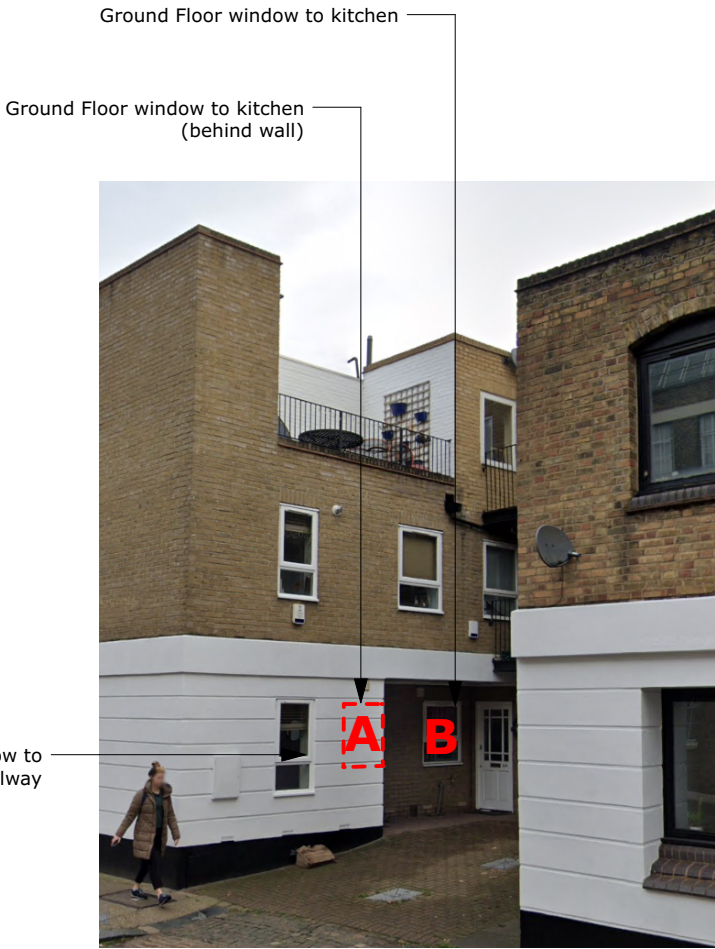

2 Existing Courtyard Space  
Proposed ghosted on



62a Highgate Road - Room layout assumed to match approved plans from application ref. 2004/2612/L

VSC CALCULATION

Existing: 8.25%  
Proposed: 7.25%

Difference: 1.0%  
As percentage of original: 87.9%

Since the new development is not less than 27% VSC and less than 80% of the original, the reduction in the amount of skylight will not be noticeable, as per the BRE209 Guidelines

Proposed VSC  
Existing VSC

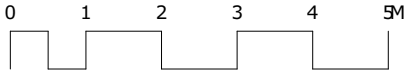

P1 02/09/21 GDC First Issue revisions:

Purpose of issue:  
For Planning

NORTON MAYFIELD ARCHITECTS  
Harland Works, Unit 8  
70 John Street  
Sheffield  
S2 4QU  
Tel: 0114 270 0014  
Sheffield & London  
www.nortonmayfield.co.uk

Client:

Highgate Road Estates Limited

Project:  
**62 Highgate Road,  
London, NW5 1PA**

Drawing No:  
**2042-NMA-XX-00-SK-A-00101**

Drawing title:  
**Daylight Analysis - B**

Status: S2 Rev: P1 Scale: 1:100 @A3

2042-NMA-00-ZZ-M3-A-00002.vwx