

1 Existing Site Plan
Scale: 1:150

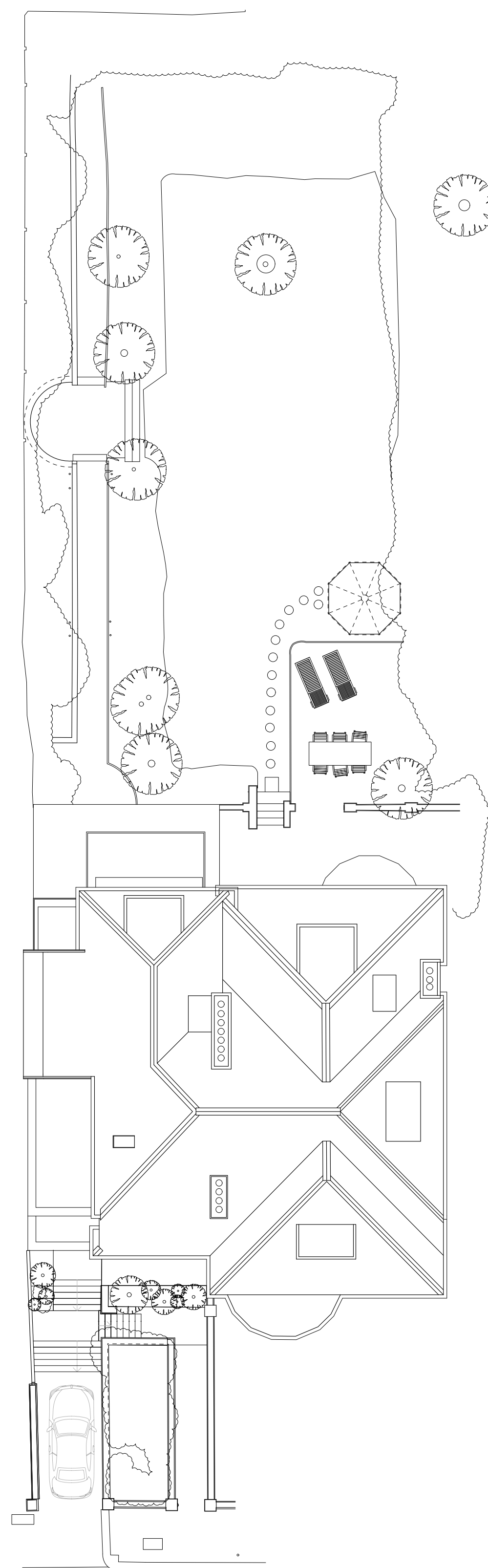

2 Proposed Site Plan
Scale: 1:150

NOTES:

This drawing is issued for information only.

All dimensions to be checked on site and any discrepancies are to be raised with the drawing issuer for clarification.

Dimensions are not to be scaled from this drawing.

The information shown on this drawing is subject to measured surveys and structural engineer's designs.

No building work is to be carried out on the basis of this drawing, without the written consent of Amos Goldreich Architecture.

rev	date	initials	description
-----	------	----------	-------------

location



Amos Goldreich Studio 32 T +44(0)207272 6592
Architecture Bickerton House E info@agarchitecture.net
25 Bickerton Road www.agarchitecture.net
London N19 5JT

project

43A Redington Road

drawing title

Site Plans

drawn AM		
date April 2021	scale @ A1 1:150	status Draft
project number 340	drawing number 100	rev. C