

Notes

- Application Site - Victoria House, Bloomsbury
- Upper Ground Floor Office

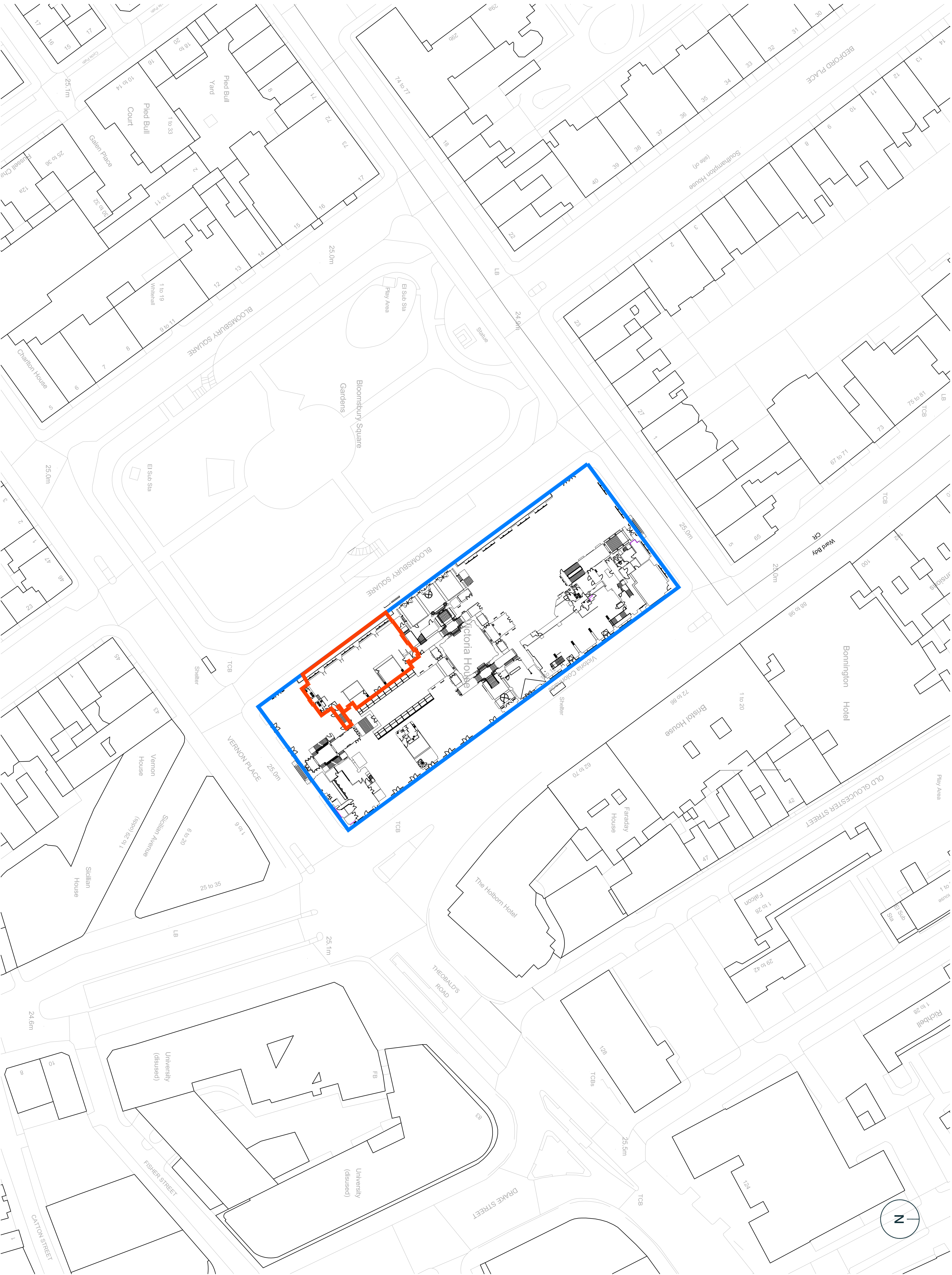

01	18.08.2021	Issued for Approval	GA	DB
Rev	Date	Description	By	Chkd
1		Do not scale from this drawing. All dimensions are in mm unless otherwise stated.		
2		All levels and dimensions to be checked on site by contractor prior to commencing works. Report all discrepancies to DMBA.		
3		Workmanship and material shall follow relevant British standards and specification and codes of practice.		
4		If this drawing is part of planning application, it should only be used for incorporation into this drawing from other professionals, any clarifications or further information required regarding this information from other professionals should be acquired from the relevant professional.		
5		DMBA is not responsible for the accuracy of any information incorporated into this drawing from other professionals.		
6		DMBA are to be informed, if there are any discrepancies between this drawing and other DMBA drawings or other consultants drawings.		
7		This drawing is to be read in conjunction with all other DMBA drawings, specifications, and contract documentation.		
8		All work and site procedures are to comply with CDM requirements and regulations.		
9		This drawing is subject to copyright.		
Title		Site Plan		
Project		Victoria House UGF SW Unit		
Drawing Status		Planning		
Scale		1:500 at A1 1:1000 at A3		
Project No.	Drawing No.	Revision		
21016	0102	Rev 01		