

All penetrations in Illbruck membrane to be sealed in accordance with waterproofing specialist's details. Detail between window frame and membrane as per manufacturer's requirements

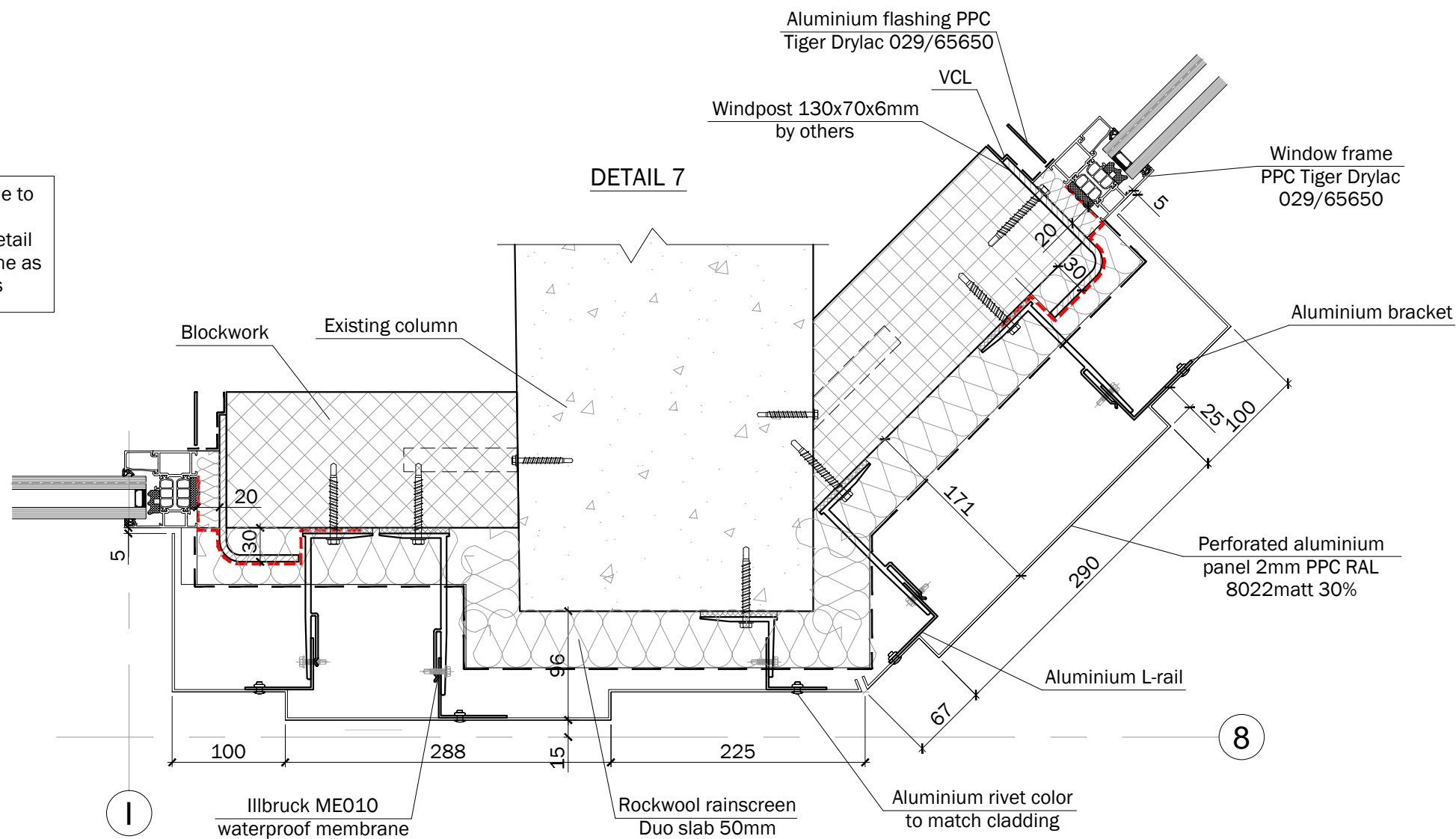

C02	General update	13.08.21	DB	JA	Project	GREVILLE STREET		
C01	Issued for construction	26.07.21	DB	JA				
P01	Issued for comments	13.04.21	DB	JA				
Rev No	Revision note	Date	Drawn	Checked	Drawing	Cladding detail 7		
Client					Drawn By	Status		
RED Construction Group Ltd					DB	For construction		
Drawn By					Scale	Date		
Dmitro Facades Unit 17, Dunstall Estate Leight Place, Welling Kent, DA16 3JH					1:5 A3	13.04.21		
Tel: 0207 254 4603 E-mail: office@dmitrofacades.co.uk					DWG No	POI	Rev	
					GS-DFL-XX-00-DR-X-0007	A5	C02	