

Note:

1. -
2. -
3. New fixings required for new railing, to be concealed beneath new marble coping, to match the historic.
4. -
5. -
6. -
7. -
8. -
9. -
10. -
11. Historic balustrade to be removed, modified and reinstated to suit new fill of steps.
12. -
13. Historic railings to be removed, modified and reinstated as detail 20.375

RAILINGS

- Historic railing removed, modified and reinstated. Ref drg 20.375
- New railing with existing historic metal panel incorporated. New metalwork elements to match the design and finish of the historic like for like. Ref elevation B, 03/20.374
- Historic balustrade to be removed, modified and reinstated to suit new fill of steps

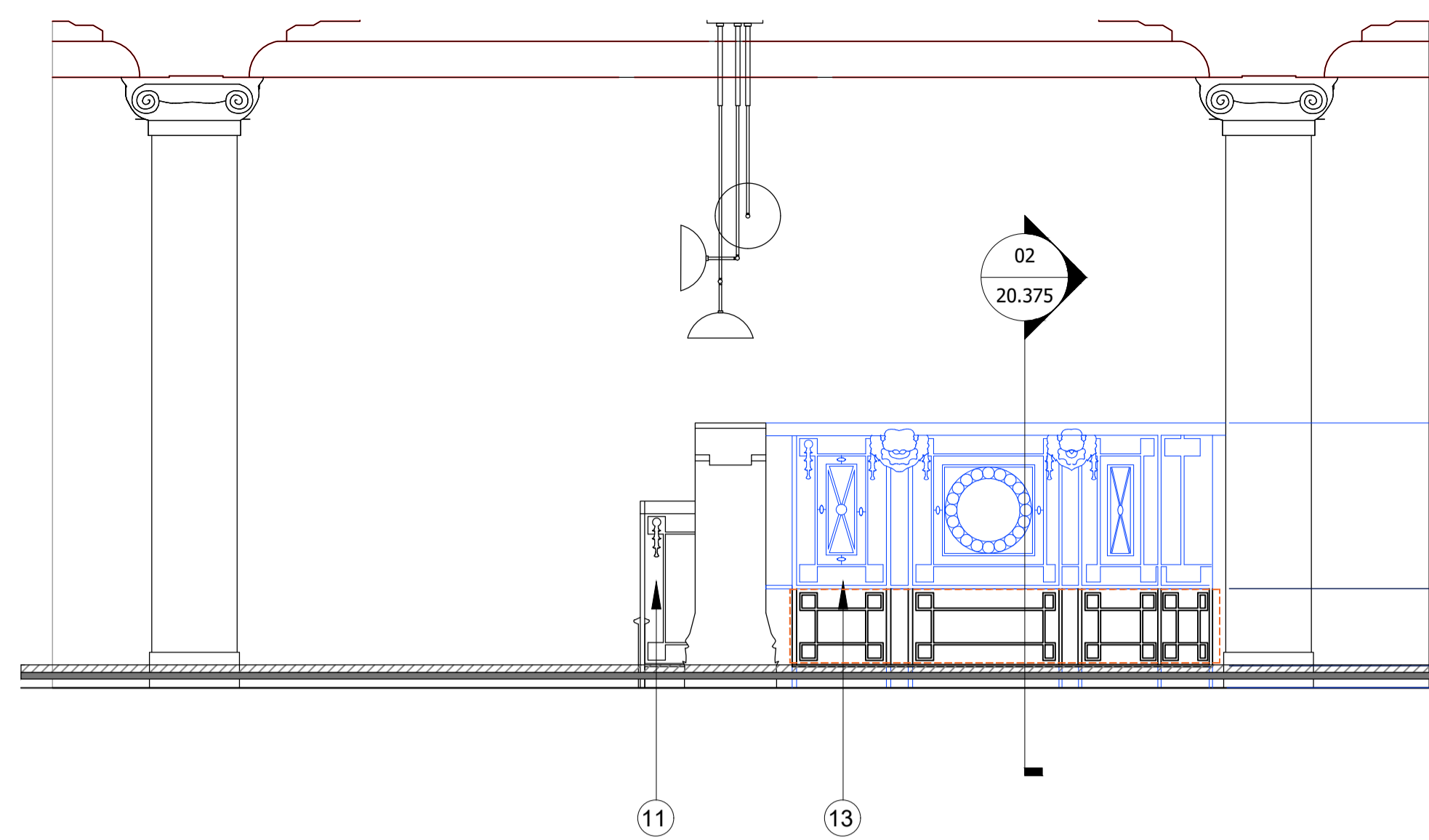

02
20.374
Elevation A
1:25@A1 / 1:50@A3



Historic inset metal panel to be re-used within new railing. As shown in Elevation B

Reference photo

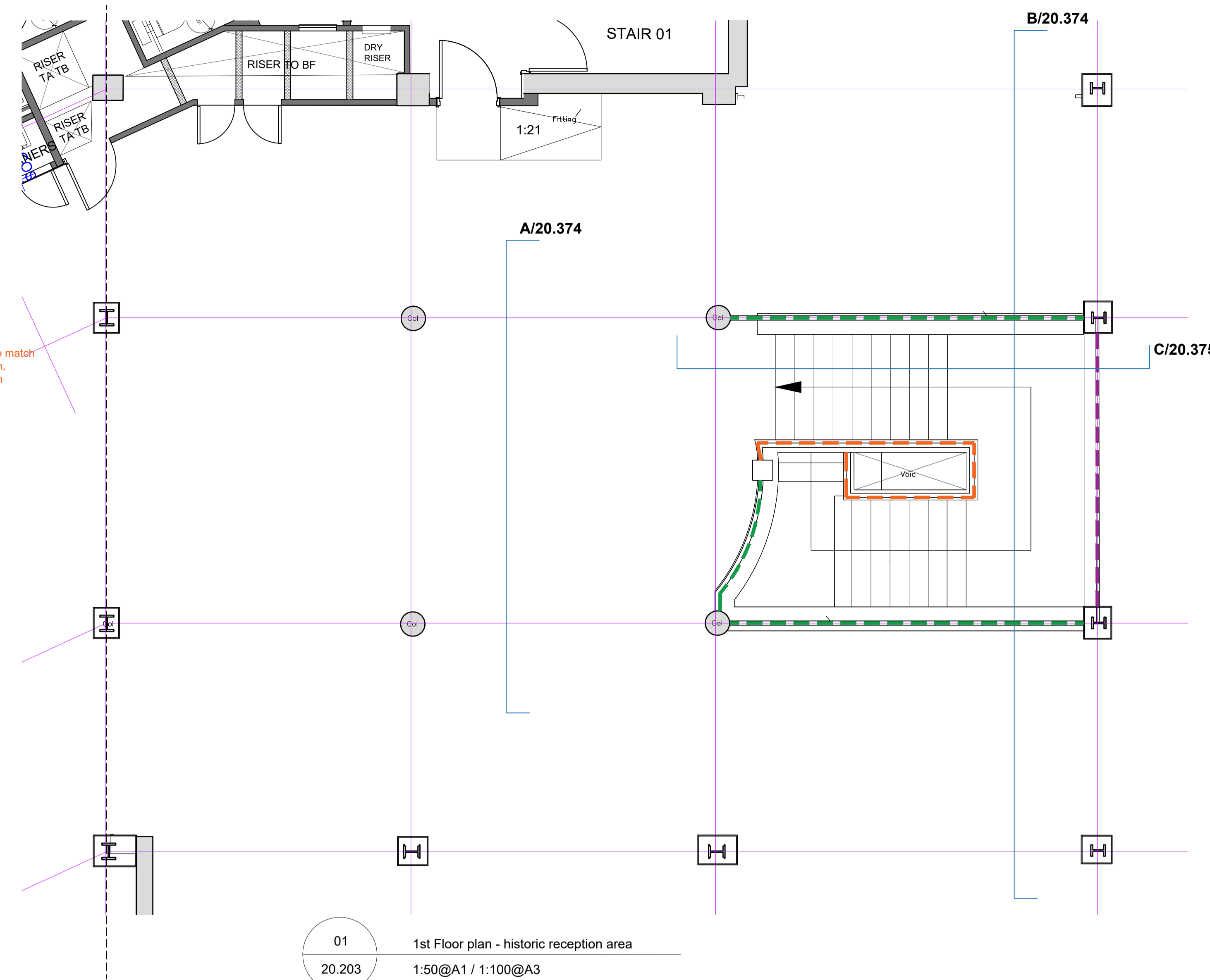

01
20.203
1st Floor plan - historic reception area
1:50@A1 / 1:100@A3

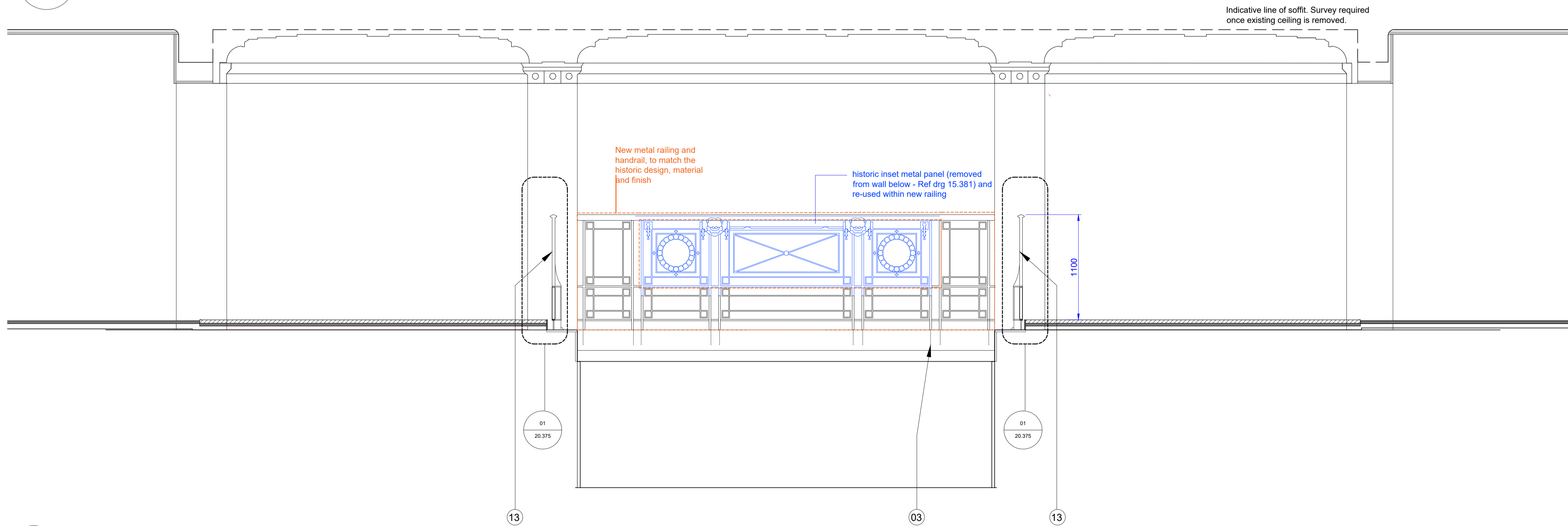

03
20.374
Elevation B
1:25@A1 / 1:50@A3

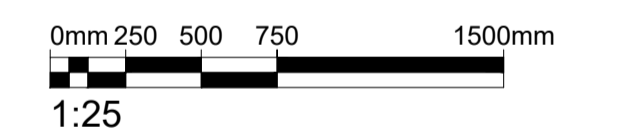

Rev.	Description.	By	Date
----	P1 For Planning	AC	19.08.21

Client
Kings Keeley Limited C/o Clearbell Capital LLP

Project
65 Kingsway - Base Scheme

Title
Kingsway Reception - First Floor

Status	Purpose of issue	RIBA stage
s4	For Planning	4

Project No.	Drawn	Checked	Scale	Rev.
1914	AC	TJ	1:100 @ A1 1:200 @ A3	P1

Drawing No.

1914-BG-01-00-DR-A-20.374

Do not scale from this drawing. The Contractor is to take and check all dimensions on site before work commences. Discrepancies must be reported to the Architect. Subcontractors must verify all dimensions on site before making a shop drawing or commencing manufacturing. This drawing is copyright. ©

© Copyright Barr Gazetas Ltd.
A 10 Heddon Street, London, W1B 4BG
T 0207 638 5591
W www.barrgazetas.com