

# BARR GAZETAS

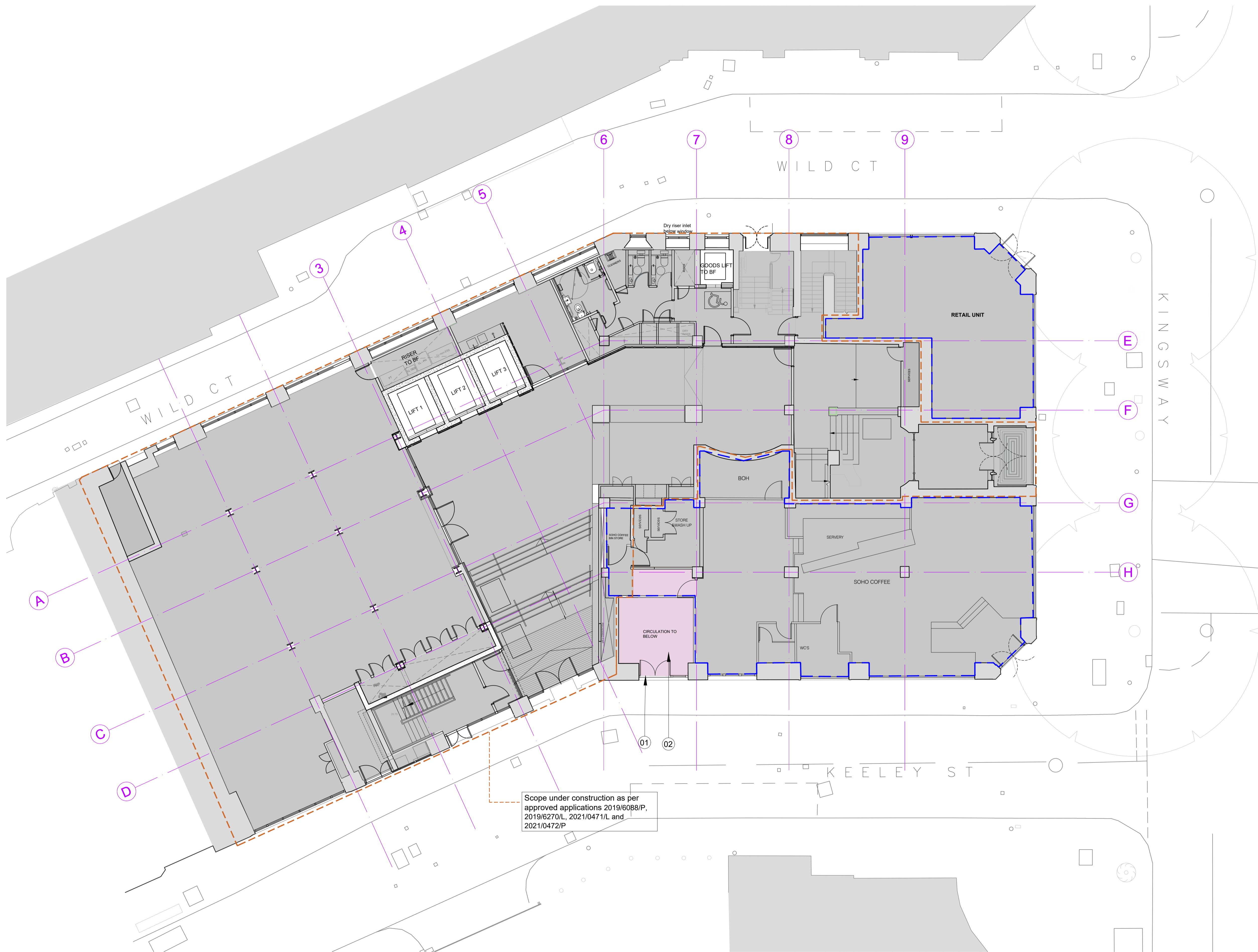

Scope under construction as per approved applications 2019/6088/P, 2019/6270/L, 2021/0471/L and 2021/0472/P

- KEY :
- Existing Walls
  - Common parts
  - Not in scope

A1 and A3 demise

- Note:
1. Existing entrance doors. Consent to remove under approved applications 2019/6088/P, 2019/6270/L, 2021/0471/L and 2021/0472/P
  2. Existing circulation to BF with temporary scaffolding stair.

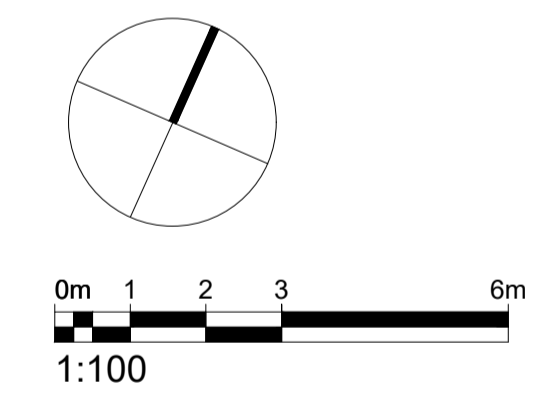

P1	FOR PLANNING	AC	19.06.21
Rev.	Description	By	Date

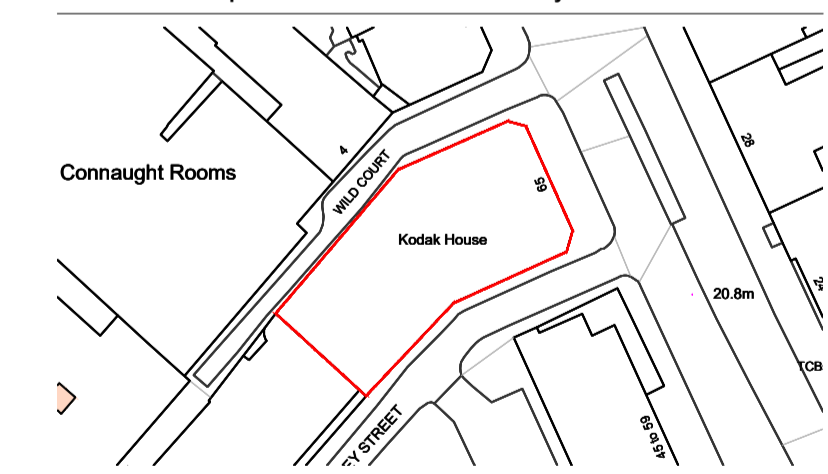

Client  
Kings Keeley Limited C/o Clearbell Capital LLP

Project  
**65 Kingsway**

Title  
**Existing Ground Floor Plan**

Status	Purpose of issue	RIBA stage
S2	For Planning	2

Project No.	Drawn	Checked	Scale	Rev.
1914	FB	TJ	1:100 @ A1 1:200 @ A3	P1

Drawing No.  
**1914-BG-02-00-DR-A-10.202**

Do not scale from this drawing. The Contractor is to take and check all dimensions on site before work commences. Discrepancies must be reported to the Architect. Subcontractors must verify all dimensions on site before making a shop drawing or commencing manufacturing. This drawing is copyright. ©

01 Existing Ground Floor Plan  
10.202 1:100@A1, 1:200@A3