

SETTING OUT - DO NOT SCALE from this drawing, use figured dimensions ONLY. If in doubt, ASKI Dimensions are shown to structural face generally, or to finished face of ducts and lining. All dimensions are shown in millimeters unless otherwise indicated. Angular dimensions are shown in decimal degrees to the nearest whole degree. Where items are to be fabricated off-site, site dimensions are to be used and confirmed prior to ordering or manufacturing.

Revisions from previous Planning submission numbered (for supporting document for full description): Basement wall realignment (1)(2); Escape stair relocation (3); Supermarket wall realignment (4); internal stair relocation (5); infill of double-height void spaces (6); Column alterations (7); Swapping of Affordable Workspace and Substation locations (8); Removal of B2 level below Block A and creation of pool plant room under car-park ramp (9); Adjustment of internal floor level for supermarket (10).

status: **PLANNING**

reason for issue:

P T A L
| Architects | Masterplanners | Designers |



PTAL Project Number: 200035

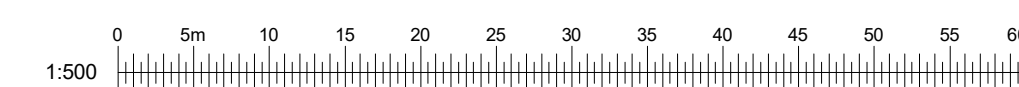
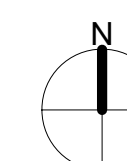
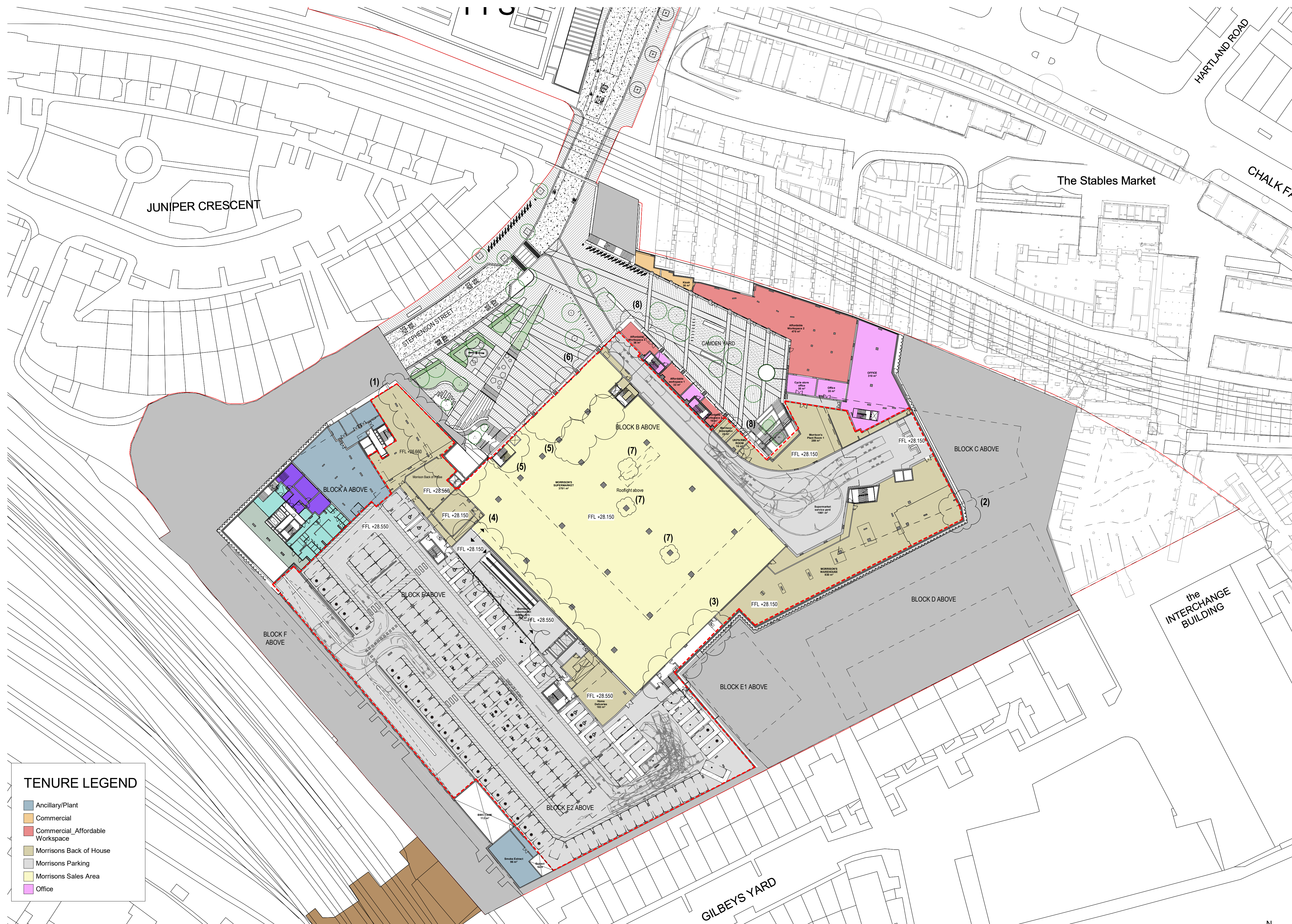

- Ancillary/Plant
- Commercial
- Commercial_Affordable Workspace
- Morrisons Back of House
- Morrisons Parking
- Morrisons Sales Area
- Office