

## Level 01 Podium

Installation : Mount Pleasant Externals

Project number :  
Customer : Caldwell  
Processed by : DRT  
Date : 07.05.2021

Please note Orlight offer light level calculations as a bespoke complimentary service to valued clients. Orlight only act as a supplier of lighting and as such calculations are provided for informative purposes only.

All information is provided in good faith and is dependent on a multitude of variables including drawing scales and finishes. Adjustment of any such parameters may result in an alteration in light levels. As such Orlight will not be held responsible for and inaccuracies whatsoever.

In some cases photometric data (Eulumdat File) may be altered in the calculation software in an effort to better simulate the environment the luminaire is in, an example being reducing the luminaries height to create a recessed effect in the ceiling.

LDR-01 V1 28/10/19

The following values are based on exact calculations on calibrated lamps, luminaires and their arrangement. In practice, gradual divergences can occur.

Guarantee claims for luminaire data are excluded.

Relux and the luminaire manufacturers accept no liability for consequential damage and damage which is occasioned to the user or to third parties.

Object : Level 01 Podium  
Installation : Mount Pleasant Externals  
Project number :  
Date : 07.05.2021

orlight

FROM SOURCE TO SITE

## 2 Exterior 1 - Additional Lighting

### 2.1 Description, Exterior 1 - Additional Lighting

#### 2.1.1 Floor plan

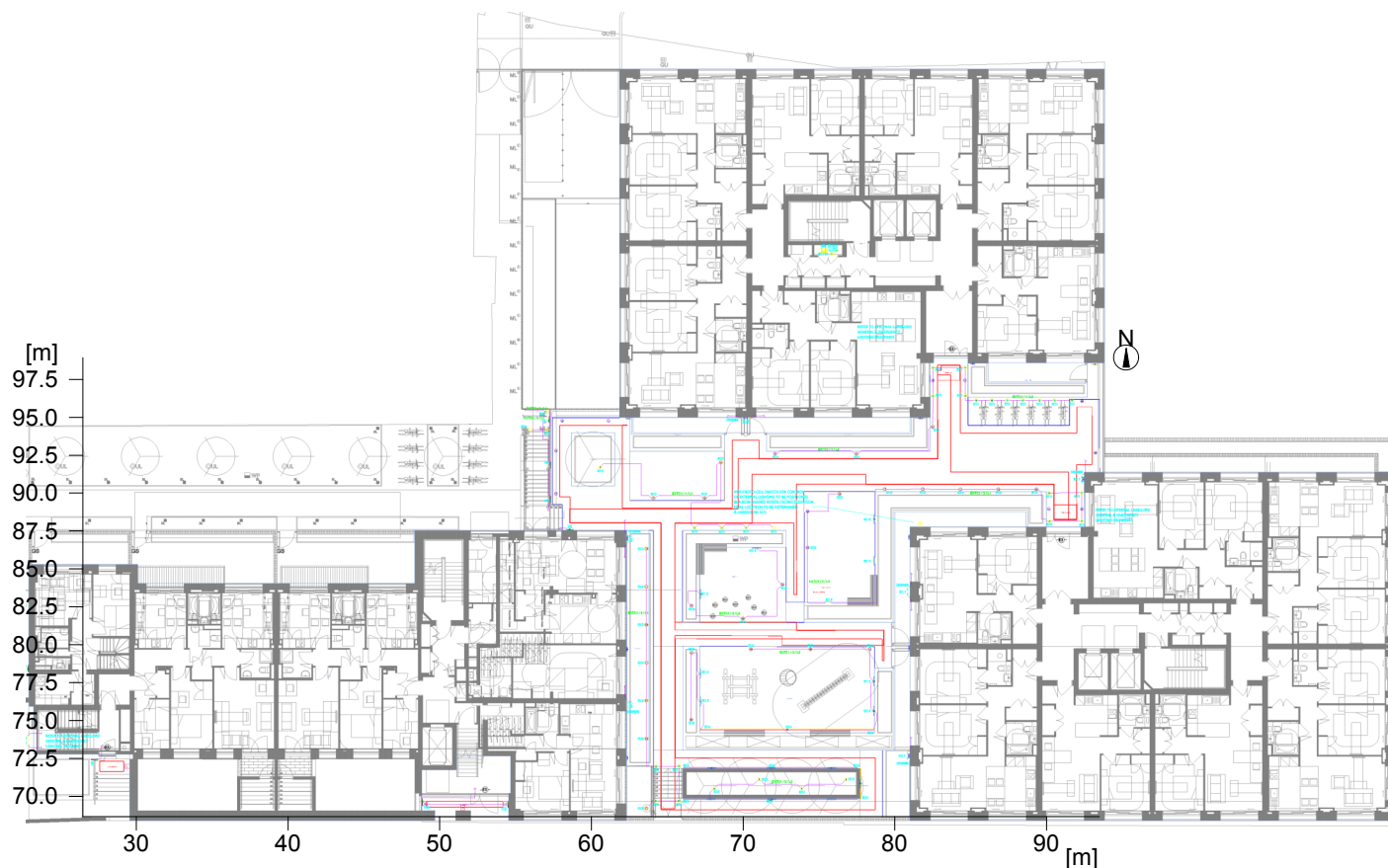

Object : Level 01 Podium  
 Installation : Mount Pleasant Externals  
 Project number :  
 Date : 07.05.2021



FROM SOURCE TO SITE

## 2 Exterior 1 - Additional Lighting

### 2.2 Summary, Exterior 1 - Additional Lighting

#### 2.2.1 Result overview, Entrance 1

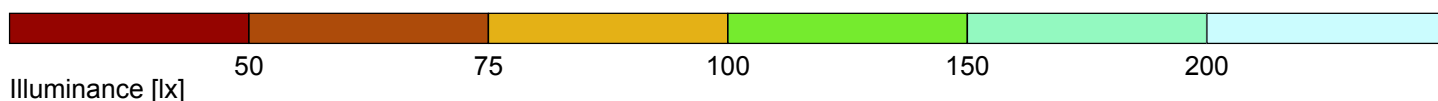
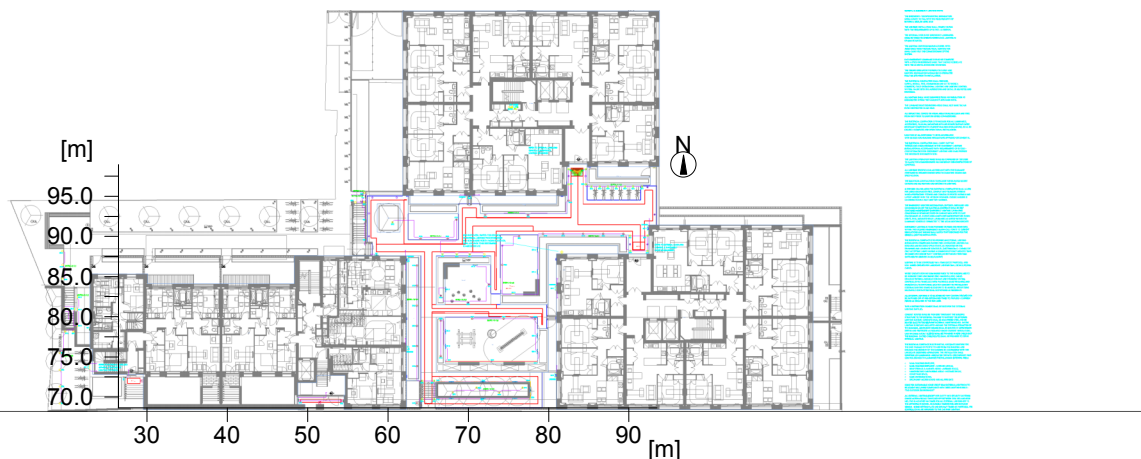

#### General

Calculation algorithm used	Average indirect fraction
Height of evaluation surface	0.00 m
Maintenance factor	0.80

Total luminous flux of all lamps	87604 lm
Total power	1861 W
Total power per area (803.87 m <sup>2</sup> )	2.32 W/m <sup>2</sup>

#### Illuminance

Average illuminance	Eav	108 lx
Minimum illuminance	Emin	55 lx
Maximum illuminance	Emax	212 lx
Uniformity U <sub>o</sub>	Emin/Em	1:1.97 (0.51)
Diversity U <sub>d</sub>	Emin/Emax	1:3.86 (0.26)

#### Type No.\Make

1	1	<b>ORLIGHT LTD</b>
	Order No.	: Ref EX5 - LUCIA350-BL-3000K
	Luminaire name	: Ref EX5 - LUCIA350-BL-3000K
	Equipment	: 1 x 20 W / 1054 lm

Object : Level 01 Podium  
Installation : Mount Pleasant Externals  
Project number :  
Date : 07.05.2021

**orlight**

FROM SOURCE TO SITE

## 2 Exterior 1 - Additional Lighting

### 2.2 Summary, Exterior 1 - Additional Lighting

#### 2.2.1 Result overview, Entrance 1

9 39  Order No. : Ref EX3 - ORLLUNAR-1M-4000K  
Luminaire name : Ref EX3 - ORLLUNAR-1M-4000K  
Equipment : 1 x 28 W / 1300 lm

7 22  **Orlight**  
Order No. : Ref EX1 - ORLLM88-1-SS-3000K  
Luminaire name : Ref EX1 - ORLLM88-1-SS-3000K  
Equipment : 1 x LED 3 W / 35 lm

10 15  Order No. : Ref EX4 - LUNGO600-3000K  
Luminaire name : Ref EX4 - LUNGO600-3000K  
Equipment : 1 x 11 W / 575 lm

12 3  Order No. : Ref EX8 - LF-TOP-4000K - 11500mm  
Luminaire name : Ref EX8 - LF-TOP-4000K - 11500mm  
Equipment : 1 x LED 138 W / 5405 lm

13 1  Order No. : Ref EX8 - LF-TOP-4000K - 2000mm  
Luminaire name : Ref EX8 - LF-TOP-4000K - 2000mm  
Equipment : 1 x LED 24 W / 940 lm

4 4  **Orlight Ltd**  
Order No. : Ref SE - FALCON-BL-3K-13W  
Luminaire name : Ref SE - FALCON-BL-3K-13W  
Equipment : 1 x 13 W / 1885 lm

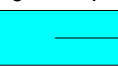
6 1  Order No. : Ref VE - ORLBH28-E-BL-LED-4000K  
Luminaire name : Ref VE - ORLBH28-E-BL-LED-4000K  
Equipment : 1 x LED 13 W / 585 lm

8 5  **ORLIGHT**  
Order No. : Ref EX2 - ORLLM66-SS-3000K  
Luminaire name : Ref EX2 - ORLLM66-SS-3000K  
Equipment : 1 x 3 W / 235 lm

Object : Level 01 Podium  
 Installation : Mount Pleasant Externals  
 Project number :  
 Date : 07.05.2021



FROM SOURCE TO SITE

## 2.2 Summary, Exterior 1 - Additional Lighting

### 2.2.2 Result overview, Entrance 2

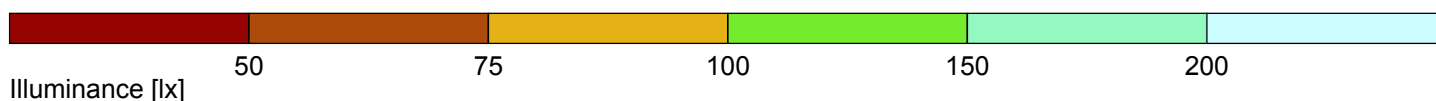
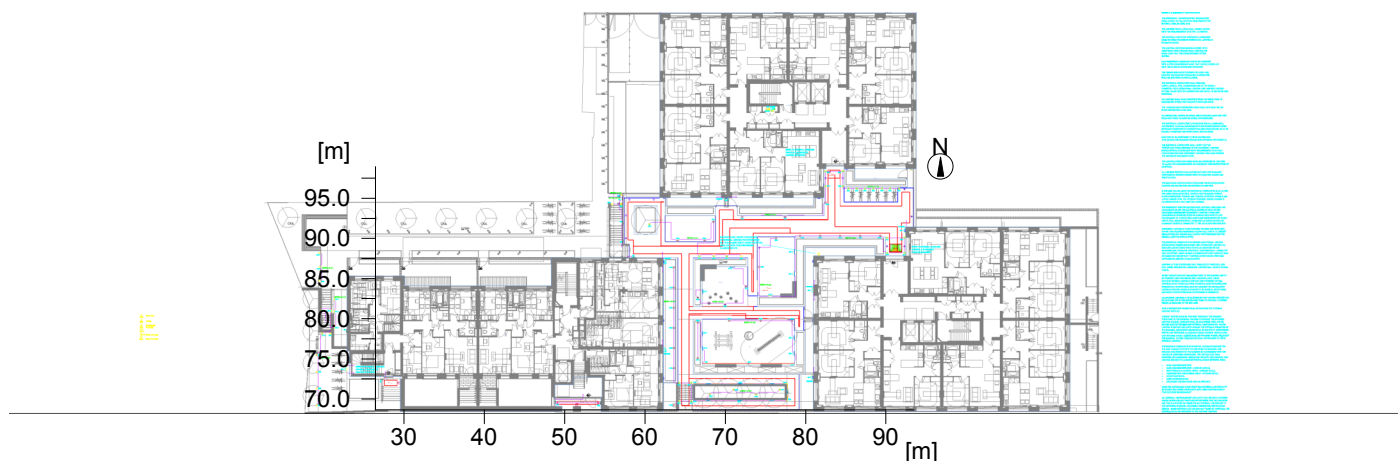

#### General

Calculation algorithm used	Average indirect fraction
Height of evaluation surface	-0.00 m
Maintenance factor	0.80

Total luminous flux of all lamps	87604 lm
Total power	1861 W
Total power per area (803.87 m <sup>2</sup> )	2.32 W/m <sup>2</sup>

#### Illuminance

Average illuminance	Eav	123 lx
Minimum illuminance	Emin	74 lx
Maximum illuminance	E <sub>max</sub>	198 lx
Uniformity U <sub>o</sub>	E <sub>min</sub> /E <sub>m</sub>	1:1.67 (0.6)
Diversity U <sub>d</sub>	E <sub>min</sub> /E <sub>max</sub>	1:2.68 (0.37)

#### Type No.\Make

1	1	<b>ORLIGHT LTD</b>
		Order No. : Ref EX5 - LUCIA350-BL-3000K
		Luminaire name : Ref EX5 - LUCIA350-BL-3000K
		Equipment : 1 x 20 W / 1054 lm

Object : Level 01 Podium  
Installation : Mount Pleasant Externals  
Project number :  
Date : 07.05.2021

**orlight**

FROM SOURCE TO SITE

## 2.2 Summary, Exterior 1 - Additional Lighting

### 2.2.2 Result overview, Entrance 2

9 39  Order No. : Ref EX3 - ORLLUNAR-1M-4000K  
Luminaire name : Ref EX3 - ORLLUNAR-1M-4000K  
Equipment : 1 x 28 W / 1300 lm

7 22  **Orlight**  
Order No. : Ref EX1 - ORLLM88-1-SS-3000K  
Luminaire name : Ref EX1 - ORLLM88-1-SS-3000K  
Equipment : 1 x LED 3 W / 35 lm

10 15  Order No. : Ref EX4 - LUNGO600-3000K  
Luminaire name : Ref EX4 - LUNGO600-3000K  
Equipment : 1 x 11 W / 575 lm

12 3  Order No. : Ref EX8 - LF-TOP-4000K - 11500mm  
Luminaire name : Ref EX8 - LF-TOP-4000K - 11500mm  
Equipment : 1 x LED 138 W / 5405 lm

13 1  Order No. : Ref EX8 - LF-TOP-4000K - 2000mm  
Luminaire name : Ref EX8 - LF-TOP-4000K - 2000mm  
Equipment : 1 x LED 24 W / 940 lm

4 4  **Orlight Ltd**  
Order No. : Ref SE - FALCON-BL-3K-13W  
Luminaire name : Ref SE - FALCON-BL-3K-13W  
Equipment : 1 x 13 W / 1885 lm

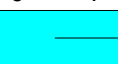
6 1  Order No. : Ref VE - ORLBH28-E-BL-LED-4000K  
Luminaire name : Ref VE - ORLBH28-E-BL-LED-4000K  
Equipment : 1 x LED 13 W / 585 lm

8 5  **ORLIGHT**  
Order No. : Ref EX2 - ORLLM66-SS-3000K  
Luminaire name : Ref EX2 - ORLLM66-SS-3000K  
Equipment : 1 x 3 W / 235 lm

Object : Level 01 Podium  
 Installation : Mount Pleasant Externals  
 Project number :  
 Date : 07.05.2021



FROM SOURCE TO SITE

## 2.2 Summary, Exterior 1 - Additional Lighting

### 2.2.3 Result overview, Entrance 3

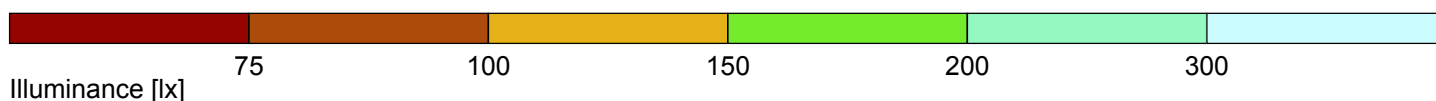
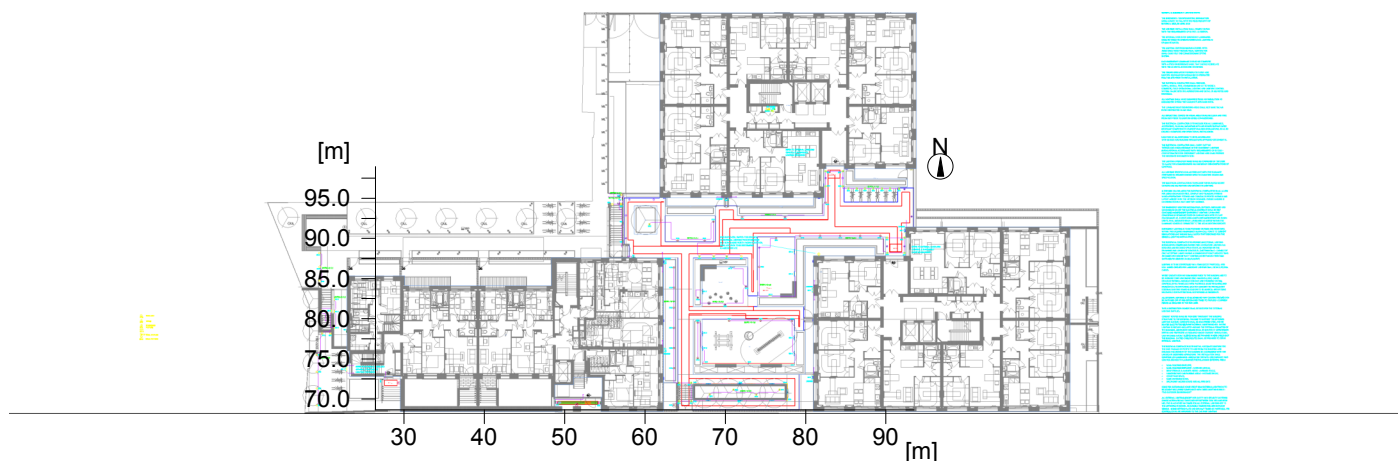

#### General

Calculation algorithm used	Average indirect fraction
Height of evaluation surface	0.00 m
Maintenance factor	0.80

Total luminous flux of all lamps	87604 lm
Total power	1861 W
Total power per area (803.87 m <sup>2</sup> )	2.32 W/m <sup>2</sup>

#### Illuminance

Average illuminance	Eav	167 lx
Minimum illuminance	Emin	132 lx
Maximum illuminance	E <sub>max</sub>	206 lx
Uniformity U <sub>o</sub>	E <sub>min</sub> /E <sub>m</sub>	1:1.27 (0.79)
Diversity U <sub>d</sub>	E <sub>min</sub> /E <sub>max</sub>	1:1.56 (0.64)

#### Type No.\Make

1	1	<b>ORLIGHT LTD</b>
	Order No.	: Ref EX5 - LUCIA350-BL-3000K
	Luminaire name	: Ref EX5 - LUCIA350-BL-3000K
	Equipment	: 1 x 20 W / 1054 lm

Object : Level 01 Podium  
Installation : Mount Pleasant Externals  
Project number :  
Date : 07.05.2021

**orlight**

FROM SOURCE TO SITE

## 2.2 Summary, Exterior 1 - Additional Lighting

### 2.2.3 Result overview, Entrance 3

9 39  Order No. : Ref EX3 - ORLLUNAR-1M-4000K  
Luminaire name : Ref EX3 - ORLLUNAR-1M-4000K  
Equipment : 1 x 28 W / 1300 lm

7 22  **Orlight**  
Order No. : Ref EX1 - ORLLM88-1-SS-3000K  
Luminaire name : Ref EX1 - ORLLM88-1-SS-3000K  
Equipment : 1 x LED 3 W / 35 lm

10 15   
Order No. : Ref EX4 - LUNGO600-3000K  
Luminaire name : Ref EX4 - LUNGO600-3000K  
Equipment : 1 x 11 W / 575 lm

12 3   
Order No. : Ref EX8 - LF-TOP-4000K - 11500mm  
Luminaire name : Ref EX8 - LF-TOP-4000K - 11500mm  
Equipment : 1 x LED 138 W / 5405 lm

13 1   
Order No. : Ref EX8 - LF-TOP-4000K - 2000mm  
Luminaire name : Ref EX8 - LF-TOP-4000K - 2000mm  
Equipment : 1 x LED 24 W / 940 lm

4 4  **Orlight Ltd**  
Order No. : Ref SE - FALCON-BL-3K-13W  
Luminaire name : Ref SE - FALCON-BL-3K-13W  
Equipment : 1 x 13 W / 1885 lm

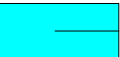
6 1   
Order No. : Ref VE - ORLBH28-E-BL-LED-4000K  
Luminaire name : Ref VE - ORLBH28-E-BL-LED-4000K  
Equipment : 1 x LED 13 W / 585 lm

8 5  **ORLIGHT**  
Order No. : Ref EX2 - ORLLM66-SS-3000K  
Luminaire name : Ref EX2 - ORLLM66-SS-3000K  
Equipment : 1 x 3 W / 235 lm



Object : Level 01 Podium  
 Installation : Mount Pleasant Externals  
 Project number :  
 Date : 07.05.2021

## 2.2 Summary, Exterior 1 - Additional Lighting

### 2.2.4 Result overview, Entrance 4

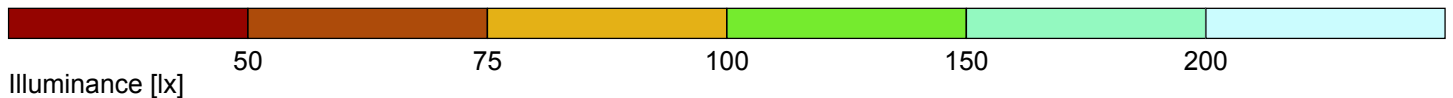
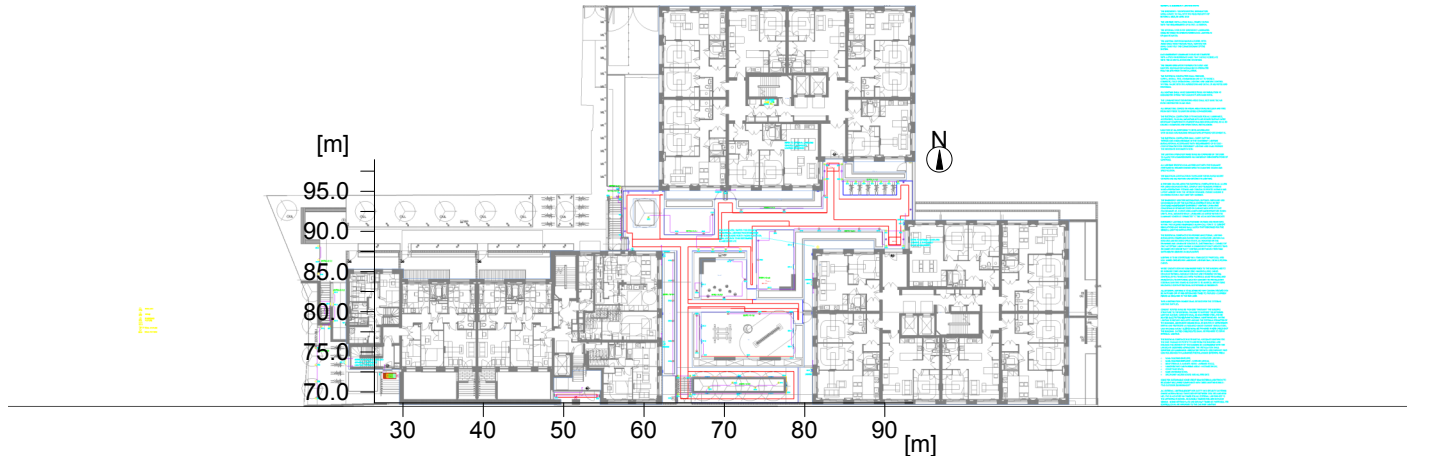

#### General

Calculation algorithm used	Average indirect fraction
Height of evaluation surface	-0.00 m
Maintenance factor	0.80

Total luminous flux of all lamps	87604 lm
Total power	1861 W
Total power per area (803.87 m <sup>2</sup> )	2.32 W/m <sup>2</sup>

#### Illuminance

Average illuminance	Eav	108 lx
Minimum illuminance	Emin	55 lx
Maximum illuminance	E <sub>max</sub>	162 lx
Uniformity U <sub>o</sub>	E <sub>min</sub> /E <sub>m</sub>	1:1.98 (0.51)
Diversity U <sub>d</sub>	E <sub>min</sub> /E <sub>max</sub>	1:2.95 (0.34)

#### Type No.\Make

1	1	<b>ORLIGHT LTD</b>
	Order No.	: Ref EX5 - LUCIA350-BL-3000K
	Luminaire name	: Ref EX5 - LUCIA350-BL-3000K
	Equipment	: 1 x 20 W / 1054 lm

Object : Level 01 Podium  
Installation : Mount Pleasant Externals  
Project number :  
Date : 07.05.2021

**orlight**

FROM SOURCE TO SITE

## 2.2 Summary, Exterior 1 - Additional Lighting

### 2.2.4 Result overview, Entrance 4

9 39  Order No. : Ref EX3 - ORLLUNAR-1M-4000K  
Luminaire name : Ref EX3 - ORLLUNAR-1M-4000K  
Equipment : 1 x 28 W / 1300 lm

7 22  **Orlight**  
Order No. : Ref EX1 - ORLLM88-1-SS-3000K  
Luminaire name : Ref EX1 - ORLLM88-1-SS-3000K  
Equipment : 1 x LED 3 W / 35 lm

10 15  Order No. : Ref EX4 - LUNGO600-3000K  
Luminaire name : Ref EX4 - LUNGO600-3000K  
Equipment : 1 x 11 W / 575 lm

12 3  Order No. : Ref EX8 - LF-TOP-4000K - 11500mm  
Luminaire name : Ref EX8 - LF-TOP-4000K - 11500mm  
Equipment : 1 x LED 138 W / 5405 lm

13 1  Order No. : Ref EX8 - LF-TOP-4000K - 2000mm  
Luminaire name : Ref EX8 - LF-TOP-4000K - 2000mm  
Equipment : 1 x LED 24 W / 940 lm

4 4  **Orlight Ltd**  
Order No. : Ref SE - FALCON-BL-3K-13W  
Luminaire name : Ref SE - FALCON-BL-3K-13W  
Equipment : 1 x 13 W / 1885 lm

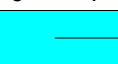
6 1  Order No. : Ref VE - ORLBH28-E-BL-LED-4000K  
Luminaire name : Ref VE - ORLBH28-E-BL-LED-4000K  
Equipment : 1 x LED 13 W / 585 lm

8 5  **ORLIGHT**  
Order No. : Ref EX2 - ORLLM66-SS-3000K  
Luminaire name : Ref EX2 - ORLLM66-SS-3000K  
Equipment : 1 x 3 W / 235 lm

Object : Level 01 Podium  
 Installation : Mount Pleasant Externals  
 Project number :  
 Date : 07.05.2021

## 2.2 Summary, Exterior 1 - Additional Lighting

### 2.2.5 Result overview, Circulation

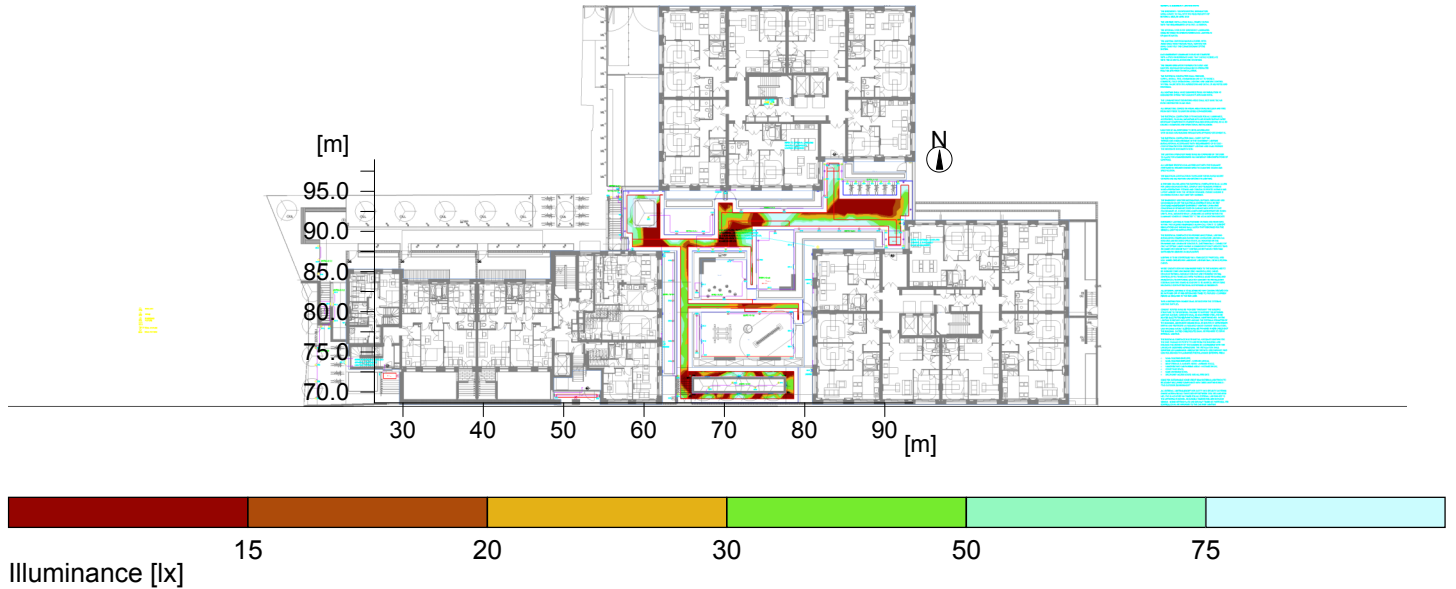

#### General

Calculation algorithm used	Average indirect fraction
Maintenance factor	0.80
Total luminous flux of all lamps	41495.00 lm
Total power	957.0 W
Total power per area (292.86 m <sup>2</sup> )	3.27 W/m <sup>2</sup> (12.62 W/m <sup>2</sup> /100lx)

#### Circulation

<b>Circulation</b>	<b>Circulation</b>
	Horizontal
Em	25.9 lx
Emin	5.7 lx
Emin/Eav (Uo)	0.22
Emin/Emax (Ud)	0.10
Position	0.00 m (rot: 0°/0°)

#### Type No.\Make

9	18	<b>ORLIGHT LTD</b>	
		Order No.	: Ref EX3 - ORLLUNAR-1M-4000K
		Luminaire name	: Ref EX3 - ORLLUNAR-1M-4000K
		Equipment	: 1 x 28 W / 1300 lm







Object : Level 01 Podium  
Installation : Mount Pleasant Externals  
Project number :  
Date : 07.05.2021

**orlight**

FROM SOURCE TO SITE

## 2.2 Summary, Exterior 1 - Additional Lighting

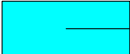
### 2.2.5 Result overview, Circulation

		<b>Orlight</b>	
7	16	Order No.	: Ref EX1 - ORLLM88-1-SS-3000K
		Luminaire name	: Ref EX1 - ORLLM88-1-SS-3000K
		Equipment	: 1 x LED 3 W / 35 lm
10	7	Order No.	: Ref EX4 - LUNGO600-3000K
		Luminaire name	: Ref EX4 - LUNGO600-3000K
		Equipment	: 1 x 11 W / 575 lm
12	2	Order No.	: Ref EX8 - LF-TOP-4000K - 11500mm
		Luminaire name	: Ref EX8 - LF-TOP-4000K - 11500mm
		Equipment	: 1 x LED 138 W / 5405 lm
13	1	Order No.	: Ref EX8 - LF-TOP-4000K - 2000mm
		Luminaire name	: Ref EX8 - LF-TOP-4000K - 2000mm
		Equipment	: 1 x LED 24 W / 940 lm
		<b>Orlight Ltd</b>	
6	1	Order No.	: Ref VE - ORLBH28-E-BL-LED-4000K
		Luminaire name	: Ref VE - ORLBH28-E-BL-LED-4000K
		Equipment	: 1 x LED 13 W / 585 lm
		<b>ORLIGHT</b>	
8	5	Order No.	: Ref EX2 - ORLLM66-SS-3000K
		Luminaire name	: Ref EX2 - ORLLM66-SS-3000K
		Equipment	: 1 x 3 W / 235 lm

Object : Level 01 Podium  
 Installation : Mount Pleasant Externals  
 Project number :  
 Date : 07.05.2021

## 2 Exterior 1 - Additional Lighting

### 2.3 Calculation results, Exterior 1 - Additional Lighting

#### 2.3.1 Table, Escape Route (E)

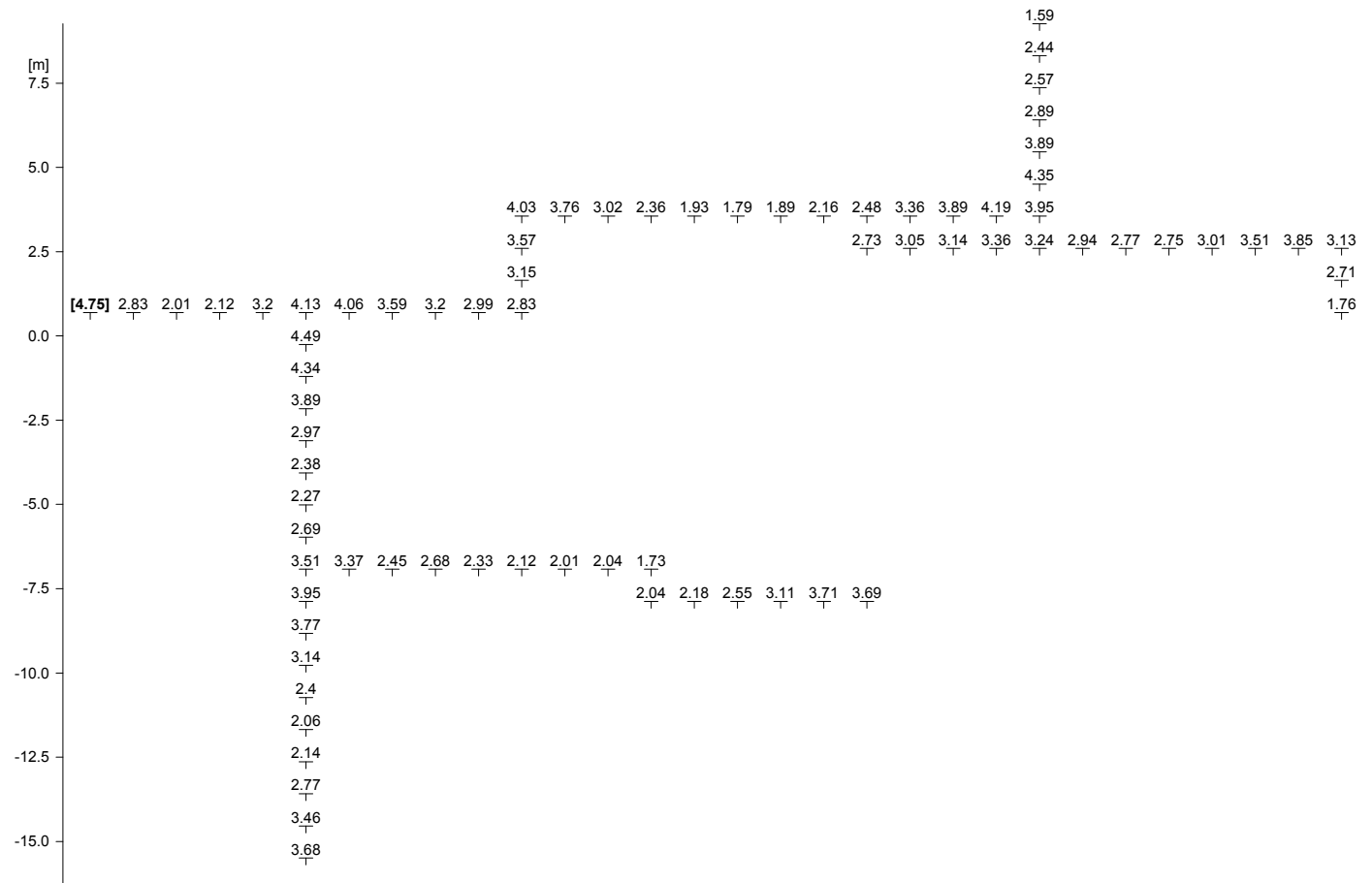

Part1

Required minimum illuminance	:	1 lx
Minimum illuminance	Emin	: 1.5 lx (* 0 lx)
Maximum illuminance	Emax	: 4.7 lx (* 5.2 lx)
Diversity	Emin/Emax	: 1 : 3.25 (0.31) (Threshold value 1:40) (* 1:3.20)
Height	:	0 m
Calculation algorithm used	:	Direct component
Maintenance factor	:	0.8

\*: Values on fine measuring grid (0.1m - 0.5m)!

Object : Level 01 Podium  
Installation : Mount Pleasant Externals  
Project number :  
Date : 07.05.2021

**orlight**

FROM SOURCE TO SITE

## 2 Exterior 1 - Additional Lighting

### 2.3 Calculation results, Exterior 1 - Additional Lighting

#### 2.3.1 Table, Escape Route (E)

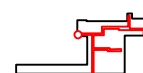
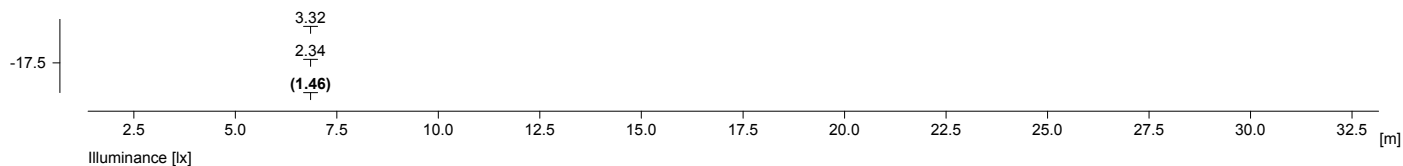

Part2