

NOTE:

This drawing has been prepared from existing unchecked survey information provided by the client. All dimensions are to be checked on site and any discrepancies reported to the designer prior to proceeding. Figured dimensions where given are to take precedence over scaled or site dimensions.

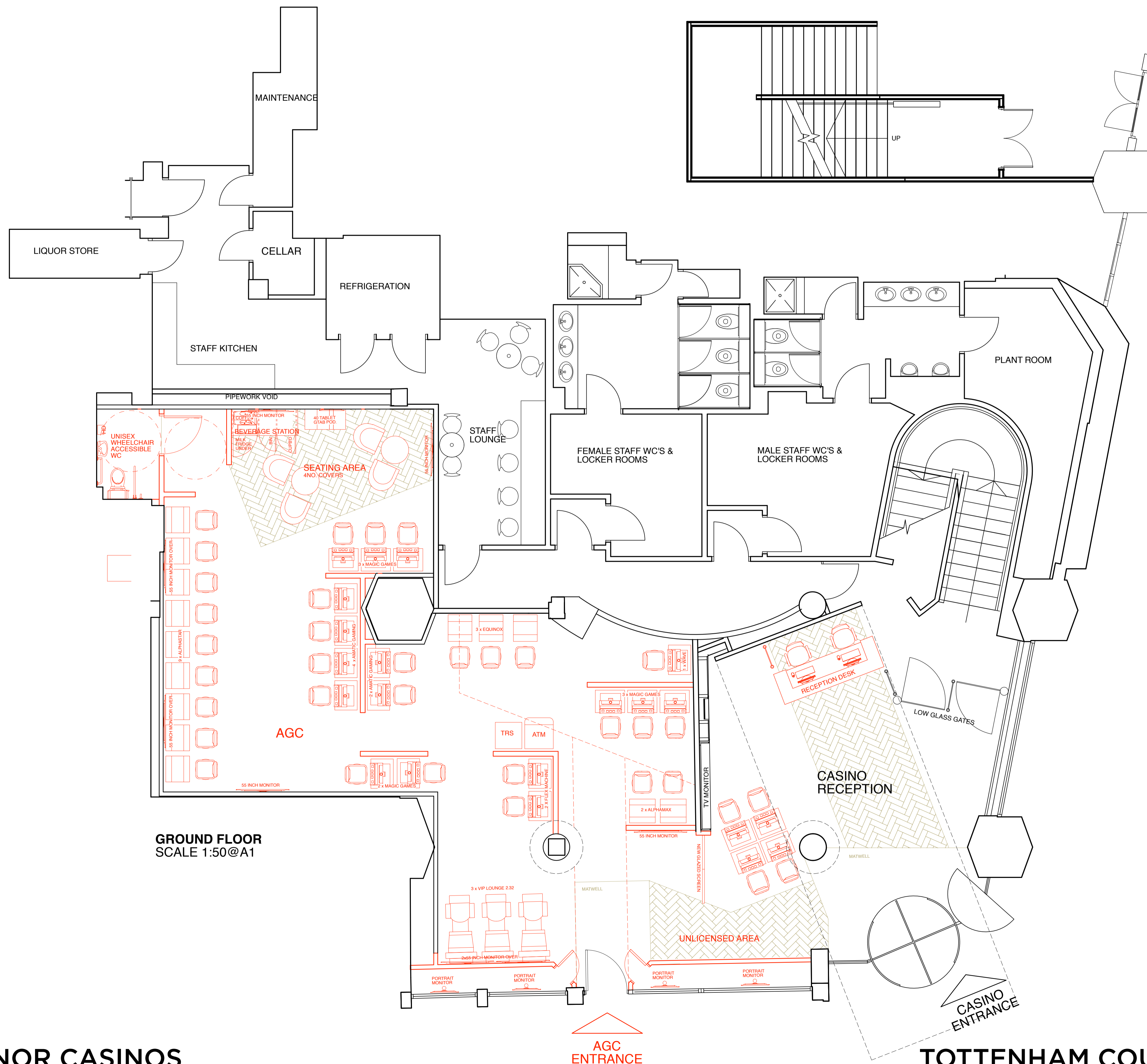
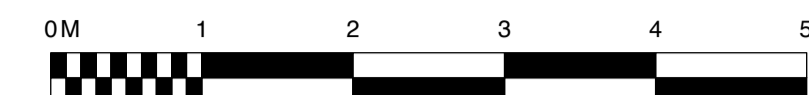

GROUND FLOOR
SCALE 1:50@A1

FOR INFORMATION

REVISION DATE DESCRIPTION

DESIGN AT SOURCE
INTERIOR DESIGN & ARCHITECTURE

Tel: +44 (0) 138 676 0044 E-mail: hello@designatsource.com
Design At Source Ltd, 2-4 High Street, Evesham, Worcestershire, WR11 4HJ

CLIENT: Grosvenor Casinos

JOB TITLE: Tottenham Court Road Casino & AGC
DRAWING TITLE: Proposed Ground Floor Plan OPTION 2A

JOB NO.: 2093

DRAWING NO.: 03 **SCALE:** A1 - 1:100
REVISION: OPT 2A **DATE:** June 2021

DRAWN BY: JEG **CHECKED BY:** AGB

GROSVENOR CASINOS
PROPOSED GROUND FLOOR PLAN OPTION 2A

AGC
ENTRANCE

TOTTENHAM COURT ROAD

© Copyright: This drawing is the property of Design At Source Ltd. Copyright and intellectual property for all information shown is reserved by them and the drawing is issued on the condition that it is not copied either wholly, or in part, without the consent in writing of Design At Source Ltd. Figured dimensions to take precedence over those scaled. All dimensions to be checked on site before commencement of any work or shop drawings. This drawing is to be read in conjunction with the specification when existing.
Design At Source Limited, Registered in England No. 4168514 VAT No. 775 5326 01
Registered address: 2-4 High Street, Evesham, Worcestershire, WR11 4HJ.