

NOTE:

This drawing has been prepared from existing unchecked survey information provided by the client. All dimensions are to be checked on site and any discrepancies reported to the designer prior to proceeding. Figured dimensions where given are to take precedence over scaled or site dimensions.

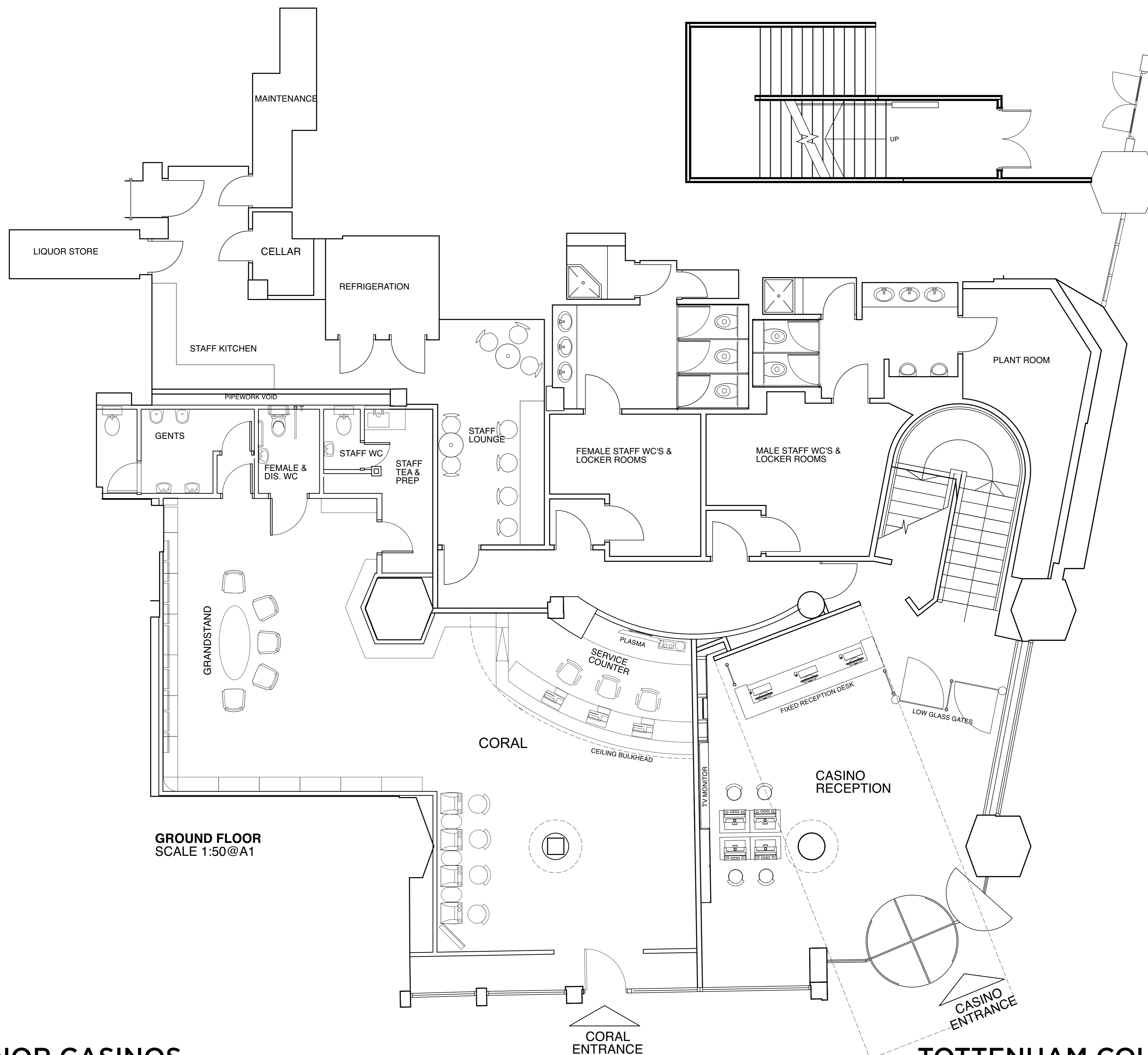
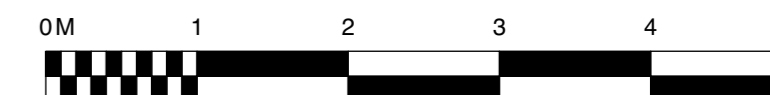

GROSVENOR CASINOS

EXISTING GROUND FLOOR PLAN

TOTTENHAM COURT ROAD

FOR INFORMATION

REVISION DATE DESCRIPTION

DESIGN AT SOURCE

INTERIOR DESIGN & ARCHITECTURE

Tel: +44 (0) 138 676 0044 E-mail: hello@designatsource.com
Design At Source Ltd, 2-4 High Street, Evesham, Worcestershire, WR11 4JU

CLIENT: Grosvenor Casinos

JOB TITLE: Tottenham Court Road Casino & AGC

DRAWING TITLE: Existing Ground Floor Plan

JOB NO: 2093

DRAWING NO: 01 SCALE: A1 - 1:50

REVISION DATE: June 2021

DRAWN BY: JEG CHECKED BY: AGB

© Copyright: This drawing is the property of Design At Source Ltd. Copyright and intellectual property for all information shown is reserved by them and the drawing is issued on the condition that it is not copied either wholly, or in part, without the consent in writing of Design At Source Ltd. Figured dimensions to take precedence over those scaled. All dimensions to be checked on site before commencement of any work or shop drawings. This drawing is to be read in conjunction with the specification when existing.

Design At Source Limited, Registered in England No. 4168514 VAT No. 775 5336 01
Registered address: 2-4 High Street, Evesham, Worcestershire, WR11 4JU