

NOTES:
SUPPLEMENTARY INFORMATION:
 These drawings reflect the current position of the scheme development at RIBA Stage 2, they should be read in conjunction with the following information prepared by Morris+Company:
 - Chenies St Design and Access Statement
 These should also be read in conjunction with the following information, prepared by other consultants, in order to demonstrate a coordinated design proposal at RIBA Stage 2:
 - Structural Engineers Drawings and Report. (Hevne Tillett Steel)
 - MEP Engineers Drawings and Reports. (Thornon Reynolds)
 - Civils Drainage Drawings and Report. (Hevne Tillett Steel)
 - Acoustic Report (Temple Group)
 All plan, elevation and sectional drawn information are based on the 2D survey drawings by Plowman Craven 29/06/18. All existing plans, elevations and sectional drawn information are based on the survey drawings by Plowman Craven 29/06/18.

Key Location Plans

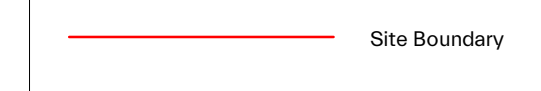

P01	160721	Planning
revision	date	amendment

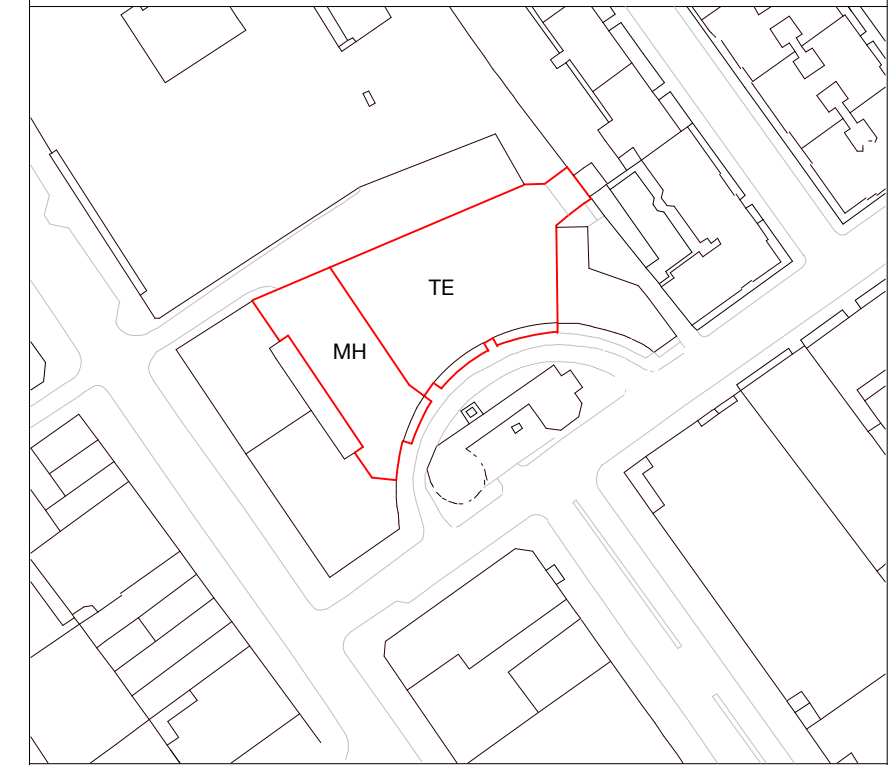
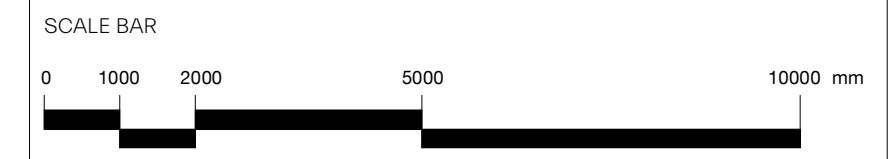
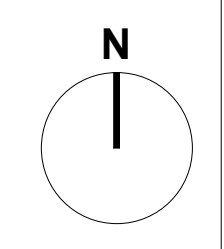

MORRIS+COMPANY
 Unit 7, 16-24 Underwood Street, London N1 7JQ
 Tel: +44 (0)20 7586 7440 Fax: +44 (0)20 7014 3119
 www.morrisandcompany

- Do not scale from this drawing
- All dimensions to be checked on site by the Contractor
- And such dimensions to be their responsibility
- Report all drawing errors and omissions to the Architect
- All dimensions in millimeters unless noted otherwise
- If in doubt ask Contract Administrator

job title									
NORTH CRESCENT									
drawing title /									
PROPOSED LOCATION PLAN									
status	For Information								
date	16/07/21								
scale	As indicated								
projec	originator	zone	level	typ	role	number	status - revision		
A300	MCO	XX	XX	DR	A	06101	PO1		

1 PROPOSED LOCATION PLAN
 06101 1 : 1000