

PROPOSED WALL LIGHT REFER TO PRODUCT SPEC.

WHITE TILE 100MM X 100MM REFER TO PRODUCT SPEC.

PROPOSED 420MM X 500MM SINK REFER TO PRODUCT SPEC.

12MM BIRCH PLY (TREATED WITH WATERPROOF VARNISH) SHELF

PROPOSED NEW MODERN TOILET REFER TO PRODUCT SPEC.

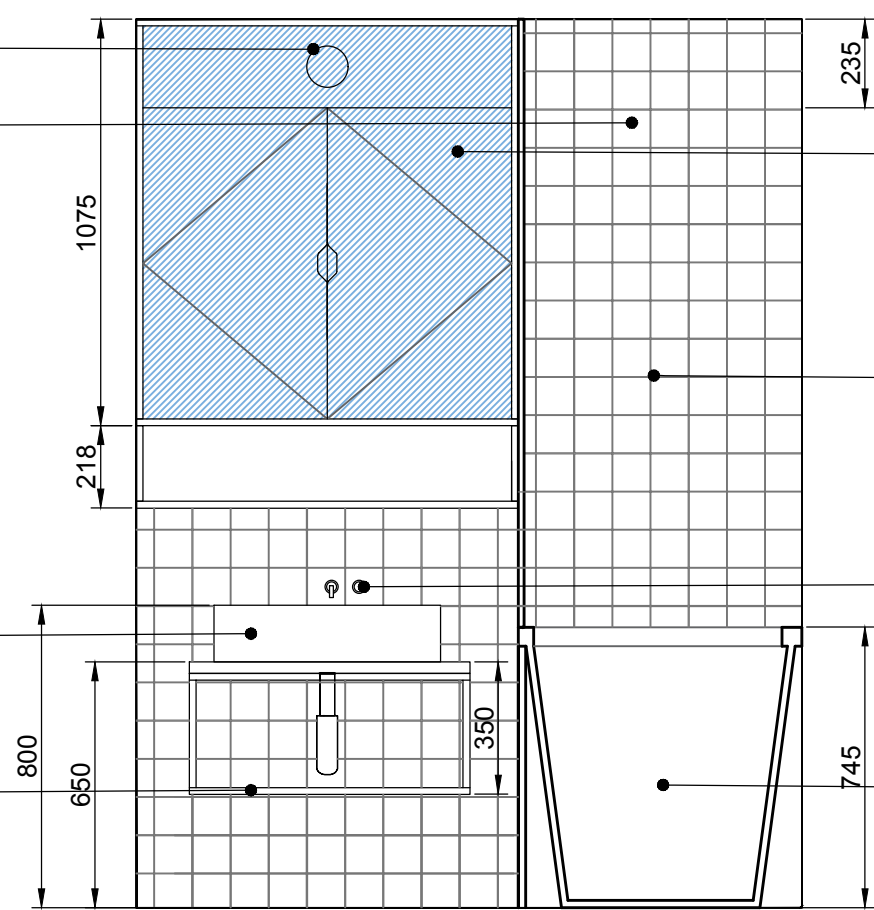

PROPOSED 12MM BIRCH PLY (TREATED WITH WATERPROOF VARNISH) VANITY WITH MIRROR

100MM X 100MM WHITE TILE REFER TO PRODUCT SPEC.

WALL MOUNTED TAPS REFER TO PRODUCT SPECIFICATION

PROPOSED OMNI TUB 1700 MM X 750MM

01 SCALE 1:20 PROPOSED BATHROOM 1 ELEVATION C

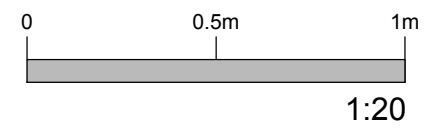

02 SCALE 1:20 PROPOSED BATHROOM 1 ELEVATION D

<p>Do not scale from this drawing. The author of this drawing takes no responsibility for any dimensions obtained by measuring or scaling from this drawing and no reliance may be placed on such dimensions. If no dimension is provided, it is the responsibility of the recipient to ascertain the demisions specifically from the author or by site measurement. The sizing of ALL structural and service elements must always be checked against the relevant engineers drawings. No reliance should be placed upon sizing information shown on this drawing</p>	<p>Drawing Purpose Planning Application & Listed Building Consent</p>	<p>Location 3B Ainsworth Way London NW8 OSR</p>	<p>Description Proposed First Floor Bathroom Elevations C & D</p>	
	<p>Client Elizabeth Shearan</p>	<p>Scale 1:20 @ A3</p> <p>Date 10.04.2021</p>	<p>Drawing Number 2021 403 2 P1-PROPOSED FF BATHROOM ELEV. 2</p> <p>Revision Date 10.04.2021</p>	<p>Revision P2</p>