

Disclaimer: This document and its design content is copyright BMJ Architects ©. No implied licence exists. It shall be read in conjunction with all other associated project information including models, specifications, schedules and related consultants documents. Do not scale from documents. This drawing should not be used to calculate areas for the purposes of valuation or for any purpose other than for which it was produced. All work must comply with relevant British Standards and Building Regulations requirements. All dimensions to be checked on site by the contractor and such dimensions to be their responsibility. Immediately report any discrepancies, errors or omissions on this document to the Originator. If in doubt ASK.

Key:

 Site Boundary

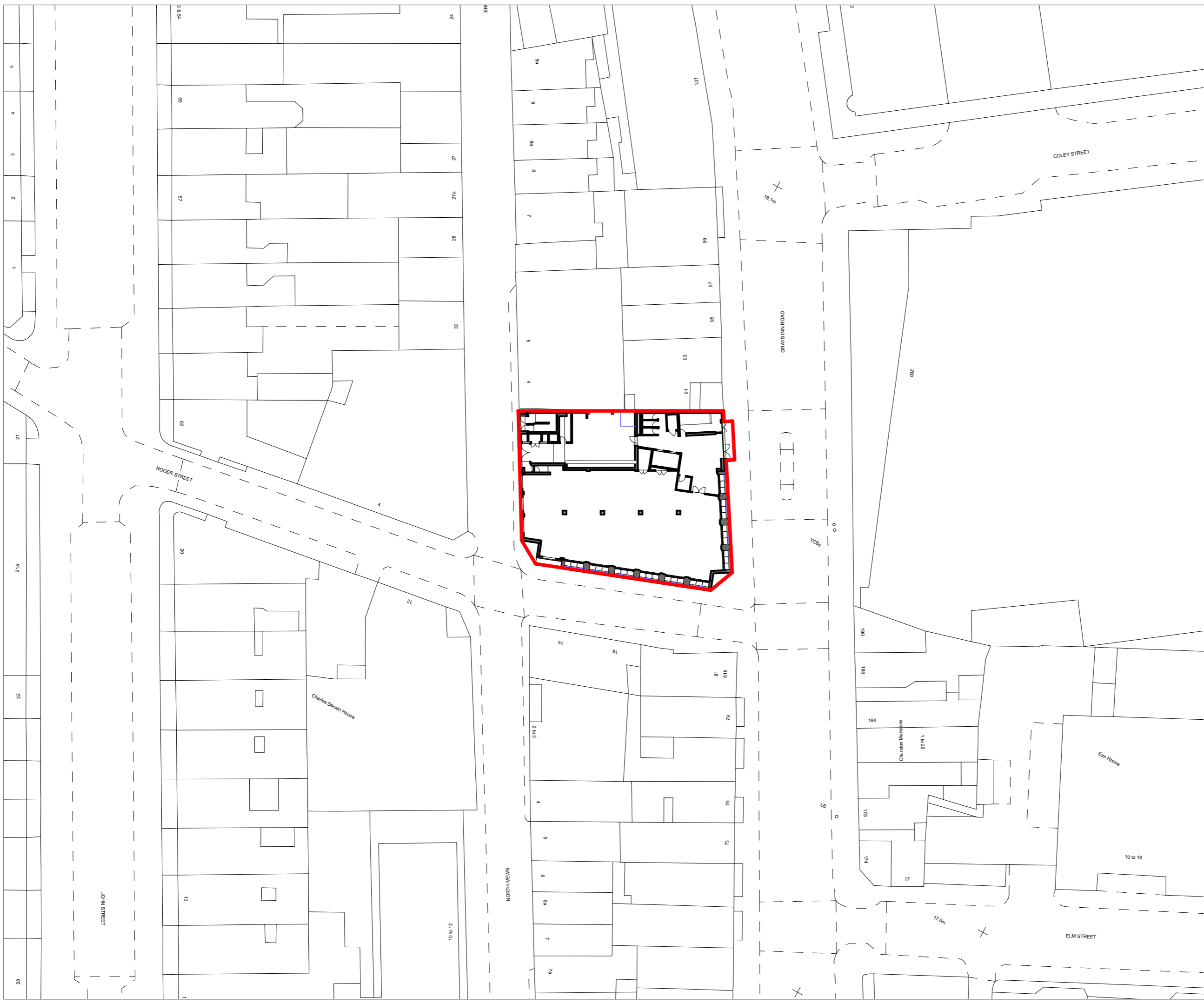
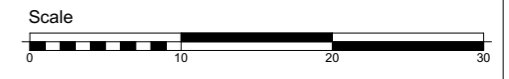
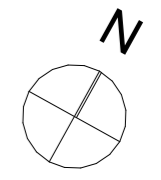

bmj
architects

Glasgow / London
Boswell Mitchell & Johnston
23-24 Easton Street
London WC1X 0DS
+44 20 7833 9974
london@bmjarchitects.co.uk
www.bmjarchitects.co.uk

Client
Clearbell 

Project
85 Grays Inn Road

Document Title
00 Site
Site Plan

Scale(s) @A3 1:500 BMJ Project Ref: [3883]

File Name
Project Originator Volume Level Type Role Number
PA01 - BMJ - ZZ - ZZ - DR - A - 0001

Status Code Suitable for
S2 Information

Revision Code Issued for
P03 Information

© Boswell Mitchell & Johnston Ltd.