



© 2007 STARBUCKS CORPORATION
STARBUCKS
COFFEE COMPANY
 11 Redcliffe Square, London, W1T 1JF
 United Kingdom
 (0)20 7875 4900

THIS DRAWING IS THE PROPERTY OF STARBUCKS COFFEE COMPANY AND IS NOT TO BE REPRODUCED, COPIED, EITHER WHOLLY OR IN PART, OR TRANSMITTED IN ANY FORM OR BY ANY MEANS, WITHOUT THE WRITTEN PERMISSION OF STARBUCKS COFFEE COMPANY. ANY UNAUTHORIZED REPRODUCTION OR TRANSMISSION OF THIS DRAWING IS STRICTLY PROHIBITED AND WILL BE PROSECUTED TO THE FULL EXTENT OF THE LAW.

ALL DRAWINGS TO BE READ IN CONJUNCTION WITH UK STANDARD DETAIL MANUAL

REV	DATE	DESCRIPTION
A	02/09/07	Seating revised

FOR PLANNING
 24/09/07

SITE ADDRESS:
112-116 New Oxford St
LONDON
WC1A 1HH

COUNTRY:
ENGLAND

DESIGNER No. 1
 P.F.L. CONCEPT
 P.F.L. DESIGNED
 P.F.L. CHECKED
 STORE PLANNER: A. COOK

SCALE: 1:50 @ A1
 (DO NOT SCALE DRAWINGS)

DRAWING TITLE:
OUTDOOR SEATING PLAN

DRAWING NUMBER: **A2.1**
 REVISION: **A**

PROJECT CODE: S12164

FOR PLANNING

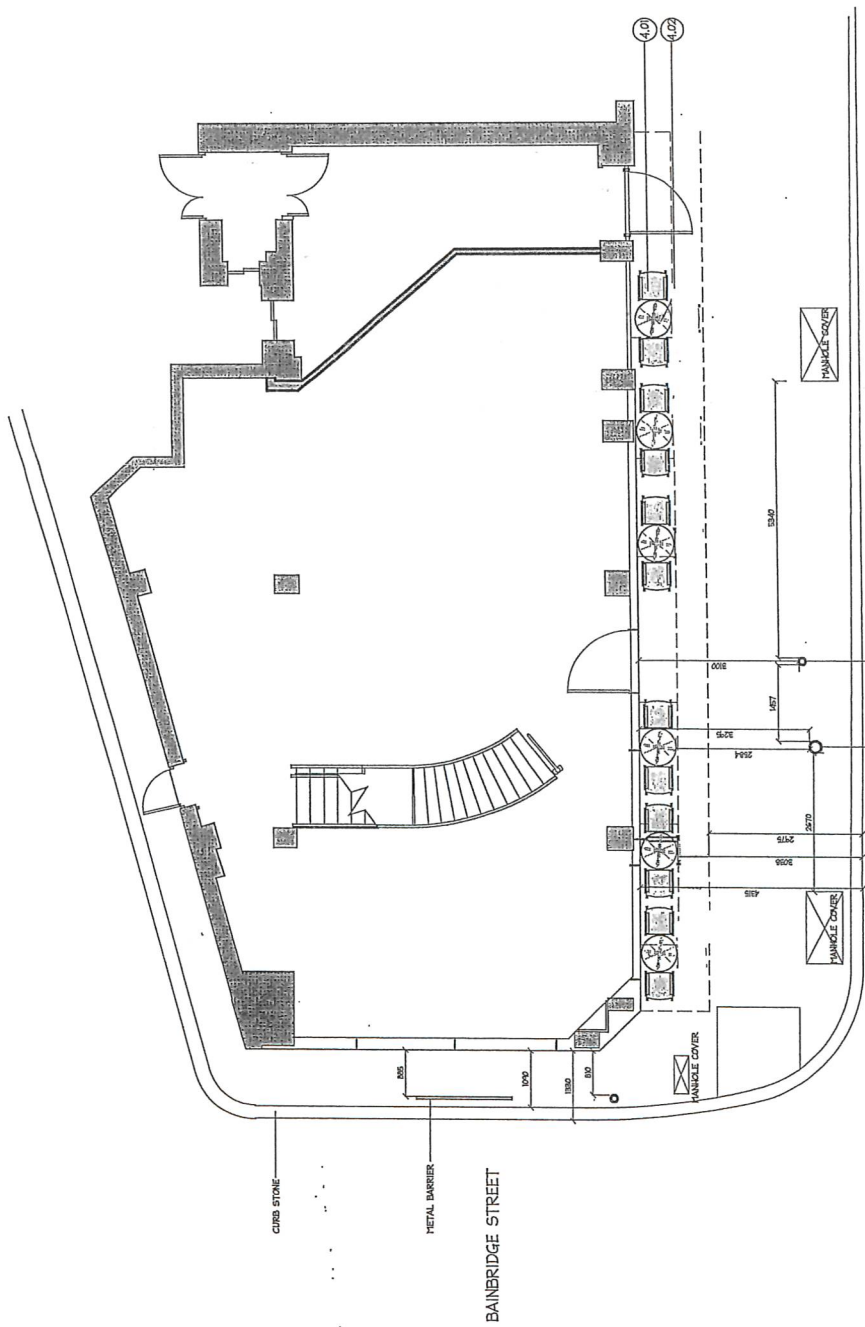

NEW OXFORD STREET

BAINBRIDGE STREET



PROPOSED OUTDOOR SEATING PLAN
 SCALE 1:50

DRAWING ORIGINATED FROM:
 THIS DRAWING HAS BEEN CONSTRUCTED FROM A FULL SITE SURVEY CONDUCTED BY RPA.
 THIS DRAWING HAS BEEN CONSTRUCTED FROM DRAWINGS PRODUCED BY BLUE 9.

STANDARD DETAIL REFERENCES:
 ALL REFERENCES TO STANDARD DETAIL NUMBERS ARE REFERENCED TO STANDARD DETAIL MANUAL, NOVEMBER 2004 ISSUE.