

SKODA ENTERING IN FORWARD GEAR FROM THE WEST /
EXITING IN REVERSE GEAR TO THE EAST

7 to 9

5b

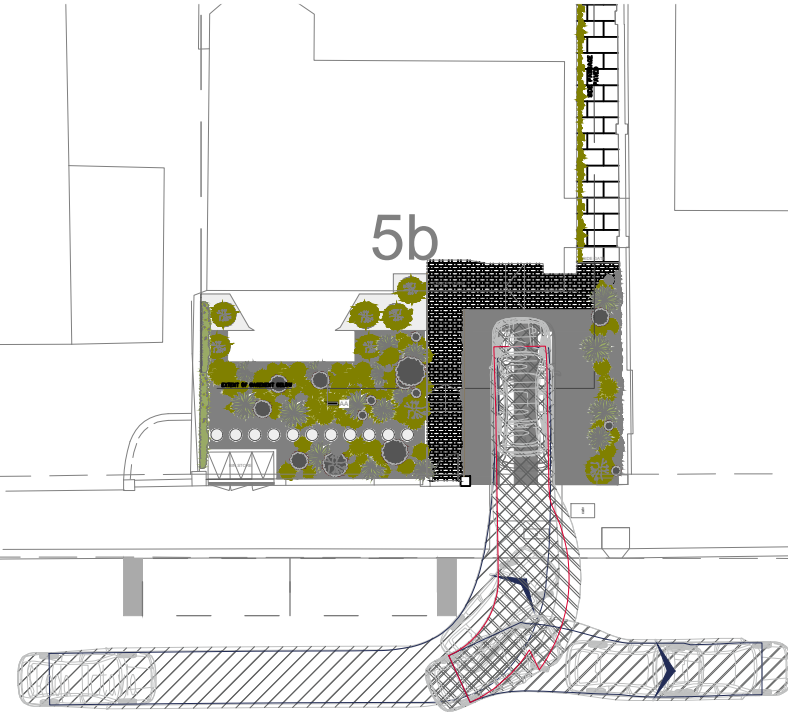

SKODA ENTERING IN FORWARD GEAR FROM THE EAST /
EXITING IN REVERSE GEAR TO THE WEST

7 to 9

5b

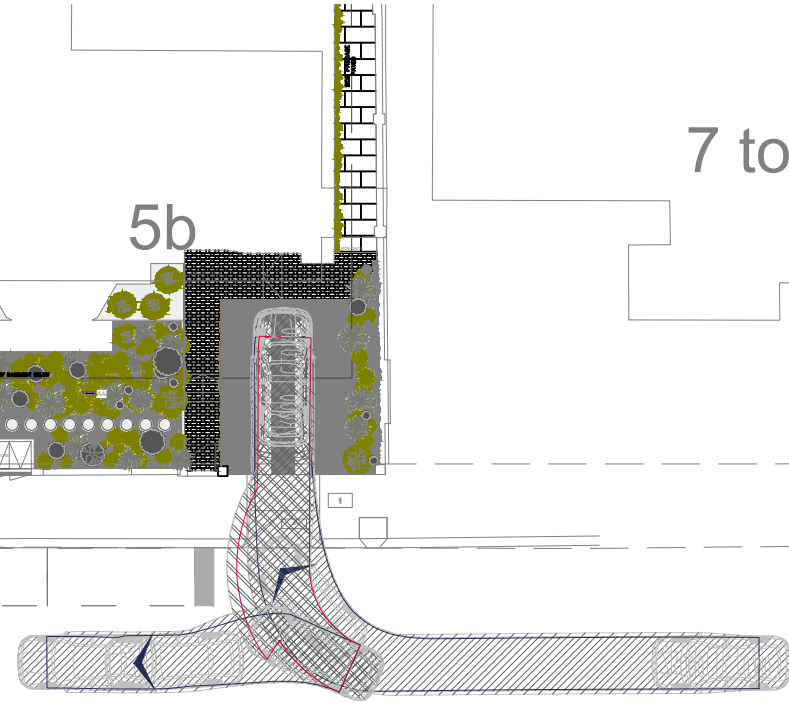

SKODA ENTERING IN REVERSE GEAR FROM THE WEST /
EXITING IN FORWARD GEAR TO THE EAST

7 to 9

5b

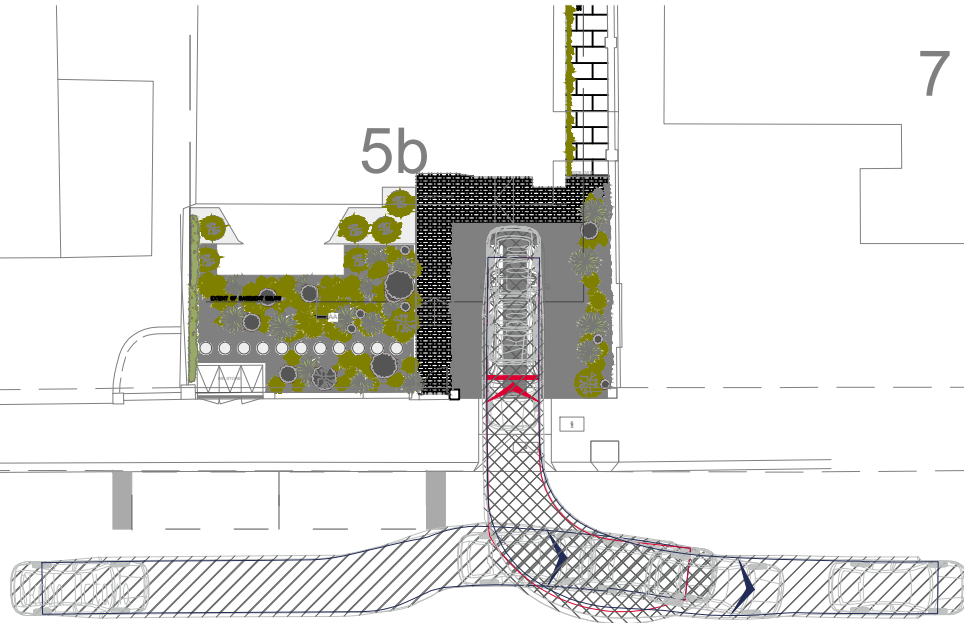

SKODA ENTERING IN REVERSE GEAR FROM THE EAST /
EXITING IN FORWARD GEAR TO THE WEST

7 to 9

5b

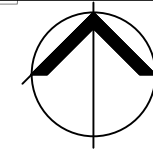
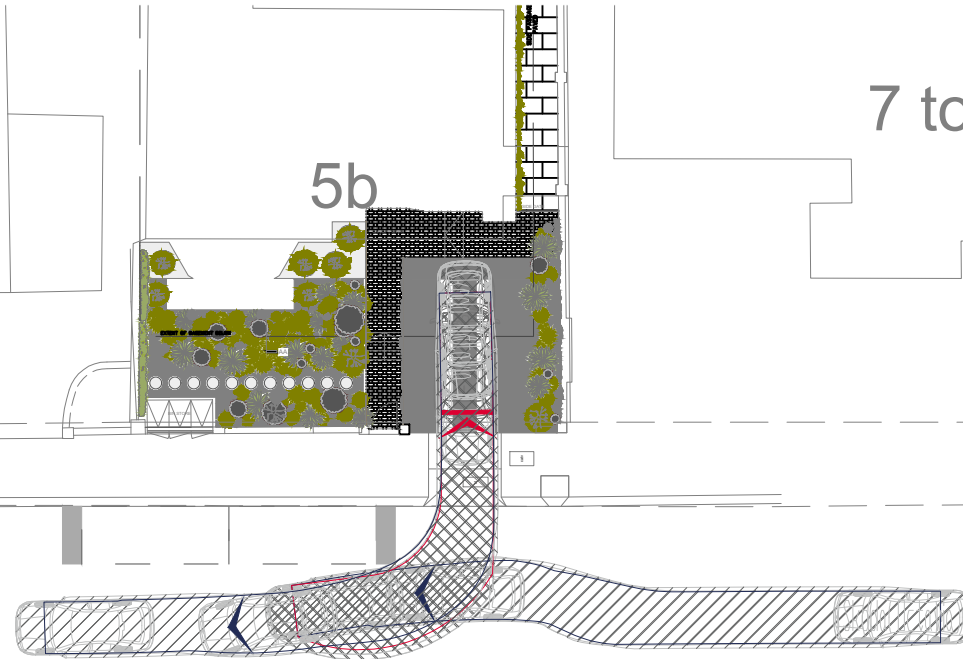

NOTES:
1. THIS DRAWING IS INDICATIVE AND SUBJECT TO DISCUSSIONS WITH LOCAL & NATIONAL HIGHWAY AUTHORITIES. THIS DESIGN IS ALSO SUBJECT TO CONFIRMATION OF LAND OWNERSHIP, TOPOGRAPHY, LOCATION OF STATUTORY SERVICES, DETAILED DESIGN AND TRAFFIC MODELLING.
2. THIS DRAWING IS BASED UPON DRAWING NUMBER TRS115_P_GA_PLAN&OS SUPPLIED BY TR STUDIO AND ICENI PROJECTS LTD. SHALL NOT BE LIABLE FOR ANY INACCURACIES OR DEFICIENCIES.

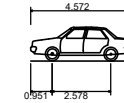

Skoda Octavia
Overall Length 4.572m
Overall Width 1.769m
Overall Body Height 1.488m
Min Body Ground Clearance 0.249m
Max Track Width 1.713m
Lock to lock time 4.00s
Kerb to Kerb Turning Radius 5.100m

ICENI PROJECTS LIMITED
DA VINCI HOUSE
44 SAFFRON HILL
LONDON
EC1N 8FH

T 020 3640 8508
mail@iceniprojects.com



CLIENT _____

TR STUDIO

PROJECT _____

5B PRINCE ARTHUR ROAD

TITLE _____

SWEPT PATH ANALYSIS

DRAWN BY JP	CHECKED BY ME	APPROVED BY ME
	16/07/2021	16/07/2021

SCALE @ A3 1:250	DATE 16/07/2021
---------------------	--------------------

PROJECT NO. 21-T098	DRAWING NO. 01	REV. -
------------------------	-------------------	-----------

iceni Projects accept no responsibility for any unauthorised amendments to this drawing. Only figured dimensions are to be worked to.