

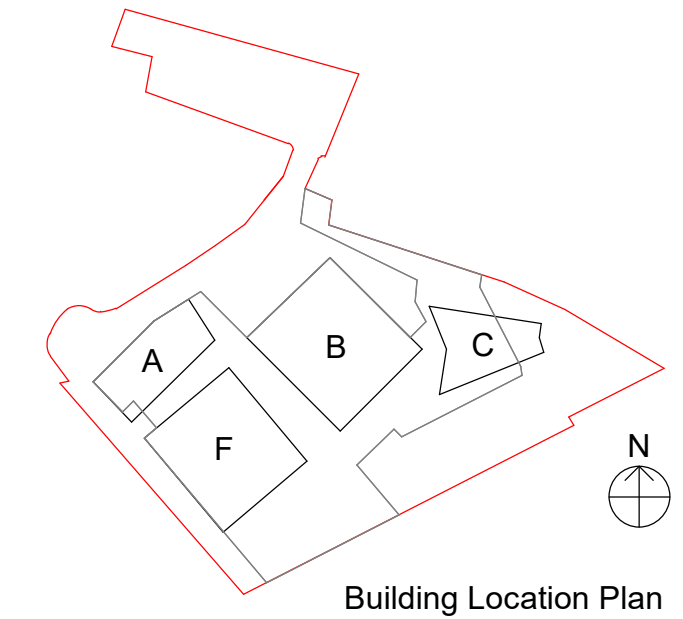

GENERAL NOTES

SETTING OUT - DO NOT SCALE from this drawing. use figured dimensions **ONLY**. if in doubt, ASK! Dimensions are shown to structural face generally, or to finished face of ducts and lining. All dimensions are shown in millimeters unless otherwise indicated. Angular dimensions are shown in decimal degrees to the nearest whole degree. Where items are to be fabricated off-site, site dimensions are to be used and confirmed prior to ordering or manufacturing.

All information on this drawing must be read in conjunction with relevant series and specifications.



Drawing replicates AAM drawing ref: 1095_00_07_098

Revisions from previous Planning submission numbered (refer to supporting document for full description): Basement wall realignment (1)&(2); Escape stair relocation (3); Supermarket wall realignment (4); internal stair relocation (5); infill of double-height void spaces (6); Column alterations (7); Swapping of Affordable Workspace and Substation locations (8); Removal of B2 level below Block A and creation of pool plant room under car-park ramp (9); Adjustment of internal floor level for supermarket (10).

P1	Initial PTAL issue (with revision clouds)	MK	CJ	29.06.21
rev	description	drawn	checked	date
revisions				
status:		PLANNING		
reason for issue:				
This drawing is protected under The Copyright, Designs and Patents Act 1988. This drawing is produced for PLANNING PURPOSES ONLY and is not to be used for construction.				

P T A L
| Architects | Masterplanners | Designers |

Peter Taylor Associates Limited
Khiara House, 25-26 Poland Street
Soho, London W1F 8GN
T: +44 (0)20 7495 3837
W: www.ptal.co.uk



project:	CAMDEN GOODS YARD PHASE 2A			
title:	Lower Carpark Plan (Level B2) Masterplan Tenure Drawings			
scale:	1 : 500	@ A1		
date:	27/04/21			
drawn:	MK			
checked:	CJ			
file name:	originator:	zone:	level: type: role: dwg number: revision:	
CGY0B - PTA - ZZZ - B2 - DR - AR - 90001				P1

PTAL Project Number: 200035

