

WALL SECTION - B4

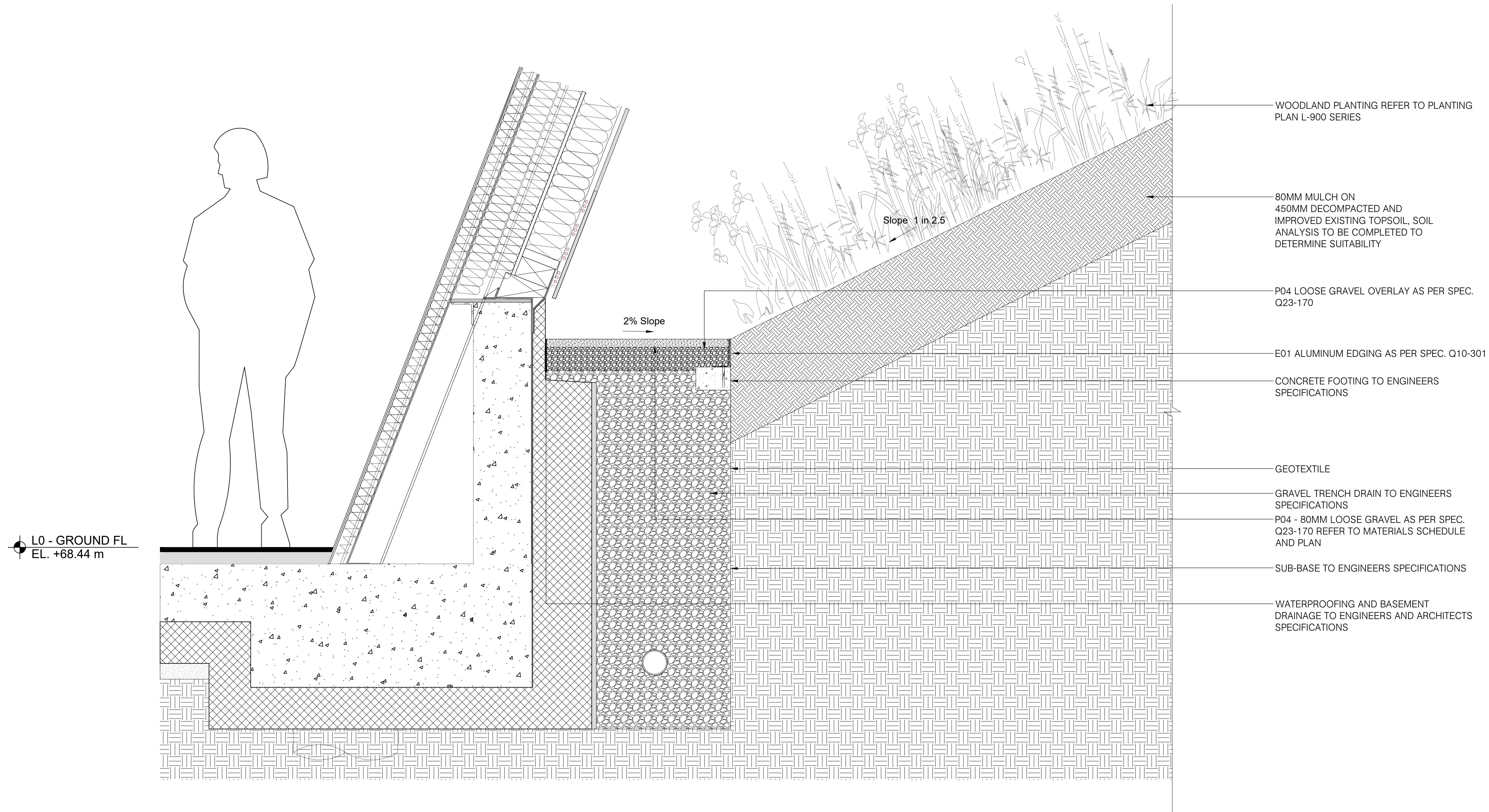
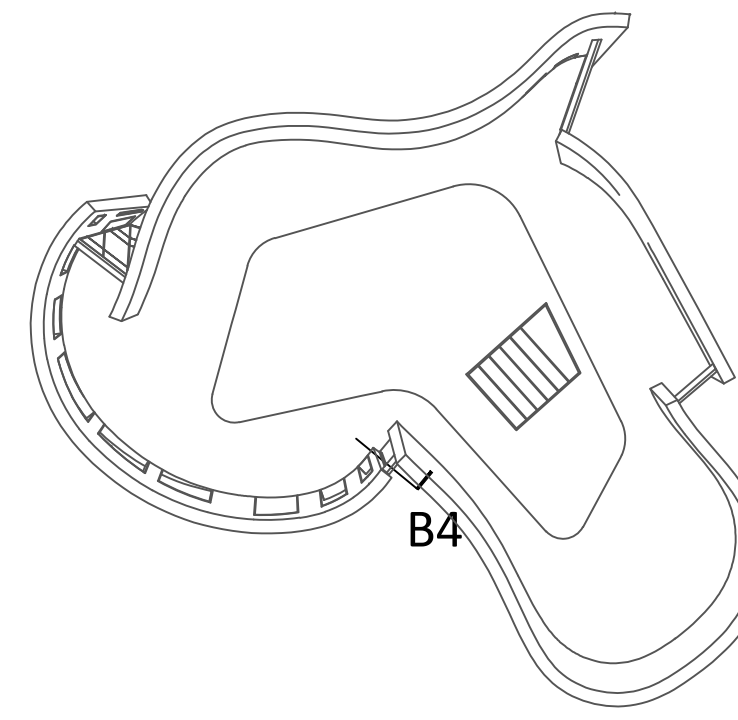

- Notes
1. This document should not be relied on or used in circumstances other than those for which it was prepared and for which Martha Schwartz Partners was commissioned. Martha Schwartz Partners accepts no responsibility for this document to any other party other than the person by whom it was commissioned.
2. NOT FOR CONSTRUCTION
3. Do not scale drawing. Figured dimensions prevail in all cases.
4. To be read in conjunction with all other drawings and specifications including but not limited to structural and service engineers' drawings.
5. Where an item is covered by drawings to different scales the larger scale drawing is to prevail.
6. All dimensions are in millimeters, unless stated otherwise.
7. For retaining walls, please refer to Engineers drawings and specifications.

04	05/07/2021	Stage 4 - Issue For Planning
03	09/04/2021	Stage 4 - Issue For Tender
02	12/06/2020	Stage 4 - Issue For Tender
01	24/04/2020	Stage 4

Purpose of Issue
Stage 4 - Issue For Tender

Client
Maggie's Trading Ltd.
20 St. James St
London
W6 9RW

Landscape Architect
Martha Schwartz Partners Ltd
c/o GC Accountants
283-285 Green Lanes
www.marthaschwartz.com

© copyright 2017 Martha Schwartz Partners Ltd.

Project Title

**Maggie's Centre
at the Royal Free**

Drawing Title	Building Interface Details
---------------	-----------------------------------

Project Number	0126
----------------	-------------

Drawing Number
007562-MSP-00-GF-DR-L-701

Scale - A1 1:10	Revision 04	North
---------------------------	-----------------------	-------

Drawn JK	Approved MK
--------------------	-----------------------

Date **05/07/2021**