

SHEET NOTES

1. Do not scale from this drawing. All dimensions are indicative and they need to be checked on site by the contractor before construction proceeds and prior to the fabrication of any component.
2. This drawing is based on survey information by others.
3. All dimensions to be in millimetres unless otherwise specified.
4. All building works are to be carried out in accordance with current British/European Standards and the Building Regulations.
5. Refer to Structural Engineer's drawings, details and specifications for all structural components.
6. Refer to Mechanical & Electrical Engineer's drawings, schedules and specifications for all services.
7. This drawing is to be read in conjunction with the Architectural Specifications.
8. Manufacturers' guidance and recommendations to be followed for installation of all construction components.
9. For occupied buildings, safe, clear access and means of escape to be maintained at all times during works in accordance with the Construction Phase Health and Safety Plan.
10. Any discrepancies between the drawing, the Specifications, Schedules, Bill of Quantities/Schedule of Works shall be brought to the attention of the Architect/CA for resolution prior to placing orders or to construction.
11. Any discrepancies between contract documents and site conditions shall be brought to the attention of the Architect/CA for resolution prior to placing orders or to construction.
12. The contractor shall be responsible for completing the detailed design of all elements included within the Contractor Design Portion (CDP) to the prescribed performance standards as indicated within the contract documents. All CDP details shall be supplied by the contractor to the CA for review prior to fabrication.

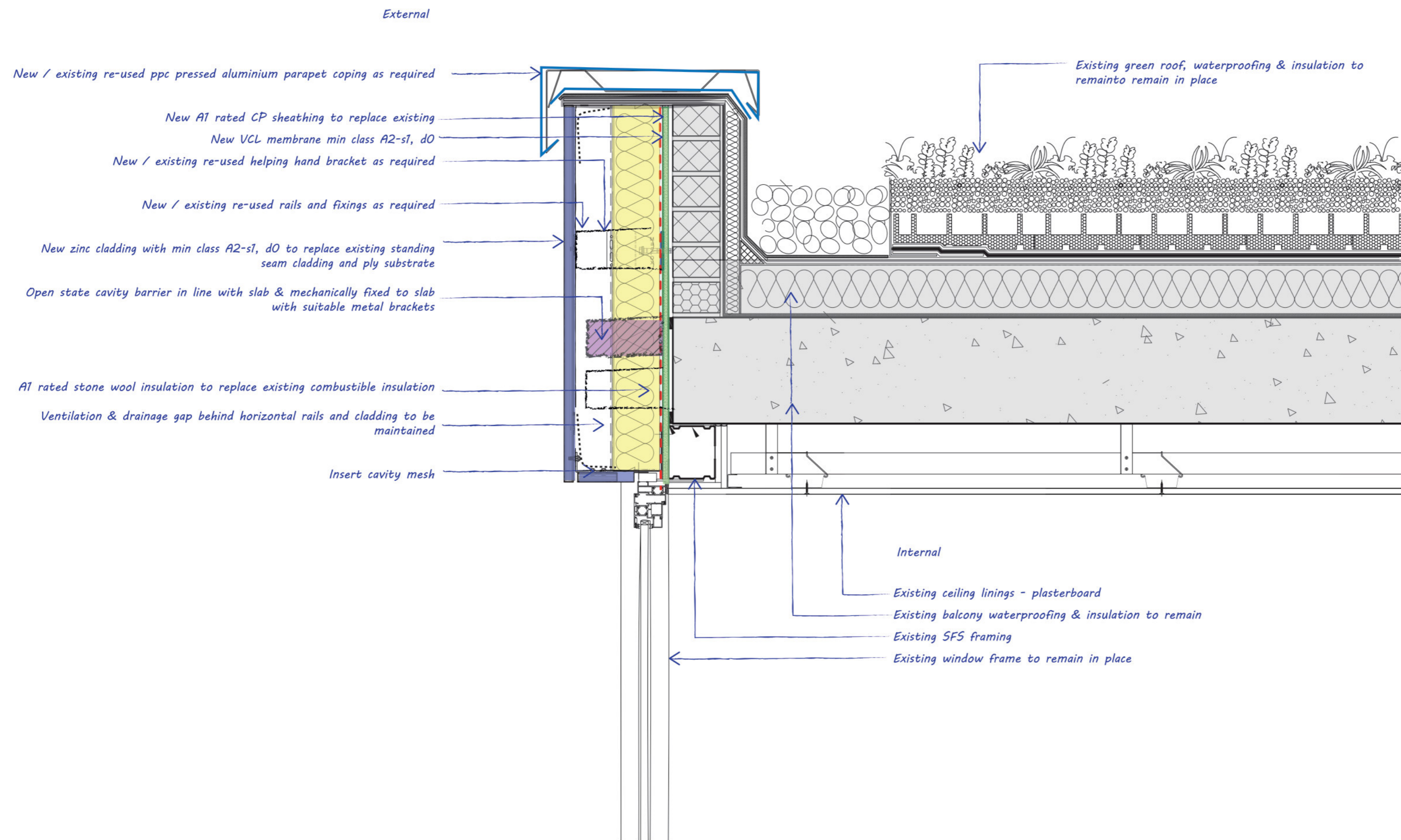

Note:
Base drawing information and annotation has been supplied by the original architects - Osel Architects Ltd.



P02	BP	SC	18/06/21	Planning issue
P01	BP	SC	16/06/21	For comment

REVISION	DRAWN	CHECKED	DATE	DESCRIPTION
----------	-------	---------	------	-------------

DRAWING ISSUE
Planning

CLIENT
**Trident Building Consultancy
8 Angel Court, London
EC2R 7HP**



Studio 3 Blue Lion Place, 237 Long Lane
London, SE1 4PU
 The Centrum Building, 38 Queen Street
Glasgow, G1 3DX
www.ecda.co.uk

PROJECT TITLE
**Melrose Apartments
Cladding Remediation Works**

DRAWING TITLE
**Illustrative details
Zinc cladding**

SCALE	DRAWN
1:5 @ A2	BP
DATE	CHECKED
14/06/21	SC

Project Code - Originator - Vol - Level - Type - Role - Number	Status	Rev.
210128- ECD -XX-XX- DR-A-30443	S1	P02