

SHEET NOTES

- All dimensions are indicative and they need to be checked on site by the contractor before construction proceeds and prior to the fabrication of any component.
- This drawing is based on survey information by others.
- All dimensions to be in millimetres unless otherwise specified.
- All building works are to be carried out in accordance with current British/European Standards and the Building Regulations.
- Refer to Structural Engineer's drawings, details and specifications for all structural components.
- Refer to Mechanical & Electrical Engineer's drawings, schedules and specifications for all services.
- This drawing is to be read in conjunction with the Design and Access Statement submitted with the planning application.
- For occupied buildings, safe, clear access and means of escape to be maintained at all times during works in accordance with the Construction Phase Health and Safety Plan.
- Any discrepancies between the drawings and site conditions shall be brought to the attention of the Architect/CA for resolution.

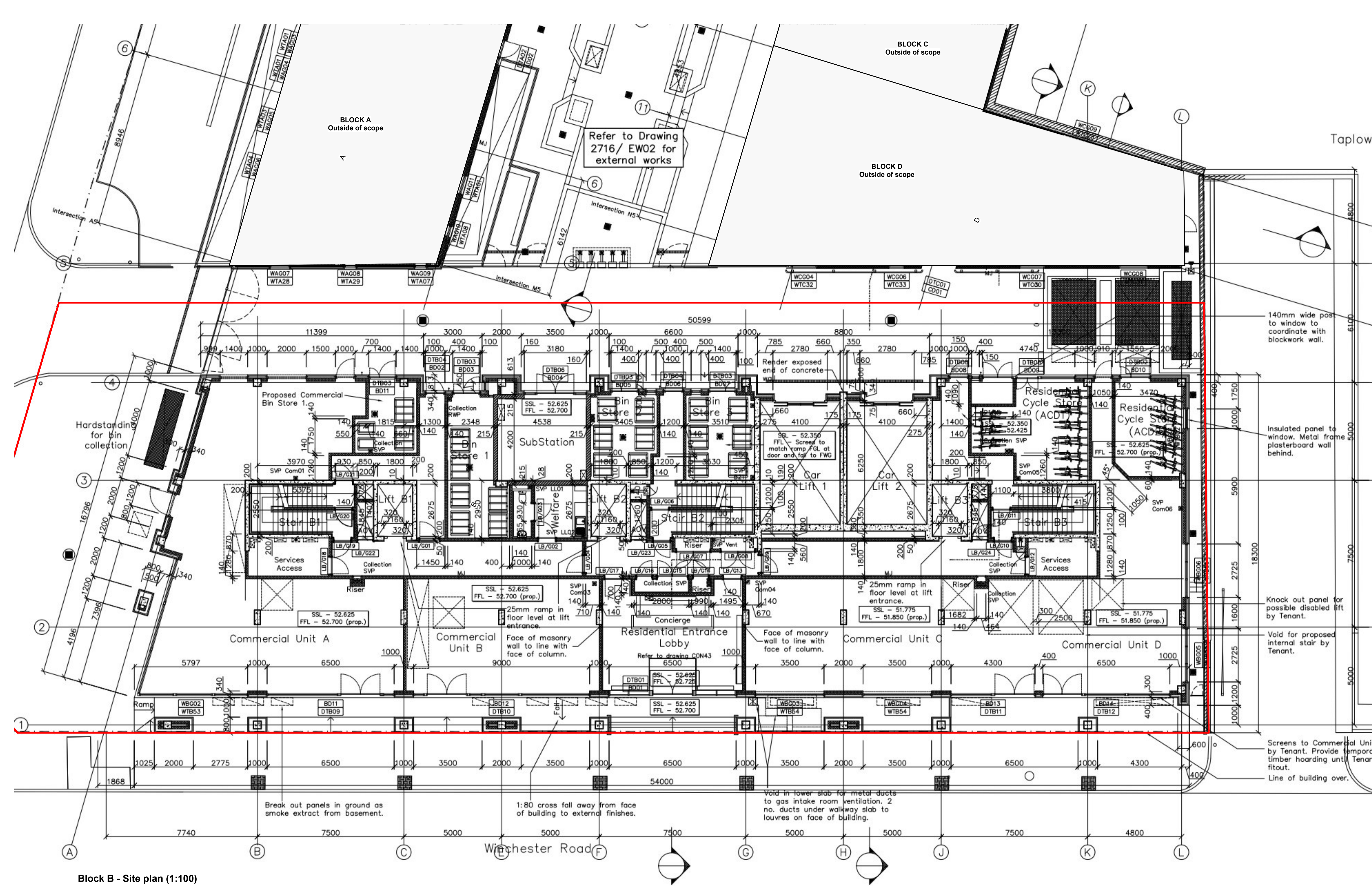

Block B - Site plan (1:100)

AS BUILT
DATE: 17.06.10

Osel
Architects and
development consultants

PROJECT: PROPOSED DEVELOPMENT
2-10 WINCHESTER ROAD
LONDON W8 3

CLIENT: YEWACRE LIMITED

DRAWING: GENERAL ARRANGEMENT
GROUND FLOOR PLAN
BLOCK B

DRAWING No.: 2716/GA105

REV: S

Note:
Base drawing information and
annotation has been supplied by the
original architects - Osel Architects Ltd.

PO	BP	SC	18/06/21	Planning issue
PO	BP	SC	18/06/21	For comment
PO	BP	SC	15/06/21	For comment

REVISION
DRAWN BY
CHECKED BY
DATE
DESCRIPTION

DRAWING ISSUE
Planning

CLIENT
Trident Building Consultancy
8 Angel Court, London
EC2R 7HP

ECD Architects
ENERGY CONSCIOUS DESIGN
www.ecda.co.uk

- Studio 3 Blue Lion Place, 237 Long Lane
London, SE1 4PU
- The Centrum Building, 38 Queen Street
Glasgow, G1 3DX

PROJECT TITLE
**Melrose Apartments
Cladding Remediation Works**

DRAWING TITLE
**Site plan
Block B**

SCALE
As indicated @ A1

DRAWN
BP

DATE
09/06/21

CHECKED
SC

Project Code - Originator - Vol - Level - Type - Role - Number
210128-ECD-XX-00-DR-A-30402 S1 P03