

**DETAIL 3. TYPICAL WATERPROOFING DETAIL AT CAPPING BEAM-GRADE 3 (SOUTH BOUNDARY)**  
1:10

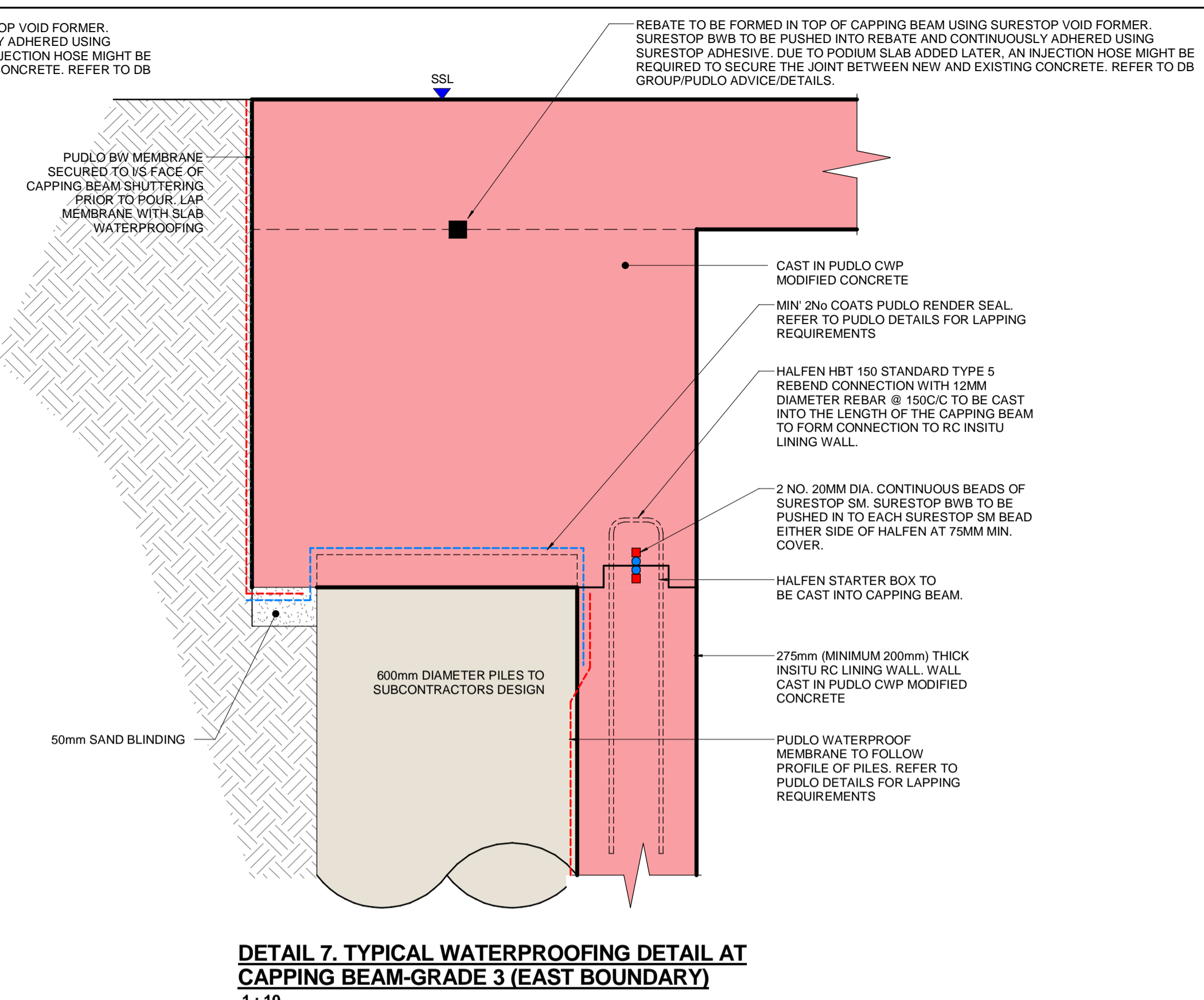

**DETAIL 7. TYPICAL WATERPROOFING DETAIL AT CAPPING BEAM-GRADE 3 (EAST BOUNDARY)**  
1:10

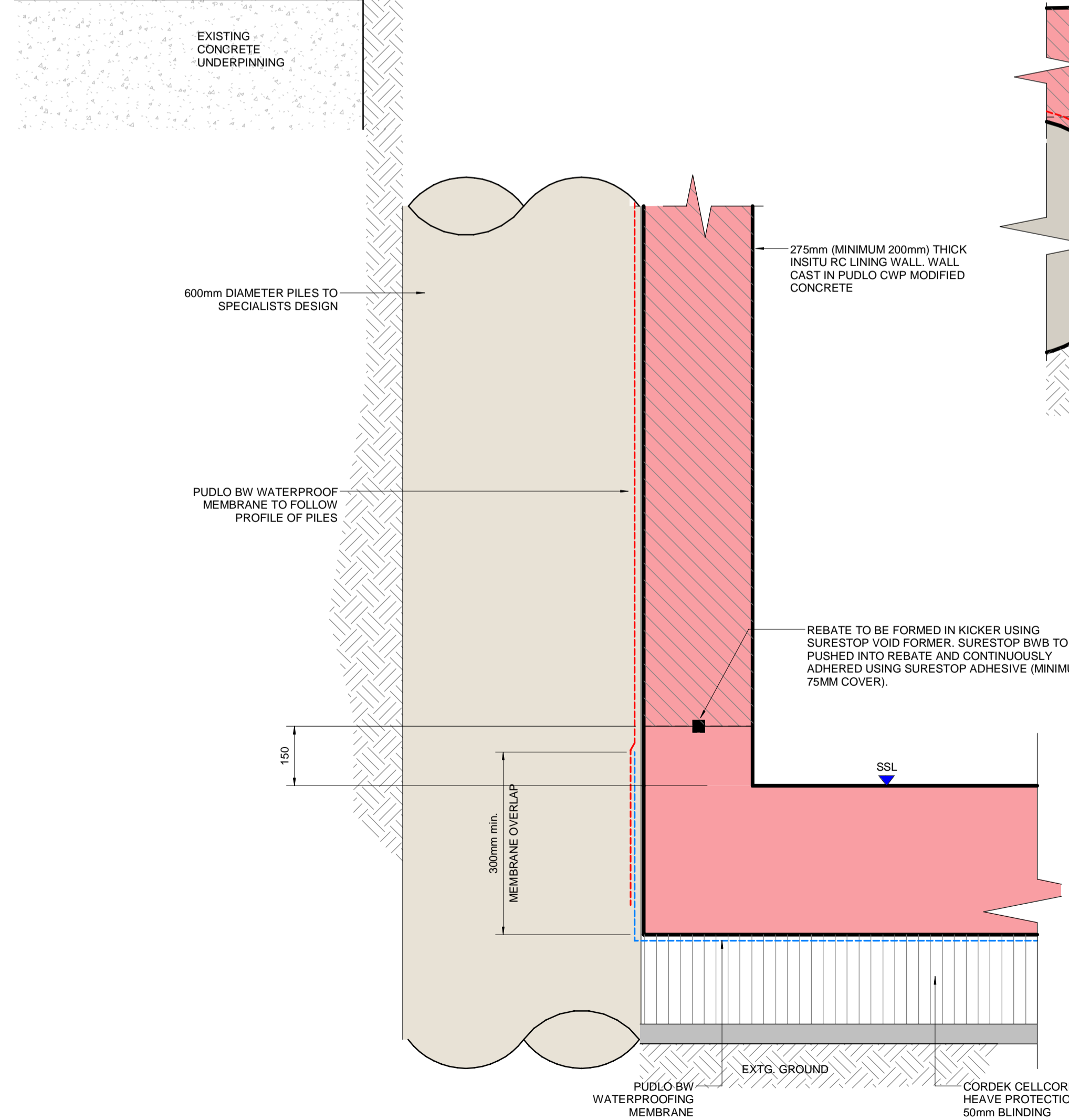

**DETAIL 1. TYPICAL WATERPROOFING DETAIL AT BASEMENT SLAB JUNCTION WITH RETAINING WALL-GRADE 3**  
1:10

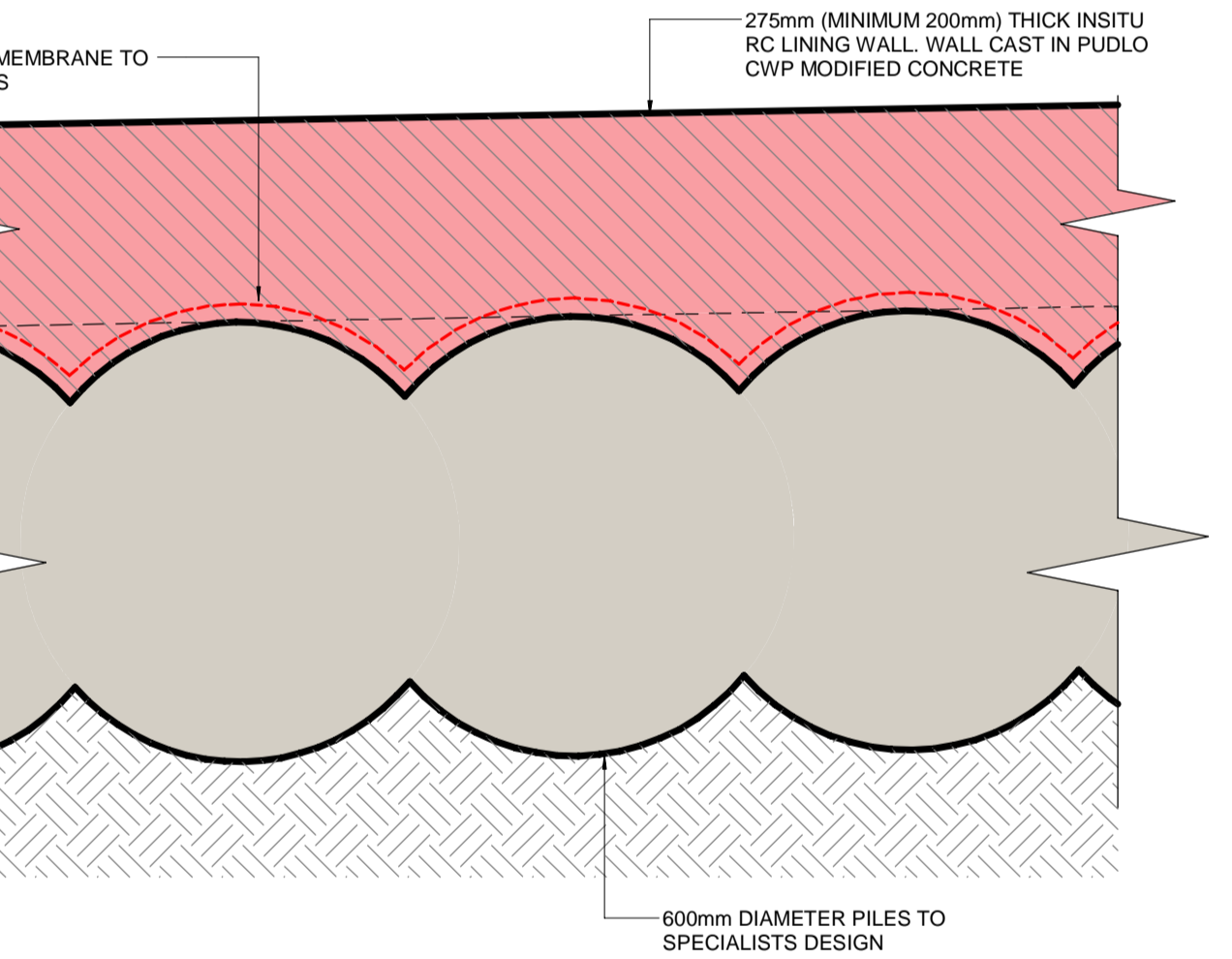

**DETAIL 6. TYPICAL SECANT PILED WALL WATERPROOFING DETAIL - GRADE 3**  
1:10

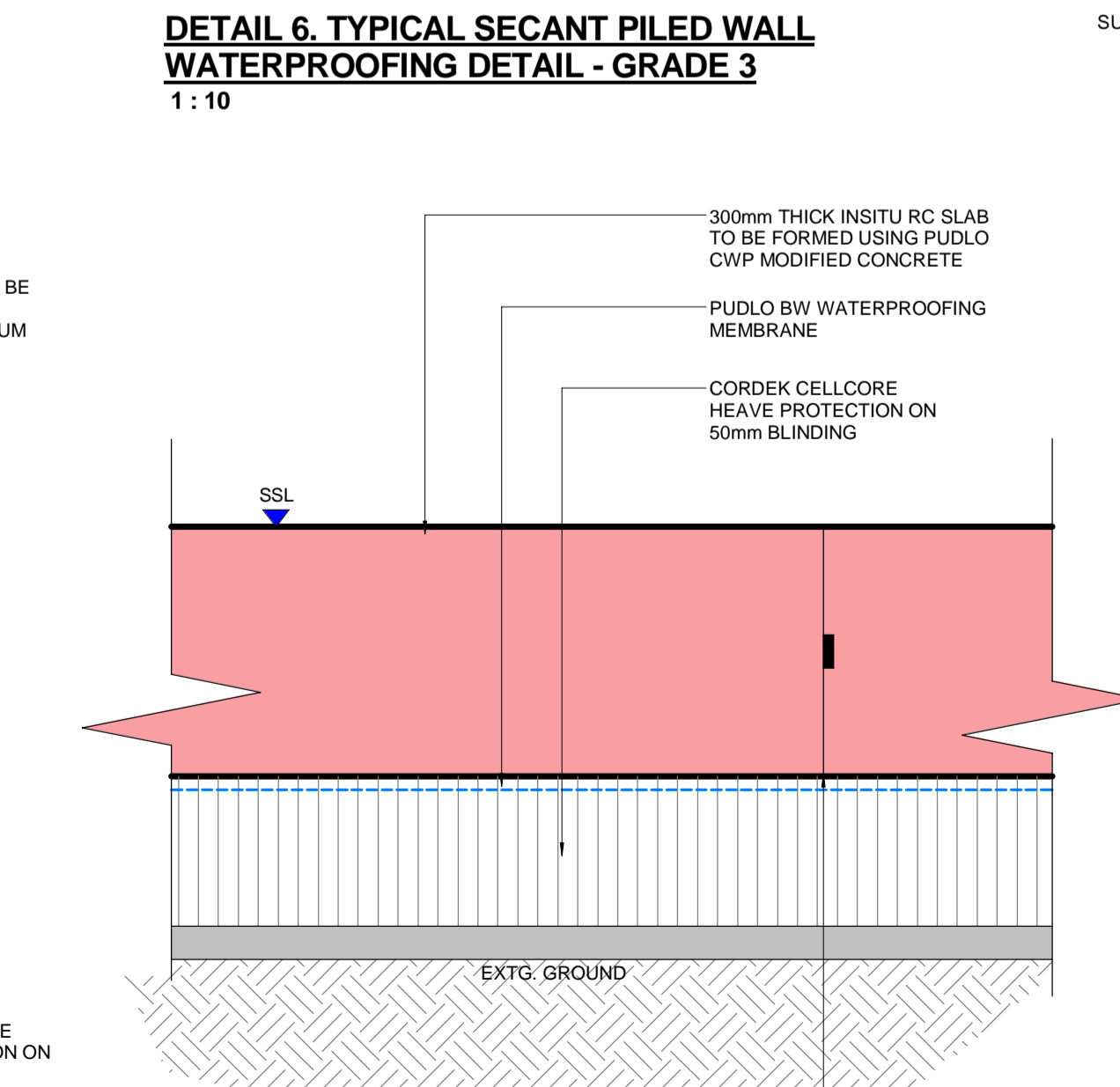

**DETAIL 2. TYPICAL BASEMENT SLAB CONSTRUCTION-GRADE 3**  
1:10

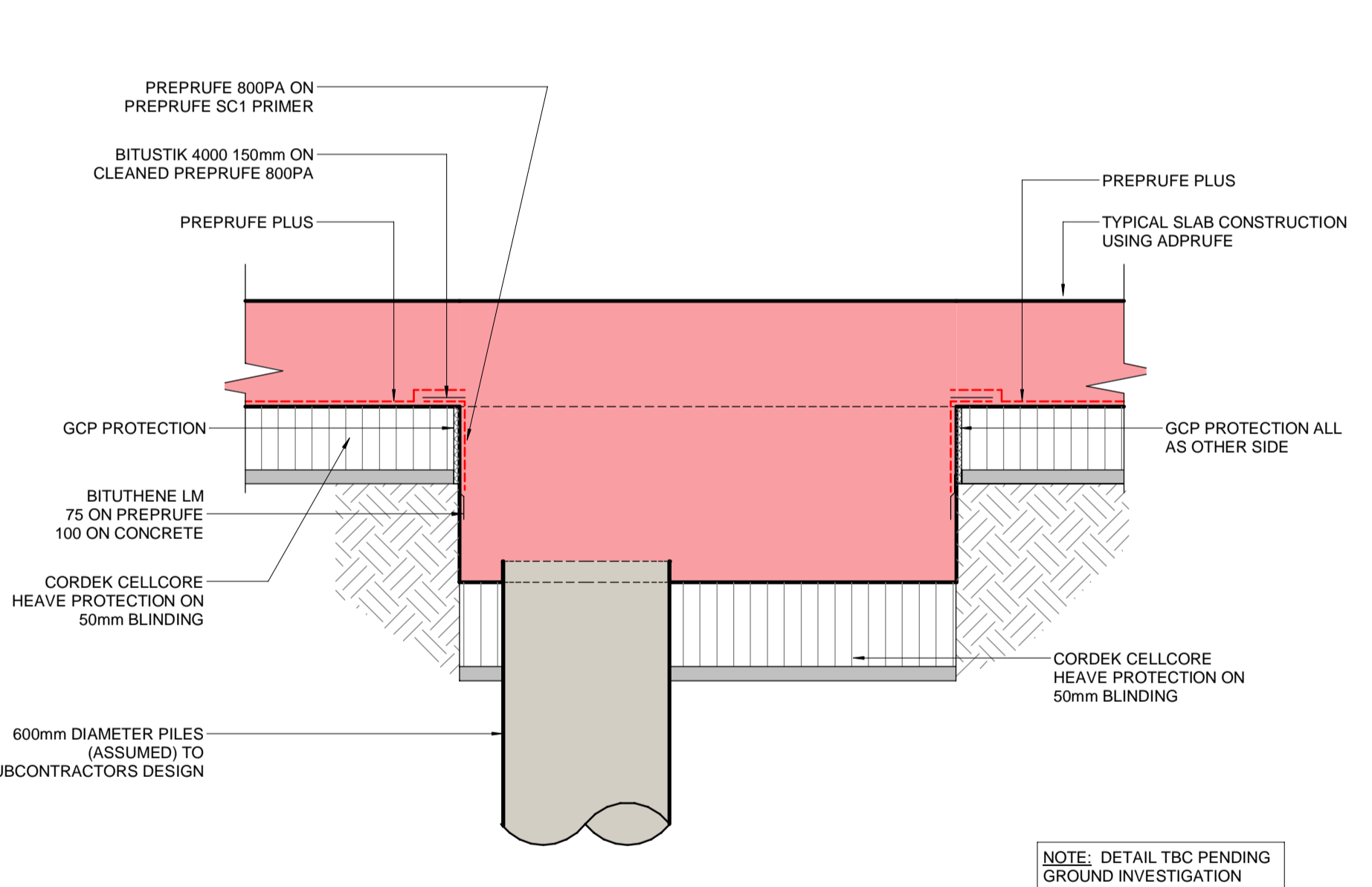

**DETAIL 5. TYPICAL PILE CAP DETAIL**  
1:20

WATERPROOFING RISK ASSESSMENT TO BE PROVIDED BY SPECIALIST. DETAILS ON THIS DRAWING ARE INDICATIVE AND ALL FINAL DETAILS ARE TO BE PROVIDED BY SPECIALIST.

REFER TO TYPICAL SLAB, PILE CAP AND GROUND BEAM DETAILS FOR HEAVE PROTECTION AS INDICATED ON DRAWING MHA-ACM-00-XX-DR-SE-05005

DRAWING TO BE READ WITH PROJECT SPECIFIC DRAWINGS BY PUDLO/DB GROUP: SERIES AEC-BP-002, 008, 009, 010, 014 & PUDLO-TJD-BW-SS-001b - CAPPING BEAM KWIKASTRIP DETAIL AND PUDLO NBS SPECIFICATIONS.

FOR TYPICAL NOTES, PLEASE REFER TO DRAWING 01001

- Notes**
- Do not scale from this drawing. Work to figured dimensions only.
  - This drawing is to be read in conjunction with:
    - AECOM Structural Specifications
    - Design reports
    - Survey and Interpretative Reports
    - Project Specifications and Performance Specifications
    - Health and Safety Hazard Register
    - Relevant drawings and documentation issued by the architect, engineers and specialists.
    - Building Information Model (BIM)
    - Movements and Tolerances Report
  - All dimensions are in mm except levels which are in metres and relate to [ordance datum].
  - Any discrepancies shall be referred to the Designer before work commences.

**Issue/Revision**

Rev.	Date	Description	Drawn/Checked/Approved
T5	23.10.20	ISSUED FOR TENDER	RHKSF/DW
C2	20.08.20	STAGE 4 REDESIGN	RHKSF/DW
C1	27.07.20	REVISED AS CLOUDED	RHKSF/DW
T4	27.07.20	CONSTRUCTION STATUS (SCOPE IS LIMITED TO THE SECANT PILED WALL ON SOUTH AND EAST BOUNDARIES ONLY)	RHDW/DW
T4	28.10.18	TENDER - STAGE 1	MNDW/DW
T3	19.06.18	STAGE 4 TENDER (2)	MNDW/DW
T2	01.05.18	STAGE 4 TENDER	MNDW/DW
T1	29.03.18	STAGE 4 TENDER (DRAFT)	MNDW/DW
A	21.12.17	STAGE 3 ISSUE_WIP	MNDW/DW
Rev.	Date	Description	Dm/Chk/Apr

**Purpose Of Issue**  
STAGE 4 TENDER

**Project Number**  
60516144

**Sheet Title**  
New Build  
Substructure Details  
Sheet 1

**Sheet Number**  
MHA-ACM-00-XX-DR-SE-05001

**Scale:** As indicated@A1 **Rev:** T5

This drawing has been prepared for the use of AECOM's client. It may not be used, modified, reproduced or relied upon by third parties, except as agreed by AECOM or as required by law. AECOM accepts no responsibility, and denies any liability whatsoever, to any party that uses or relies on this drawing without AECOM's express written consent. Do not scale this document. All measurements must be obtained from the stated dimensions.